



ADDING CLEARIP CAMERA TO UNIVIEW NVR

Adding a CLEAR Camera

UNV NVR with Built-in PoE setup

1. Connect directly to your CLEAR camera via Internet Explorer and set the camera to a static IP matching the same scheme as the internal PoE of the NVR.
 - a. Log directly into the camera's web interface using Internet Explorer. (Note: default username: admin password: 123456)
 - b. Go to "Config", then select "TCP/IP" under "Network".

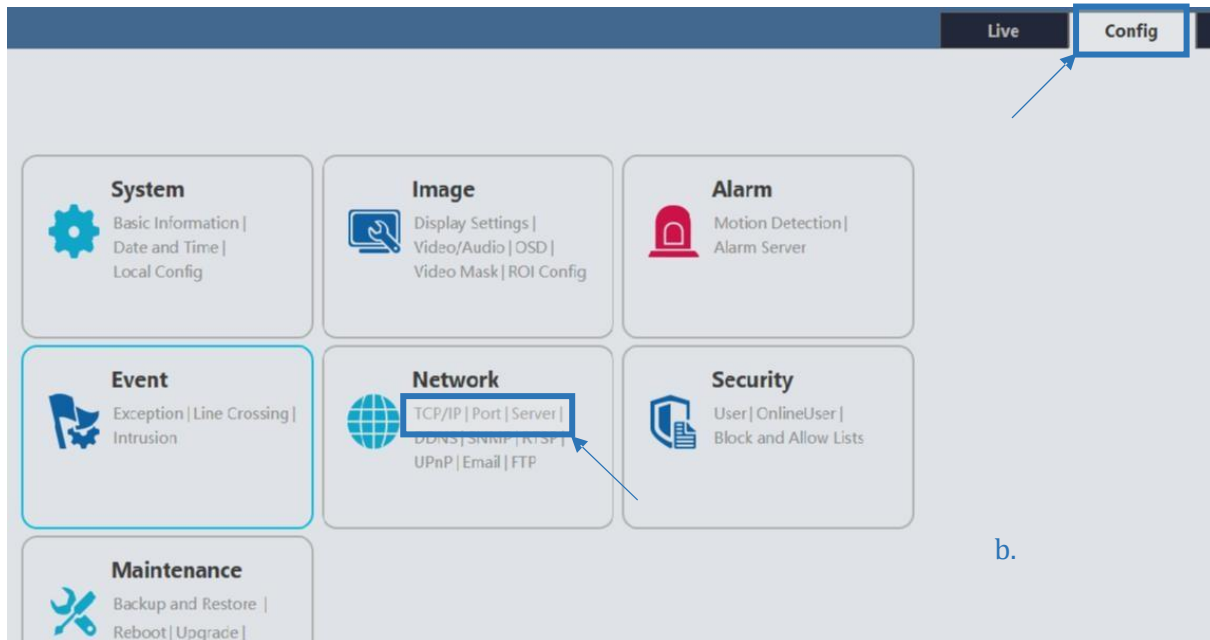

- c. Select "Use the following IP address", then set the IP to match the NVR's PoE scheme and "Save".

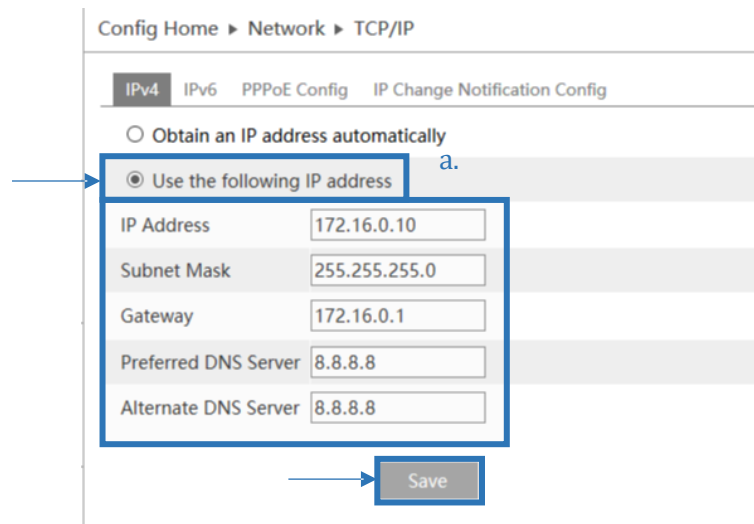

2. administrator account.
Connect your Uniview NVR with built in PoE to your display monitor and login to your
3. Connect your CLEAR IP camera to the PoE port of your choosing. (**Note: The port selected will correspond with the channel the camera will be added to on the NVR.**)
4. Go to the "Main Menu", Select "Camera" then Select "Camera" again.
5. Double click on the channel your camera is connected into and change the add mode from Plug-and-Play to "Manual".
(**Reminder: The channel selected corresponds with the PoE**

port you connected the CLEAR camera to.)

Add/Modify

| No. | IP Addr. | Status | Qty | Model |
|-----|----------|--------|-----|-------|
| | | | | |

| | |
|-----------------------|--------------------------|
| Add Mode | Plug-and-Play |
| Protocol | Manual |
| Camera IP | Plug-and-Play |
| Port | 80 |
| Username | admin |
| Password | ***** |
| Number of Camera | 1 |
| Extended Transmission | <input type="checkbox"/> |

Search
Modify
Back

settings. By default CLEAR cams have the following default information :

| | |
|-----------------|--------------|
| Protocol | ONVIF |
| Port | 80 |

6. Input the cameras IP that you set earlier and update the information to match the cameras

| | |
|-----------------|---------------|
| Username | admin |
| Password | 123456 |

7. Select "**Modify**" to save.

Add/Modify

| No. | IP Addr. | Status | Qty | Model |
|-----|----------|--------|-----|-------|
|-----|----------|--------|-----|-------|

◀ ▶

| | | |
|-----------------------|--------------------------|---|
| Add Mode | Manual | ▼ |
| Protocol | ONVIF | ▼ |
| Camera IP | 193 . 168 . 0 . 2 | |
| Port | 80 | |
| Username | admin | |
| Password | ***** | |
| Number of Camera | 1 | |
| Extended Transmission | <input type="checkbox"/> | |

Protocol Search **Modify** Back

UNV NVR without PoE setup

Connect your 64-CLEAR IP camera(s). (Note: This may require configuring each camera's

1. Connect your Uniview NVR without built in PoE to your display monitor and login to your administrator account.
2. assigned IP address individually if needed)
3. Go to the "**Main Menu**" on the NVR, Select "**Camera**" then Select "**Camera**" again.
4. Select Custom Add. 
5. Select "**Search**" and review the list of a vailable IP cams shown within the list above.

6. Select your CLEAR cameras from the list and update the information to match the cameras above list. You may also manually add the information if the camera(s) settings. By default CLEAR cams have the following default information: are not found in the

| Protocol | ONVIF |
|-----------|--|
| Camera IP | Whatever is DHCP'd or assigned to the camera |
| Port | 80 |
| Username | admin |
| Password | 123456 |

cameras be sure to update accordingly.]

7. Select "Modify" to save.

Add/Modify

| No. | IP Addr. | Status | Qty | Model |
|-----|----------|--------|-----|-------|
| | | | | |

◀
▶

| | | |
|-----------------------|--------------------------|---|
| Add Mode | Manual | ▼ |
| Protocol | ONVIF | ▼ |
| Camera IP | 193 . 168 . 0 . 2 | |
| Port | 80 | |
| Username | admin | |
| Password | ***** | |
| Number of Camera | 1 | |
| Extended Transmission | <input type="checkbox"/> | |

Protocol
Search
Modify
Back

Motion Recording Setup

When working with IP cameras the motion detection is triggered by the camera which then sends the signal to the NVR.

you will first need to enable and configure motion detection within the camera itself.

camera. **Once complete please review our ["Uniview Motion Recording Guide"](#) for scheduling the recording on the NVR.**

1. Login to your CLEAR IP camera. (Note: All Motion configuration settings are done within the CLEAR camera. Once all below steps are completed please review our Uniview Recording on Motion guide for scheduling and setting up the NVR to record on motion.)
2. Select “Config” and then select “Motion Detection” under the alarm section.

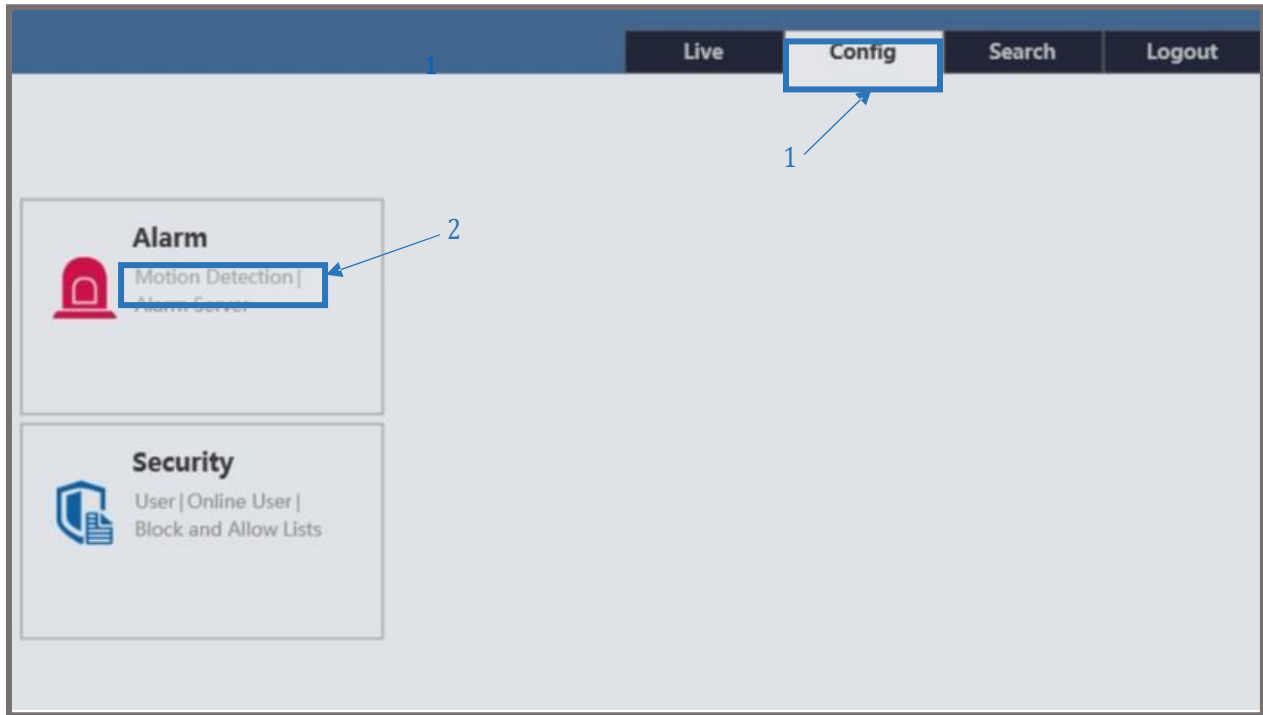

3. Select the box next to “Enable Alarm” to enable motion detection and then set the alarm holding time of your choosing. Once complete select “Save”.

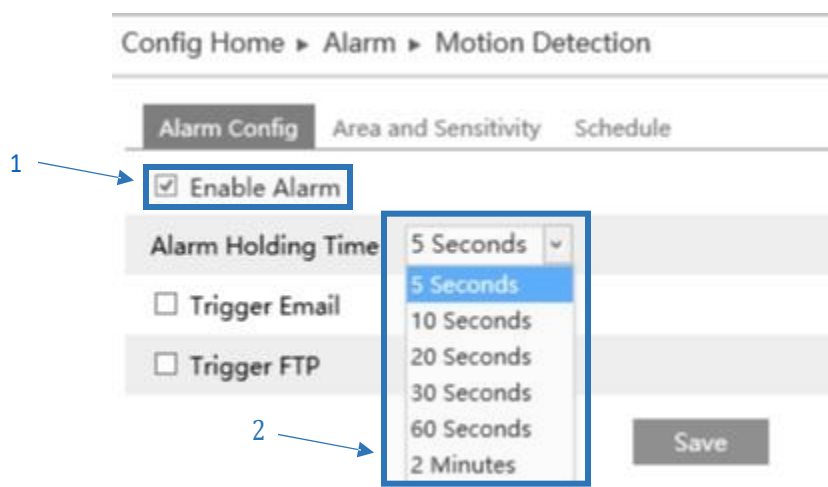

Note: Alarm Holding Time represents the duration of time the camera will delay between each motion triggered event.

- Select the **"Area and Sensitivity"** tab. Here you can adjust how sensitive you would like the camera to be in detecting motion as well as adding or removing grid boxes to depict where in the cameras Field of View (FoV) you would like motion to be detected. Once complete select **"Save"**

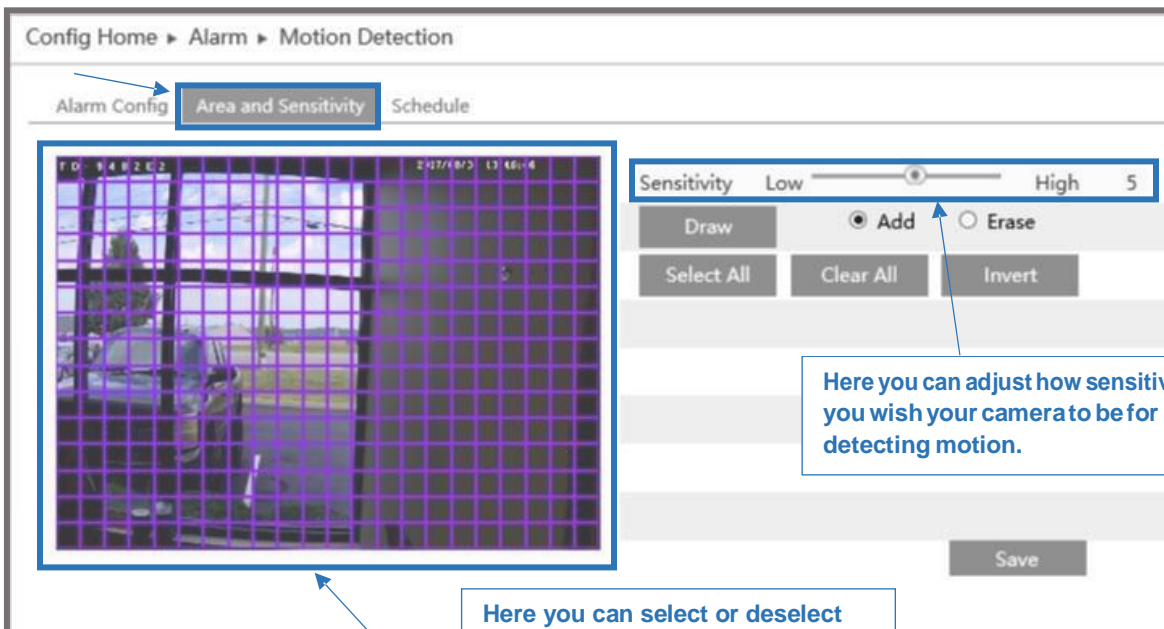

- Select the **"Schedule"** tab to setup a motion schedule. By default the camera is set for a 24 hour period for each day. You can adjust the schedule by selecting **"Manual Input"** on the day(s) you require changes. Once complete select **"Save"**.

