

# DF5 Series DomePak®

## COMPLETE, FIXED MOUNT DOME, CAMERA AND LENS PACKAGE

### Product Features

- Pre-Packaged Dome, Camera, and Lens
- Easy to Order
- Cosmetically Matches Spectra® Dome
- Indoor and Environmental Models Available
- Hard Ceiling, Suspended Ceiling, and Pendant Applications
- Versatile and Adjustable Fixed Mount Camera Bracket
- High Resolution Color
- Varifocal and Fixed Lens Options
- Pendant Models Meet NEMA Type 4X and IP66 Standards
- Heavy-Duty Models
  - Tough, Reinforced Construction
  - 0.090-inch Injection-Molded Polycarbonate Bubble
  - Barrel-Type Key Locks

**DF5 DomePaks®** combine a fixed-mount dome enclosure, compact high-resolution camera, and fixed or varifocal lens in an easy-to-order, easy-to-install package.

**DF5 DomePaks** are packaged under a single part number to make ordering easier; and, because they are pre-configured, they are guaranteed to be compatible.

**DF5 DomePaks** are available in a variety of styles for different applications. Select from in-ceiling, pendant (indoor or outdoor), or heavy-duty models. And, because they are designed to look like Spectra® integrated dome systems, they are the perfect complement to new or existing installations.



DomePak allows choices between color (NTSC or PAL), high resolution compact cameras and a variety of lenses ranging from 2.3 mm to 5-50 mm fixed focal length or varifocal length, and 2.8-11, 3-8.5 and 7.5-50 varifocal day/night lenses. Choose between auto or manual iris.

**DF5 DomePaks** are fashioned after Spectra integrated dome systems, and have a variety of mounting options available, from wall, corner, pole, or parapet mount.

For fixed dome applications requiring specialty enclosures such as stainless steel or pressurized, see Spectra with DD5-FM fixed mount camera adapter.



C1452 / REVISED 6-19-08

IP66



U.S. Patents 340,940 and 5,224,675

International Standards  
Organization Registered Firm,  
ISO 9001 Quality System



# TECHNICAL SPECIFICATIONS

## DOME

### MECHANICAL

Cable Entry	
In-ceiling	0.75-inch conduit fitting
Pendant	Through 1.5-inch NPT pendant mount

### ELECTRICAL

Input Voltage	24 VAC (environmental models only)
Input Power	58 VA (for heater)

### GENERAL

Construction	
Back Box	Aluminum
Mounting Bracket	Steel
Bubble	
DF5, DF5S,	
DF5-PG Series	Acrylic; smoked, clear, chrome* or gold*
DF5-HD Series	Polycarbonate; clear, 0.090-inch thick
DF5-OF	Acrylic (flat window); smoked, 0.06-inch thick

### ENVIRONMENTAL

Environment	
Outdoor†	(DF5-PG-E0, DF5-PG-E1, or DF5HD-PG-E1)
Maximum	140°F (60°C) absolute maximum; 122°F (50°C) sustained maximum
Minimum	-60°F (-51°C) absolute minimum; prevents icing at sustained minimum of -50°F (-45°C); de-ices 0.1 inch (2.5 mm) within 3 hours after power-up
Indoor	(All other models) 32° to 122°F (0° to 50°C)

\*Available only with standard in-ceiling models.

†Assumes no wind chill factor.

## CERTIFICATIONS/PATENTS

- UL/cUL Listed
- Meets NEMA Type 1, IP20 standards (indoor models)
- Meets NEMA Type 4, IP66 standards (outdoor models)
- U.S. Patents 340,940 and 5,224,675

## RECOMMENDED MOUNTS

### In-Ceiling Domes

DF5S-SMKIT	Surface mount adapter for DF5S Series with short back box. Includes bezel and hardware.
SCA1	Support rails; use in suspended ceiling applications where additional support is needed.
SD5-P	2' x 2' drop ceiling panel, aluminum construction. Replaces 2' x 2' ceiling tile.

### Pendant Domes

BB5-PCA-BK	Conduit adapter, black
BB5-PCA-GY	Conduit adapter, gray
IWM Series	Wall mount with cable feedthrough. Can be adapted for corner (CM400), pole (PA402) or parapet (PP300L/PP301L, PP400, PP4348) applications.
PP350, PP351	Parapet mount; mounts to inside of parapet
SWM Series	Compact wall mount. Can be adapted for corner (SWM-CA) or pole (SWM-PA) applications.

## RECOMMENDED POWER SUPPLIES

MCS Series	Multiple 24 VAC camera power supply, indoor
WCS Series	Single/multiple 24 VAC camera power supply, outdoor

# TECHNICAL SPECIFICATIONS

LETTER	MODEL	DIMENSION
A	DF5S SERIES	2.75 (6.99)
B	DF5 SERIES	5.25 (13.34)
C	DF5-0F/DF5-1F	5.60 (14.22)

STANDARD,  
IN-CEILING

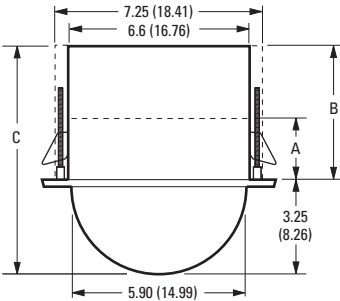

STANDARD,  
PENDANT

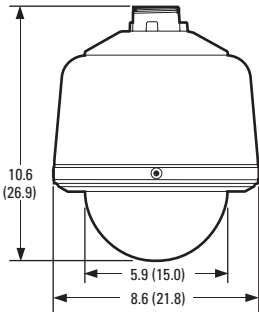

HEAVY-DUTY,  
IN-CEILING

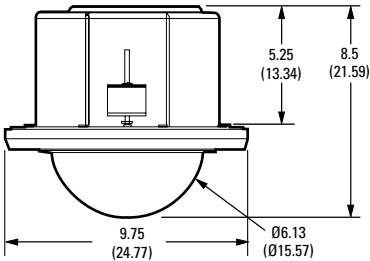

HEAVY-DUTY,  
PENDANT

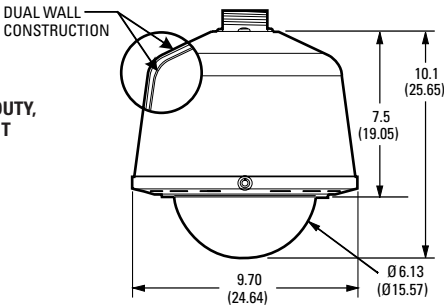

NOTE: VALUES IN PARENTHESES ARE CENTIMETERS; ALL OTHERS ARE INCHES.

# TECHNICAL SPECIFICATIONS

## CAMERA SPECIFICATIONS

	<b>High Resolution, Day/Night, WDR (NTSC) CCC1390H-6 (KW)</b>	<b>High Resolution, Day/Night, WDR (PAL) CCC1390H-6X (KX)</b>
Image Device Synchronization System Horizontal Resolution Electronic Shutter Range Minimum Illumination B-W (SENS 40x) Color (SENS 40x) B-W Color Signal-to-Noise Ratio Automatic Gain Control Backlight Compensation Scanning System Signal Processing Auto Iris Lens Type Video Output Input Voltage Power Consumption	1/3-inch image format Sony SS-2WD CCD AC line lock/internal 530 TVL (B-W); 480 TVL (color) 1/60-1/50,000 second  0.002 lux, f1.2, 40 IRE, AGC on, 75% scene reflectance 0.02 lux, f1.2, 40 IRE, AGC on, 75% scene reflectance 0.08 lux, f1.2, 40 IRE, AGC on, 75% scene reflectance 0.8 lux, f1.2, 40 IRE, AGC on, 75% scene reflectance >50 dB Selectable Selectable 525 lines, 2:1 interlace Digital signal processing (DSP) DC-drive (autosensing) 1 Vp-p, 75 ohms 24 VDC $\pm$ 15%/12 VDC $\pm$ 15%, 60 Hz 3.5 watt	1/3-inch image format Sony SS-2WD CCD AC line lock/internal 530 TVL (B-W); 480 TVL (color) 1/50-1/50,000 second  0.002 lux, f1.2, 40 IRE, AGC on, 75% scene reflectance 0.02 lux, f1.2, 40 IRE, AGC on, 75% scene reflectance 0.08 lux, f1.2, 40 IRE, AGC on, 75% scene reflectance 0.8 lux, f1.2, 40 IRE, AGC on, 75% scene reflectance >50 dB Selectable Selectable 625 lines, 2:1 interlace Digital signal processing (DSP) DC-drive (autosensing) 1 Vp-p, 75 ohms 24 VDC $\pm$ 15%/12 VDC $\pm$ 15%, 50 Hz 3.5 watt
	<b>Ultra High Resolution, Day/Night (NTSC) C10DN-6 (AM)</b>	<b>Ultra High Resolution, Day/Night (PAL) C10DN-6X (AN)</b>
Image Device Synchronization System Horizontal Resolution Electronic Shutter Range Minimum Illumination B-W (SENS 40x) Color (SENS 40x) B-W Color Signal-to-Noise Ratio Automatic Gain Control Backlight Compensation Scanning System Signal Processing Auto Iris Lens Type Video Output Input Voltage Power Consumption	1/3-inch image format interline transfer CCD AC line lock/internal 540 TVL 1/60-1/100,000 second  0.08 lux, f1.2, 50 IRE, AGC on, 89% scene reflectance 0.4 lux, f1.2, 50 IRE, AGC on, 89% scene reflectance 0.07 lux, f1.2, 40 IRE, AGC on, 75% scene reflectance 0.3 lux, f1.2, 40 IRE, AGC on, 75% scene reflectance >48 dB Selectable Selectable 525 lines, 2:1 interlace Digital signal processing (DSP) DC-drive (autosensing) 1 Vp-p, 75 ohms 24 VAC $\pm$ 15%/12 VDC $\pm$ 15%, 60 Hz 3 watts	1/3-inch image format interline transfer CCD AC line lock/internal 540 TVL 1/50-1/100,000 second  0.08 lux, f1.2, 50 IRE, AGC on, 89% scene reflectance 0.4 lux, f1.2, 50 IRE, AGC on, 89% scene reflectance 0.07 lux, f1.2, 40 IRE, AGC on, 75% scene reflectance 0.3 lux, f1.2, 40 IRE, AGC on, 75% scene reflectance >48 dB Selectable Selectable 625 lines, 2:1 interlace Digital signal processing (DSP) DC-drive (autosensing) 1 Vp-p, 75 ohms 24 VAC $\pm$ 15%/12 VDC $\pm$ 15%, 50 Hz 3 watts
	<b>Ultra High Resolution, Color, NTSC C10CH-6 (AJ)</b>	<b>Ultra High Resolution, Color, PAL C10CH-6X (AK)</b>
Image Device Synchronization System Horizontal Resolution Electronic Shutter Control Minimum Illumination Signal-to-Noise Ratio Automatic Gain Control Backlight Compensation Scanning System Signal Processing Auto Iris Lens Type Video Output Input Voltage Power Consumption	1/3-inch image format interline transfer CCD AC line lock/internal 540 TVL Selectable 0.3 lux, f1.2, 40 IRE, AGC on, 75% reflectance >48 dB Selectable Selectable 525 lines, 2:1 interlace Digital signal processing (DSP) DC-drive (autosensing) 1 Vp-p, 75 ohms 24 VAC $\pm$ 15%/12 VDC $\pm$ 15%, 60 Hz 3 watts	1/3-inch image format interline transfer CCD AC line lock/internal 540 TVL Selectable 0.3 lux, f1.2, 40 IRE, AGC on, 75% reflectance >48 dB Selectable Selectable 625 lines, 2:1 interlace Digital signal processing (DSP) DC-drive (autosensing) 1 Vp-p, 75 ohms 24 VAC $\pm$ 15%/12 VDC $\pm$ 15%, 50 Hz 3 watts

# TECHNICAL SPECIFICATIONS

## LENS SPECIFICATIONS

Varifocal Day/Night Lenses	R2.8	R3	R75
Focal Length	2.8-11 mm	3-8.5 mm	7.5-50 mm
Zoom Ratio	3.9X	2.8X	6.7X
Format Size	1/3-inch	1/3-inch	1/3-inch
Mount Type	CS	CS	CS
Relative Aperture (F)	1.4-2.6	1.0-360	1.3-360
Operation			
Iris	Auto (Direct Drive)	Auto (Direct Drive)	Auto (Direct Drive)
Focus and Zoom	Manual	Manual	Manual
Angle of View			
Diagonal	32.7°~123.2°	41.9 °~114.1°	7.00°~46.2°
Horizontal	26.2°~97.4°	33.6°~90.5°	5.64°~36.6°
Vertical	19.7°~72.4°	25.2°~67.2°	4.26°~27.4°
Min. Object Distance	0.3 m	0.2 m	0.4 m

Varifocal Lenses	V2	V21	V3	V5	V50
Focal Length	2.5-6 mm	2.8-12 mm	3-8 mm	5-40 mm	5-50 mm
Zoom Ratio	2.4X	4.3X	2.7X	8X	10X
Format Size	1/3-inch	1/3-inch	1/3-inch	1/3-inch	1/3-inch
Mount Type	CS	CS	CS	CS	CS
Relative Aperture (F)	1.4~Close/1.4~125	1.4~Close/1.4~360	1.0~Close/1.0~360	1.6~Close/1.6~360	1.4~Close/1.4~185
Operation					
Iris	Manual/Auto (Direct Drive)	Manual/Auto (Direct Drive)	Manual/Auto (Direct Drive)	Manual/Auto (Direct Drive)	Manual/Auto (Direct Drive)
Focus and Zoom	Manual	Manual	Manual	Manual	Manual
Angle of View					
Diagonal	56.8 °~133.3°	—	44.9°~117.9°	8.8 °~66.9°	—
Horizontal	45.6°~107.6°	24.1°~97.4°	35.9°~91.0°	6.5°~53.6°	5.3°~53.4°
Vertical	34.2°~80.9°	18.1°~72.5°	26.9°~66.6°	4.8°~40.2°	4.1°~40.1°
Min. Object Distance	0.2m	0.3m	0.2m	0.5m	0.5m

Fixed Focal Lenses	F2.3	F2.8	F4	F8
Focal Length	2.3 mm	2.8 mm	4 mm	8 mm
Format Size	1/3-inch	1/3-inch	1/3-inch	1/3-inch
Mount Type	CS	CS	CS	CS
Relative Aperture (F)	1.4~Close/1.4~360	1.4~Close/1.4~360	1.2~Close/1.2~360	1.2~Close/1.2~360
Operation				
Iris	Manual/Auto (Direct Drive)	Manual/Auto (Direct Drive)	Manual/Auto (Direct Drive)	Manual/Auto (Direct Drive)
Focus	Manual	Manual	Manual	Manual
Angle of View				
Diagonal	143.2°	121.8°	92.3°	43.8°
Horizontal	116.1°	97.4°	71.6°	34.5°
Vertical	87.4°	72.8°	52.7°	25.6°
Min. Object Distance	0.2m	0.2m	0.2m	0.2m

# MODEL NUMBERS

To configure a DF5 DomePak, refer to the selection guides below to compile the appropriate model number. Selection guides are grouped according to dome type.



**DF5 SERIES  
IN-CEILING**



**DF5S SERIES  
SHORTENED BACK BOX**



**DF5 SERIES  
PENDANT**



**DH5 HEAVY DUTY**

## In-Ceiling and Pendant Models, Standard Bubble

**DF5KW-PB-0F2.3A**

- DF5** = Standard DF5
- DF5S** = Shortened DF5 (In-ceiling only)
- DH5** = Heavy duty DF5
- KW** = Day/night, NTSC, high resolution with WDR
- KX** = Day/night, PAL, high resolution with WDR
- AM** = Day/night, ultra high resolution (NTSC)
- AN** = Day/night, ultra high resolution (PAL)
- AJ** = Color, ultra high resolution (NTSC)
- AK** = Color, ultra high resolution (PAL)
- PB** = Pendant, black (indoor)\*
- PG** = Pendant, light gray (indoor/outdoor)
- Blank** = In-ceiling back box
- 0** = Smoked dome (f/0.5 light loss)\*
- 1** = Clear dome
- 2** = Chrome dome (f/2.0 light loss<sup>†</sup>)
- 3** = Gold dome (f/2.0 light loss<sup>†</sup>)
- E0** = Outdoor pendant (includes heater and sun shield), smoked dome (f/0.5 light loss)
- E1** = Outdoor pendant (includes heater and sun shield), clear dome
- R11** = 2.8-11 mm varifocal D/N lens<sup>‡</sup>
- R3** = 3-8.5 mm varifocal D/N lens<sup>‡</sup>
- R75** = 7.5-50 mm varifocal D/N lens<sup>‡</sup>
- V2** = 2.5-6 mm varifocal lens
- V21** = 2.8-12 mm varifocal lens
- V3** = 3-8 mm varifocal lens
- V5** = 5-40 mm varifocal lens
- V50** = 5-50 mm varifocal lens
- F2.3** = 2.3 mm fixed lens
- F2.8** = 2.8 mm fixed lens
- F4** = 4 mm fixed lens
- F8** = 8 mm fixed lens
- Blank** = No Lens
- A** = Auto iris
- Blank** = Manual iris

\*Not available in heavy duty models.

<sup>†</sup>Available only with standard in-ceiling models.

<sup>‡</sup>Available only as an auto iris lens.

## In-Ceiling Models with Flat Acrylic Plate

**DF5KW-0FF2.3A**



**DF5 WITH FLAT  
ACRYLIC PLATE**

- DF5** = Series dome
- KW** = Day/night, NTSC, high resolution with WDR
- KX** = Day/night, PAL, high resolution with WDR
- AM** = Day/night, ultra high resolution (NTSC)
- AN** = Day/night, ultra high resolution (PAL)
- AJ** = Color, ultra high resolution (NTSC)
- AK** = Color, ultra high resolution (PAL)
- 0F** = Smoked flat window (f/0.5 light loss)
- F2.3** = 2.3 mm fixed lens
- F2.8** = 2.8 mm fixed lens
- F4** = 4 mm fixed lens
- Blank** = No lens
- A** = Auto iris
- Blank** = Manual iris



**Pelco, Inc. Worldwide Headquarters:**

3500 Pelco Way, Clovis, California 93612-5699 USA

**USA & Canada** Tel: (800) 289-9100 • FAX: (800) 289-9150

**International** Tel: +1 (559) 292-1981 • FAX: +1 (559) 348-1120

[www.pelco.com](http://www.pelco.com)

Pelco, the Pelco logo, DomePak, and Spectra are registered trademarks of Pelco, Inc. Product specifications and availability subject to change without notice.

©Copyright 2008, Pelco, Inc. All rights reserved.