

AMX-4A3B2/28-PA

4MP AI Bullet Network Camera

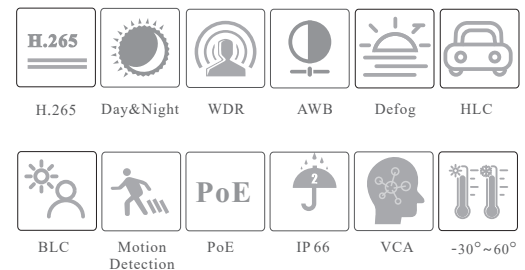

- H.265+/H265/H.264+/H264/ MJPEG coding
- Max. resolution: 2592 × 1520
- ICR auto switch, true day / night
- 30 ~ 50m IR night view distance
- 3D DNR, true WDR, HLC, BLC, Defog and ROI coding
- 1CH audio input; 1CH speaker
- Built-in micro SD card slot, up to 256GB
- DC12V/PoE power supply
- IP66 ingress protection
- Support three streams
- Intelligent analytics: abnormal video signal detection (scene change, video cast & video blur detection), line crossing detection (human/ vehicle classification), region intrusion/entrance/exiting detection (human/vehicle classification), sound and light warning



SPECIFICATIONS

Specifications	Model	IP-5IR4A3B2/28-PA
Camera		
Image Sensor	1 / 3" CMOS	
Image Size	2592 × 1520	
Electronic Shutter	1 s ~ 1 / 100000 s	
Iris Type	DC Iris	Fixed Iris
Min. Illumination	0.005lux@F1.6, AGC ON; 0 lux with IR	
Lens	2.8 mm@F1.6, H.FoV: 100.4°; V.FoV: 68°; D.FoV: 108°; 3.6 mm@F1.6, H.FoV: 80.6°; V.FoV: 50.6°; D.FoV: 88°	
Focus	Fixed	
Lens Mount	Φ14	M12
Wide Dynamic Range	120dB	
BLC	Yes	
HLC	Yes	
Defog	Yes	
Digital NR	3D DNR	
Angle Adjustment	Pan: 0°~360°; Tilt: 0°~90°; Rotation: 0°~360°	
Image		
Video Compression	H.265+ / H.265 / H.264+ / H.264 / MJPEG	
H.264 Compression Standard	Baseline Profile/Main Profile/High Profile	
Resolution	4MP (2592 × 1520), 2K (2560 × 1440), 3MP (2304 × 1296), 1080P (1920 × 1080), 720P (1280 × 720), D1, CIF, 480 × 240	
Main Stream	4MP/2K/3MP/1080P / 720P (60Hz: 1~30fps; 50Hz: 1~25fps) HFR mode: 1080P / 720P (60Hz: 1~60fps; 50Hz: 1~50fps)	
Sub Stream	720P/D1/CIF (60Hz: 1~30fps; 50Hz: 1~25fps)	
Third Stream	D1/CIF/480×240 (60Hz: 1~30fps; 50Hz: 1~25fps)	
Bit Rate	64 Kbps ~ 8 Mbps	
Bit Rate Type	VBR / CBR	
Audio Compression	G711A / U	
Image Settings	ROI, Saturation, Brightness, Hue, Contrast, Wide Dynamic, Sharpness, NR, etc. adjustable through client software or web browser	
ROI	Each ROI to be configured separately	
Interfaces		
Network	RJ 45	
Video Output	No	
Audio	1CH audio input; 1CH built-in speaker	
Alarm	1CH alarm input; 1CH alarm output	
Storage	Built-in micro SD card slot; up to 256GB	
Reset	Yes	
Functions		
Remote Monitoring	Web Client/NVR/NVMS2.0/Mobile APP	
Online Connection	Support simultaneous monitoring for up to 10 users; Support multi-stream real time transmission	
Network Protocol	UDP, IPv4, IPv6, DHCP, NTP, RTSP, RTP, RTCP, PPPoE, DDNS, SMTP, FTP, SNMP, HTTP, 802.1x, UPnP, HTTPs, QoS	
Interface Protocol	ONVIF	
Storage	Network remote storage; micro SD card storage	
Smart Alarm	Motion detection, sensor alarm, SD card error, SD card full, IP address conflict, Cable connection	
General function	Watermark, IP address filtering, video mask, heartbeat, password protection, image distortion correction	
PoE	Yes, IEEE802.3af	
IR Distance	30 ~ 50 m	
Protection Grade	IP66	
Intelligent Analytics		
Video Abnormality	Scene change detection, video blur detection, video cast detection	

Perimeter Detection	Line crossing detection (human/vehicle classification); Region intrusion/entrance/exiting detection (human/vehicle classification)
Sound&Light Warning	Yes
Others	
Power Supply	DC12V/PoE
Power Consumption	< 12.5W
Operating Environment	- 30 °C ~ 60 °C (-22°F~140°F) Humidity: less than 95 % (non-condensing)
Dimensions (mm)	217.8 × 80.5 × 80.3
Weight (net)	Approx. 0.694KG
Installation	Ceiling mounting; Wall mounting
Certificate	CE, FCC
Environmental Protection	Complies with Directive EU RoHS, WEEE(2012/19/EU), directive 94/62/EC and REACH(EC1907/2006)

DIMENSIONS

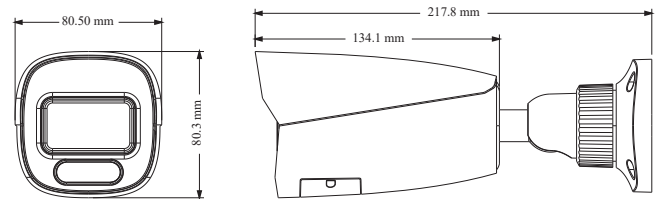

AVAILABLE ACCESSORIES



AVAILABLE MODEL

Available Model	IP-5IR4A3B2/28-PA	Fixed lens
-----------------	-------------------	------------