

FlexiDome^{XT}

LTC 1361, 146x Series Vandal Resistant Cameras - 540 TVL



Security Systems



- Vandal resistant camera in weatherproof housing
- Endures the equivalent of 120lbs of force
- High resolution monochrome and 540 TVL color models
- Extended sensitivity with NightSense
- Auto-iris varifocal lenses
- Line-Lock with phase adjustment
- Flush mount appearance
- Conduit compatible hard surface mount option

The FlexiDome^{XT} line of vandal resistant, fixed Dome cameras with varifocal lens options provide the ultimate solution for virtually any indoor and outdoor security application. Providing a full-featured integrated camera in a cast aluminum housing, polycarbonate dome, and hardened inner liner these units can withstand the equivalent of 120lbs of force. FlexiDome^{XT} cameras are also sealed for outdoor use with protection against water and dust to IP66, (NEMA-4) standards.

Functions

The FlexiDome^{XT} Series incorporates the latest technology found in an integrated camera with the option of 540 TVL resolution color and monochrome cameras that feature an integrated varifocal DC iris lens. The choice of varifocal lenses makes the application of these cameras extremely versatile, covering standard and telephoto as well as low light applications. AC and DC compatible, users get an added benefit of Line-Locking and phase adjustment capabilities when AC voltage is employed. Backlight compensation can also be selected on all models. NightSense is used to further extend the excellent sensitivity by a factor of 3 in monochrome operation. This mode is automatically activated in color cameras under low light conditions.

For quick and easy installation, the FlexiDome^{XT} Series cameras come completely assembled, and ready to use. Using the proprietary pan/tilt/rotation mechanism, camera adjustments are simple. Cameras can be rotated 360° and tilted more than 90° to choose precisely the camera angle you need for installation.

Each unit is supplied with an adaptor plate compatible with single, double, or 4S electrical box installations. For solid wall or ceiling mounting, the optional LTC 1347 Hard Surface Mount Adaptor box is offered. This adaptor can be wired through the side of the housing via a standard 3/4in. conduit opening, or wired through the back of the unit. For hassle-free on-site setup and adjustments, an optional Video Service cable (S1460) is available.

FlexiDome^{XT} is an ideal, no compromise solution for numerous surveillance applications, especially over conventional camera limitations. The small, sleek design and virtually flush mount appearance allow for an attractive look that compliments various decors, and at the same time providing the extra protection necessary for applications such as schools, banks, hotels, prisons, parking garages, retail, and commercial installations.

Installation/Configuration Notes

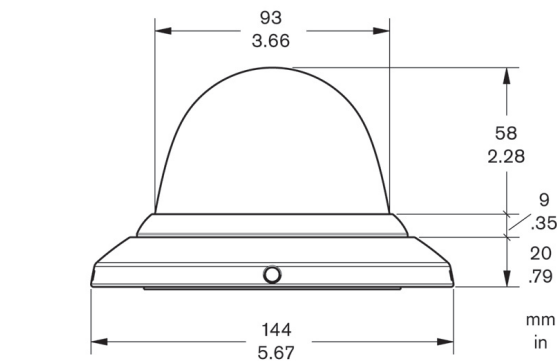

Dimensions

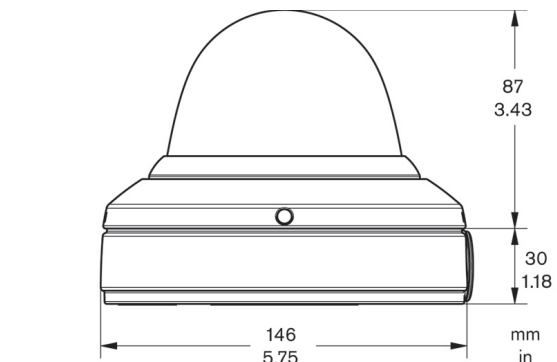

with LTC 1347 connection box

Pendant Mount

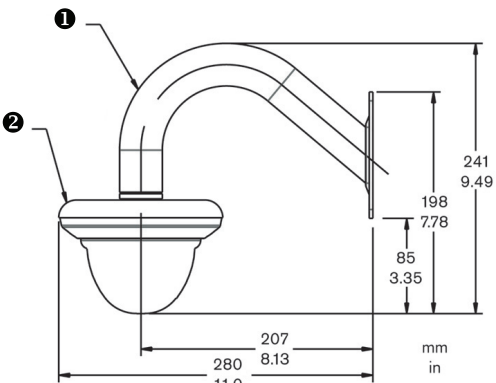
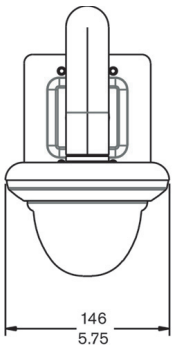

Dimensions LTC 1348/00

- 1 Wall Mount Assembly
- 2 Pendant Cap

Pipe Mount

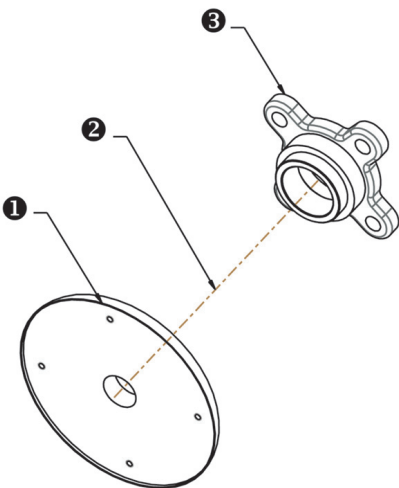

Dimensions LTC 1349/00

- 1 Pendant Cap
- 2 3/4-inch pipe with 3/4-inch -14 NPSM threads or EMT conduits both ends (not included)
- 3 Flange Assembly

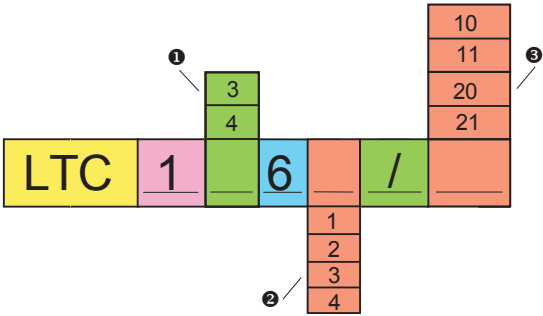

- 1 3 - B/W
4 - Color
- 2 1 - 2.8-6 mm F1.4 Varifocal
2 - 2-4 mm F1.4 Varifocal
3 - 3-6 mm F 1.2 Varifocal
4 - 4-9 mm F1.4 Varifocal
- 3 10 - CCIR
20 - EIA
11 - PAL
21 - NTSC

Technical Specifications				
Electrical				
Model No.	Lens		System	
LTC 1361/10	2.8 – 6mm, F1.4		B&W, CCIR, 50Hz	
LTC 1361/20	2.8 – 6mm, F1.4		B&W, EIA, 60Hz	
LTC 1461/11	2.8 – 6mm, F1.4		Color, PAL, 50Hz	
LTC 1461/21	2.8 – 6mm, F1.4		Color, NTSC, 60Hz	
LTC 1462/11	2 – 4mm, F1.4		Color, PAL, 50 Hz	
LTC 1462/21	2 – 4mm, F1.4		Color NTSC, 60 Hz	
LTC 1463/11	3 – 6mm, F1.2		Color, PAL, 50Hz	
LTC 1463/21	3 – 6mm, F1.2		Color, NTSC, 60Hz	
LTC 1464/11	4 – 9mm, F1.4		Color, PAL, 50Hz	
LTC 1464/21	4 – 9mm, F1.4		Color, NTSC, 60Hz	
Voltage Range				
/11 & /10 versions	12 to 24VAC, 50Hz or 12 to 33VDC, 2 W			
/21 & /20 versions	12 to 24VAC, 60Hz or 12 to 33VDC, 2 W			
Lens	Auto Iris Integrated Varifocal			
2 - 4mm	Viewing angle	105° - 53°		
2.8 – 6mm	Viewing angle	66° - 35°		
3 – 6mm	Viewing angle	72° - 35°		
4 – 9mm	Viewing angle	52° - 24°		
Imager	Interline transfer CCD, 1/4-inch. image format			
Horizontal Resolution				
LTC 136x B&W Series	570 TVL			
LTC 146x Color Series	540 TVL			
Electronic Shutter	1/50 (1/60) to 1/100,000 sec			
Sensitivity	Usable picture		Full Video	
	30 IRE	50 IRE		
LTC 1361	fc	0.01	0.02	0.08
	lx	0.1	0.2	0.8
LTC 1461, 1462 & 1464				
Color	fc	0.1	0.2	0.8
	lx	1	2	8
NightSense	fc	0.03	0.07	0.27
	lx	0.3	0.7	2.7
LTC 1463				
Color	fc	0.07	0.15	0.6
	lx	0.7	1.5	6
NightSense	fc	0.02	0.05	0.2
	lx	0.2	0.5	2
At 89% scene reflection and 3200K illumination				
Signal-to-Noise Ratio	48dB			
Automatic Gain Control	18dB			
White Balance	(Color Models Only)			
Automatic Sensing through the Lens: 2500K to 9000K				
Continuous (ATW) or Hold (AWB)				
Aperture Correction	Horizontal and vertical			
Synchronization				
Line-Lock (When powered by AC)	Synchronizes camera to power line zero crossings for roll-free interval switching. Vertical phase delay can be continuously adjusted to allow vertical synchronization in multiphase power installations			
Crystal-Lock	selected when DC supplied or Line-Lock OFF			

Electrical	
Controls	
Automatic White Balance	On (ATW) / Off(AWB)
Backlight Compensation	On / Off
NightSense	On / Off
Line-Lock	On / Off, with phase adjustment of
Connectors	
Video Out	BNC on coax cable
Power	Stripped leads
Internal Video Monitor Connector	2.5 mm mono jack
Mechanical	
Cable Entry	Through back, optional connection box available for side entry (1/2 - inch conduit or 22 mm gland, PG16)
Mounting	On wall or ceiling using up to 4 screws
Construction	Polycarbonate clear dome on aluminum housing
Color	White trim ring with black inner liner, /10 includes gray trim ring
Dimensions	See drawing
Weight	500g (1.1lb)
Environmental	
Operating Temp.	-30°C to +50°C (-22°F to +122°F)
Storage Temp.	-40°C to +70°C (-40°F to +158°F)
Humidity	0% to 90% relative humidity, non condensing
Water & Dust Protection	IP66 (NEMA 4), when mounted on a flat surface
Impact Protection	IEC 60068-2-75 test Eh ≥50 Joules EN 50102, exceeding IK10
Product Regulatory Compliance	
Electromagnetic Compatibility (EMC)	CE Immunity, FCC Class B
Safety	UL, cUL, CE

Ordering Information

Model & Description

LTC 1361/10 FlexiDome XT

1/4-inch B/W, vandal resistant, 570 TVL, 12 VDC/24 VAC, 50 Hz,
w/2.8-6 mm F1.4 varifocal lens, white/grey

LTC 1361/20 FlexiDome XT

1/4-inch B/W, vandal resistant, 570 TVL, 12 VDC / 24 VAC, 60 Hz,
w/2.8 – 6 mm F1.4 varifocal lens, white

LTC 1461/11 FlexiDome XT

1/4-inch color, vandal resistant, 540 TVL, 12 VDC/24 VAC, 50 Hz,
w/2.8 – 6 mm F1.4 varifocal lens, white/grey

LTC 1461/21 FlexiDome XT

1/4-inch color, vandal resistant, 540 TVL, 12 VDC/24 VAC,
60 Hz, w/2.8 – 6 mm F1.4 varifocal lens, white

LTC 1462/11 FlexiDome XT

1/4-inch color, vandal resistant, 540 TVL, 12 VDC/24 VAC, 50 Hz,
w/2 – 4 mm F1.4 varifocal lens, white/grey

LTC 1462/21 FlexiDome XT

1/4-inch color, vandal resistant, 540 TVL, 12 VDC/24 VAC, 60 Hz,
w/2 – 4 mm F1.4 varifocal lens, white

LTC 1463/11 FlexiDome XT

1/4-inch color, vandal resistant, 540 TVL, 12 VDC/24 VAC, 50 Hz,
w/3 – 6 mm F1.2 varifocal lens, white/grey

LTC 1463/21 FlexiDome XT

1/4-inch color, vandal resistant, 540 TV, 12 VDC/24 VAC, 60 Hz,
w/3 – 6 mm F1.2 varifocal lens, white

LTC 1464/11 FlexiDome XT

1/4-inch color, vandal resistant, 540 TVL, 12 VDC/24 VAC, 50 Hz,
w/4 – 9 mm F1.4 varifocal lens, white/grey

LTC 1464/21 FlexiDome XT

1/4-inch color, vandal resistant, 540 TVL, 12 VDC/24 VAC, 60 Hz,
w/4 – 9 mm F1.4 varifocal lens, white

Ordering Information

Model & Description

Hardware Accessories

TC 1323 Power Supply Unit

120 VAC, 60 Hz, 24 VAC, 60 Hz, 10 VA

TC 220PSX-24 Power Supply Unit

230 VAC/20 VAC, 50 Hz, 20 VA

LTC 1347/00 Surface Mount Box

for FlexiDome XT, side entry conduit, white

LTC 1347/01 Surface Mount Box

for FlexiDome XT, side entry conduit, gray

LTC 1348/00 Pendant Wall Mount Kit

for FlexiDome XT, white

LTC 1349/00 Pendant Pipe Mount Kit

for FlexiDome XT, white

S1460 Service/Monitor Cable

for FlexiDome XT (2.5 mm connector to BNC), 1 m

LTC 1340/00 Wall Arm/Adapter Plate

for vari/phortress dome

LTC 1343/00 Pipie Mount /Adapter Plate

for vari/phortress dome

Americas:

Bosch Security Systems
130 Perinton Parkway
Fairport, New York, 14450, USA
Phone:+1 585 223 4060
+1 800 289 0096
security.sales@us.bosch.com
http://www.boschsecurity.us

Europe, Middle East, Africa:

Bosch Security Systems B.V.
P.O. Box 80002
5600 JB Eindhoven, The Netherlands
Phone:+31 (0) 40 27 83955
Fax:+31 (0) 40 27 86668
emea.securitysystems@bosch.com
http://www.boschsecurity.com

Asia-Pacific:

Bosch Security Systems Pte Ltd
38C Jalan Pemimpin
Singapore 577180
Phone:+65 6319 3450
Fax:+65 6319 3499
apr.securitysystems@bosch.com
http://www.boschsecurity.com

BOSCH