

COMPOSITION:

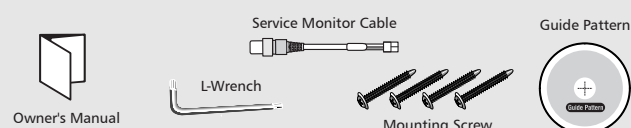

INSTALLATION:

- 1 Stick the guide pattern on the wall or ceiling.
- 2 Drill four holes according to the guide pattern then insert anchors into the drilled holes.
- 3 Draw out power / video wires to the connecting places.
- 4 Fixed the camera to a ceiling using four screws.
- 5 Adjust desired focus and scene by turning and moving the 3-axis camera bracket by hand.
- 6 Put the dome cover over the base.
- 7 Fix the dome cover on the base by L-Wrench.

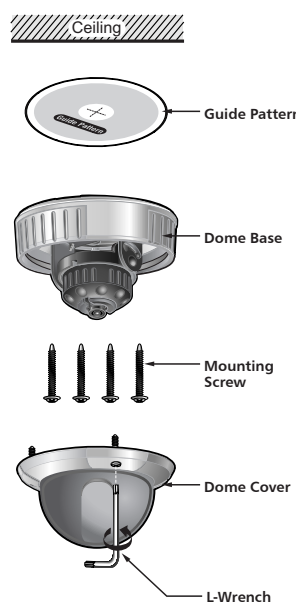

DIMENSIONS(mm):

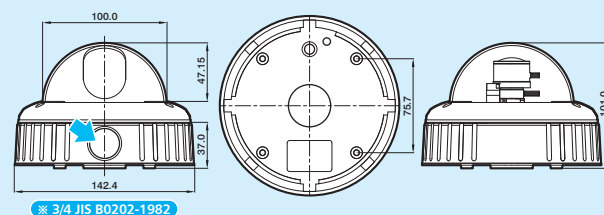

SPECIFICATIONS:

Model	NTSC	PAL
Signal System	NTSC : 525 Lines	PAL : 625 Lines
Scanning System	2 : 1 Interlace	
Scanning Frequency (H)	15.734kHz	15.625kHz
Scanning Frequency (V)	59.94Hz	50Hz
Image Sensor	1/3 inch SONY IT CCD	
Total / Effective Pixels No.	410K/380K [Normal:270K/250K]	470K/440K [Normal:320K/290K]
S/N Ratio	More than 48dB (AGC Off)	
Resolution	550 TV Lines [High: 480 TV Lines / Normal: 380 TV Lines]	
Video Output Level	1.0 Vp-p (75 Ohms, composite)	
Lens	Fixed Lens (f=2.45mm, 3.8mm, 6mm Selectable) / Vari-focal Lens	
Focus	Manual	
Sync. System	Internal	
Sensitivity	0.3 Lux(High/Normal) / 0.1 Lux(Day&Night) / 0 Lux(IR LED)	
Electronic Shutter	1/60 ~ 100,000 Sec.	1/50 ~ 100,000 Sec.
White Balance	Auto	
AGC	Auto, On / Off (Option)	
BLC	On / Off (with Slide Switch)	
Flickerless	On / Off (with Slide Switch)	
Input / Output Connector	Power, Video, UTP (Option)	
Power Consumption	DC 12V (DC 9V~15V) / 3W (Max)	
(Option : AC 24V/DC 12V)	AC 24V (20V~28V) or DC 12V (10V~15V), 5W (Max)	
Dome Size (Ø)	100mm	
Weight	Approx. 844g	

3-Axis

OWNER'S MANUAL

VandalProofera Digital/DSPal Proof color camera

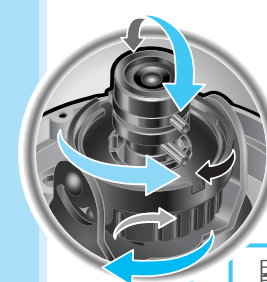

1/3" SONY CCD



LENS .Vari-focal
.Fixed Lens

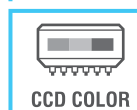

CCD COLOR



AWB Auto White
Balance



AGC Auto Gain
Control



DSP Digital Signal
Processor

Design and specifications are subject to change without notice.

PRECAUTIONS:

- Do not install the camera in extreme temperature conditions. Do use the camera under conditions where temperatures are within -10°C to 45°C. Be especially careful with ventilation under high temperatures.
- Do not install or use the camera in an environment where the humidity is high. It can cause the image quality to be poor.
- Do not disassemble the camera. There are no user-serviceable parts inside it.
- Do not drop the camera or subject them to physical shocks. It can cause malfunctions to occur.
- Note
When this camera is installed near wireless communication devices that emits strong electromagnetic field, irregularity such as noise on the monitor may appear.

NAME AND FUNCTION:

Fixed Lens Type

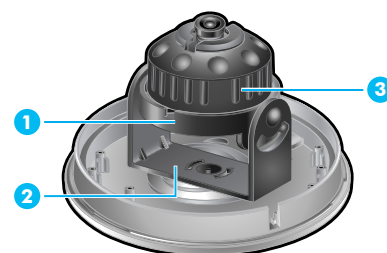

Vari-focal Lens Type

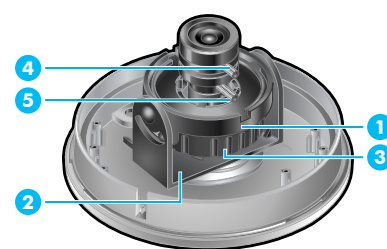

Camera Lay-out

- 1 Tilt rotation: Adjusting the vertical angle.
- 2 Pan rotation: Adjusting the horizontal angle.
- 3 Horizontal rotation: Adjusting the horizontal position of the screen.
- 4 Focus handle: Focus (Far or Near)
- 5 Zoom handle: Zoom (Tele or Wide)

CONNECTION:

Connecting to Monitor and Power

- DC 12V Power Type
- The wire is polarized.
- Use DC 12V power source.

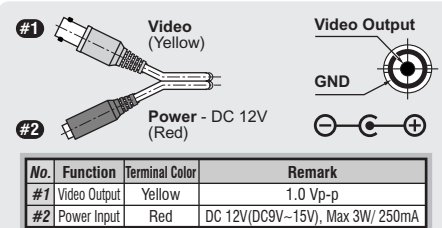

AC 24V/DC 12V Power Type

- The wire is non-polarized.
- Use AC 24V power source or DC 12V power source.

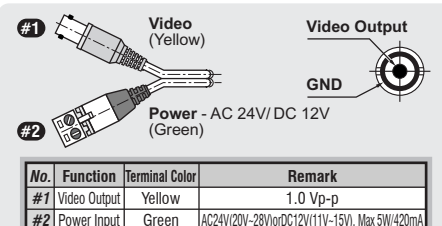

IR LED(3.8mm Fixed Lens Only): Option

- Power Consumption: 5W
- IR LED Specification: 850nm / 30° (24EA)

HEATER: Option

- Power Consumption: 10W
- Operating Temperature Range: -40°C ~ 50°C

CAMERA SET-UP:

Vari-focal Lens Type

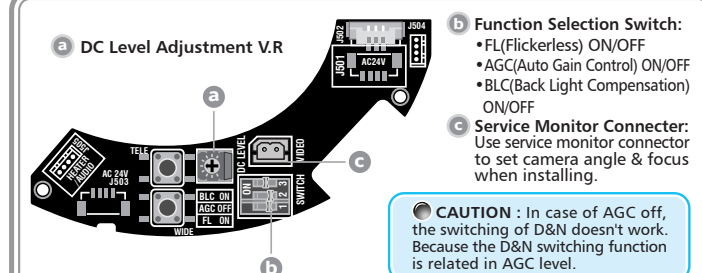

TROUBLESHOOTING:

If you have trouble operating your camera, refer to the following. If the guidelines do not enable you to solve the problem, contact an authorized technician.

- The image does not appear on the screen. Check the power source for the monitor and camera and assure that the voltage and polarity are properly connected and being supplied correctly.
- The image on the screen is dim. Check if the lens is stained. If dirty, clean the lens with a soft, clean cloth. Adjust the Back Focus of the lens again.
- The camera does not work properly, the surface of the camera case is hot, and a black line appears on the screen. Check if you have connected the camera to a proper power source and if there is no problem with the power, turn the unit off immediately and seek assistance from our After Service department.
- The screen blinks a lot. Check if the camera is pointed toward the sun or a fluorescent lamp. Adjust the angle or location of the camera if too much light is coming into the screen.