

Product Information Sheet

CORE
COLLECTION
by omnimount

Verona 37FP shown

Verona 47FP

The Core Collection is OmniMount's tried and true furniture collection made up of several different series of steel and glass A/V furniture. With clean lines, black glass and various high-gloss finishes, these pieces blend seamlessly into any environment. Semi-enclosed structure, curved edges and a streamlined design combine with all-in-one functionality to make the Verona Series the perfect functional and elegant addition to any environment. Engineered with extra height to provide comfortable viewing angles in any room, including bedrooms, the Verona 47FP's all-in-one design is ideal for medium flat panel TVs, offering you functionality while fitting in to any decor.

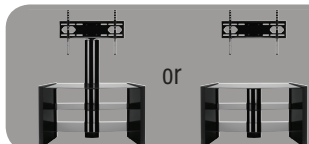

The Verona 47FP can be used as a flat panel floor stand, or the mount and table can be separated to use individually.

BENEFITS

- Uniquely designed to be used as a flat panel floor stand, or separate video table and mount
- Rails can attach in two places, giving you a choice in vertical positioning
- Ideal for corners or flat against a wall
- Extra height added to create comfortable viewing angles for bedrooms
- Semi-enclosed structure accommodates and helps conceal multiple components
- Pans 30° left and right to adjust viewing angle (when used as flat panel floor stand)
- Low 1.38" mounting profile (when used as separate wall mount)
- Includes universal adapter for greater panel compatibility
- Lift n Lock™ allows you to easily attach your flat panel to the mount
- Neatly route and organize wires through cable management post
- Includes anti-tip kit for tethering panel to wall (when used as a flat panel floor stand)
- Locking system secures panel to mount

- Adjustable plastic feet aid in leveling and protect floors
- Easy to assemble

SPECIFICATIONS

- Accommodates most 37" - 47" flat panels up to 80 lbs (36.3 kg)
- Tempered glass top shelf supports up to 80 lbs (36.3 kg)*
- Two tempered glass component shelves support up to 50 lbs (22.7 kg)*
- Universal and VESA compliant: 100x100 to 400x600
- Pan: 30° left and right (when used as flat panel floor stand)
- Mounting Profile: 1.38" (when used as a separate wall mount)
- Dimensions: 39.6"w x 47.3"h x 19.6"d (1006mm x 1200mm x 498mm)
- Warranty: 5 years
- Color: High gloss black with black glass

*180 lbs maximum for the unit

The Verona Series

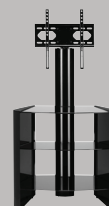

Verona 37FP

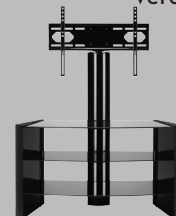

Verona 47FP

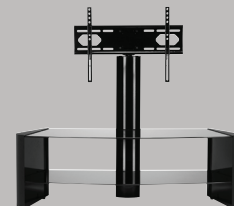

Verona 55FP

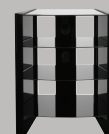

Verona AT

Verona 47FP

BENEFITS

- Uniquely designed to be used as a flat panel floor stand, or separate video table and mount
- Rails can attach in two places, giving you a choice in vertical positioning
- Ideal for corners or flat against a wall
- Extra height added to create comfortable viewing angles for bedrooms
- Semi-enclosed structure accommodates and helps conceal multiple components
- Pans 30° left and right to adjust viewing angle (when used as flat panel floor stand)
- Low 1.38" mounting profile (when used as separate wall mount)
- Includes universal adapter for greater panel compatibility
- Lift n Lock™ allows you to easily attach your flat panel to the mount
- Neatly route and organize wires through cable management post
- Includes anti-tip kit for tethering panel to wall (when used as a flat panel floor stand)
- Locking system secures panel to mount
- Adjustable plastic feet aid in leveling and protect floors
- Easy to assemble

SPECIFICATIONS

- Accommodates most 37" - 47" flat panels up to 80 lbs (36.3 kg)
- Tempered glass top shelf supports up to 80 lbs (36.3 kg)*
- Two tempered glass component shelves support up to 50 lbs (22.7 kg)*
- Universal and VESA compliant: 100x100 to 400x600
- Pan: 30° left and right (when used as flat panel floor stand)
- Mounting Profile: 1.38" (when used as a separate wall mount)
- Dimensions: 39.6" w x 47.3" h x 19.6" d (1006mm x 1200mm x 498mm)
- Warranty: 5 years
- Color: High gloss black with black glass

*180 lbs maximum for the unit

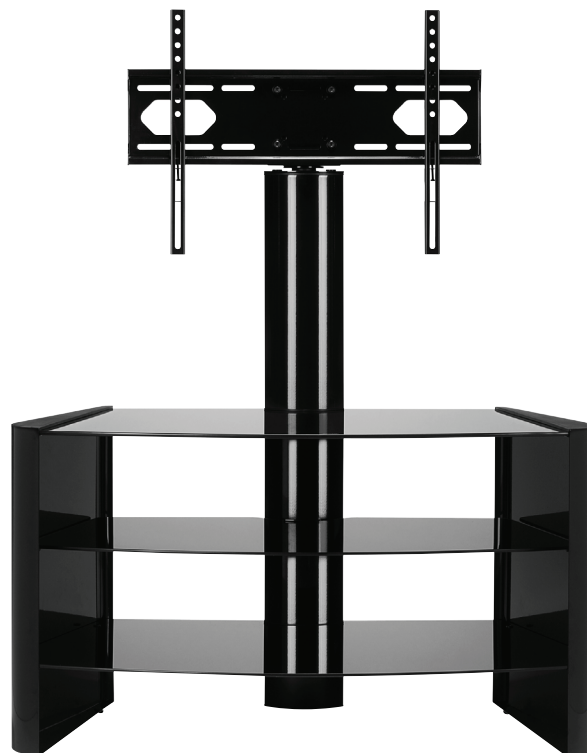

| | Color | Stock Code | Packaging UPC |
|---------------|-------|--------------|---------------|
| Americas | BLK | 1004807-1 | 728901026171 |
| International | BLK | 1004807INT-1 | 728901026171 |

| Box Contents | Qty |
|---------------|-----|
| Vertical rail | 2 |
| Wall plate | 1 |
| Post section | 3 |
| Side panel | 2 |
| Top glass | 1 |

| | Dimensions WxDxH inches (mm) | Wt lbs (kg) | Qty |
|-----|----------------------------------|-------------|-----|
| Box | 43.2 x 22.6 x 8.3 (1097x575x210) | 82.7 (37.5) | NA |
| MC | NA | NA | NA |

| Box Contents | Qty |
|--|-----|
| Glass shelves | 2 |
| Complete furniture assembly hardware kit | 1 |
| Complete panel mounting hardware kit | 1 |
| Complete panel attachment hardware kit | 1 |
| Instruction manual | 1 |

The Core Collection is OmniMount's tried and true furniture collection made up of several different series of steel and glass A/V furniture. With clean lines, black glass and various high-gloss finishes, these pieces blend seamlessly into any environment. Semi-enclosed structure, curved edges and a streamlined design combine with all-in-one functionality to make the Verona Series the perfect functional and elegant addition to any environment. Engineered with extra height to provide comfortable viewing angles in any room, including bedrooms, the Verona 47FP's all-in-one design is ideal for medium flat panel TVs, offering you functionality while fitting in to any decor.

Verona 47FP

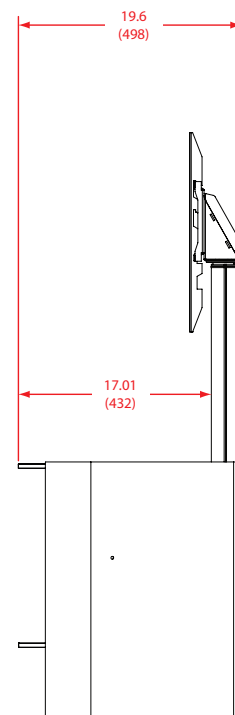
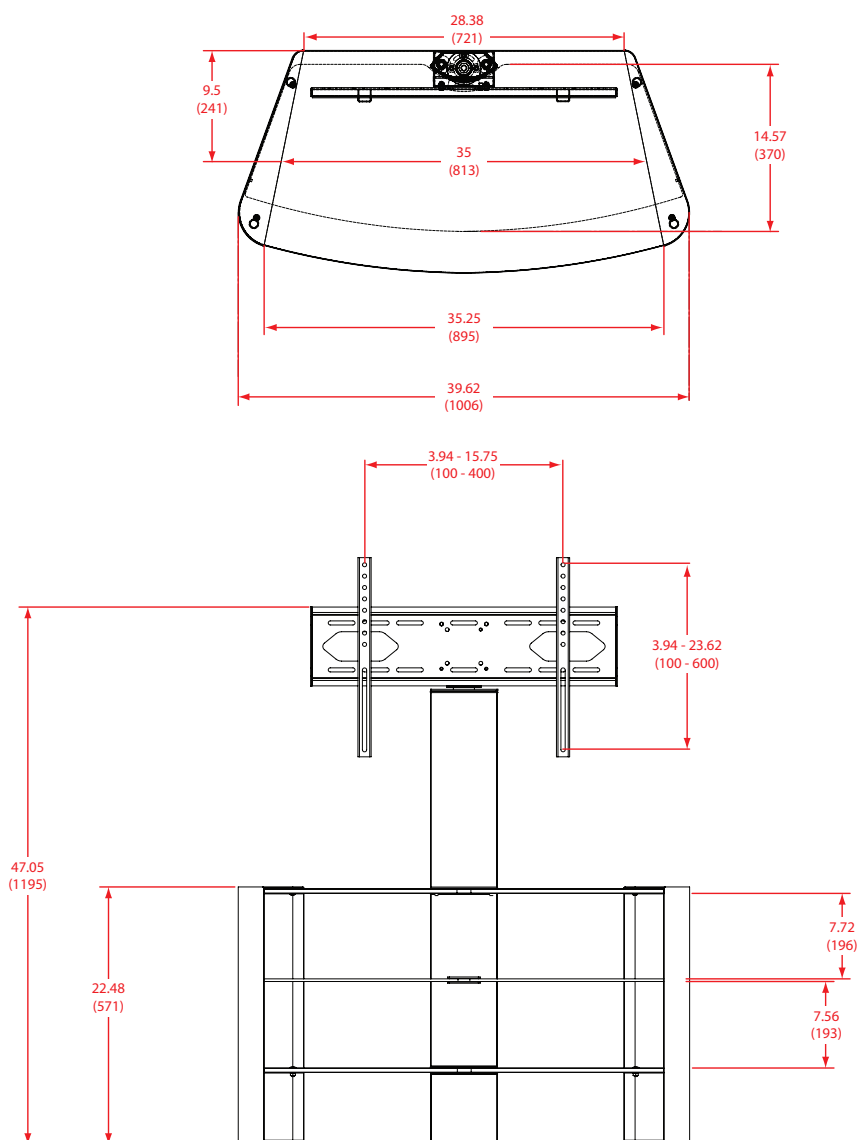

inches (mm)