

## PAN-FOCUS MINI DOME CAMERA

- No Focus Adjustments Required
- Built-in X2.6 motorized zoom pan-focus lens, f=2.8-7.3mm (F=1.9-3.0)
- 1/4" CCD type high resolution color camera
- Super-high horizontal resolution of 520 TV lines
- Minimum illumination: 1.9 lx (F1.9)
- Easy installation, easy adjustment and easy set-up
- Indoor mini dome type
- Built-in Motion Detection and Privacy Masking Functions
- Preconfigured versions for SSP or Network Control
- Accessories Include:
  - » VA-50ST (RS-485/UTP, Coaxial Control Board)  
[Protocols Supported: SANYO SSP, SANYO H.SSP, SANYO Coax, Pelco-C, Pelco-D]
  - » VA-50LAN (JPEG, POE Network Board + Audio)
- 24V AC / 12V to 15V DC Dual Power Supply

VCC-P7574  
VCC-P7574S  
VCC-P7574N



Note: VCC-P7574N Network version available August, 2006

**PAN-FOCUS**  
Technology in Perspective



# PAN-FOCUS MINI DOME CAMERA

## Specifications

Model		VCC-P7574/ VCC-P7574S/ VCC-P7574N
Scanning system		NTSC standard 525 lines, 30 frames/sec
Image sensor		1/4" Interline transfer method CCD (3.6 mm x 2.7 mm), 2.1 interlace
Picture elements		Total: 811(H) x 508(V), Effective: 768(H) x 494(V)
Horizontal resolution		More than 520 TV lines
Video output level		1.0 V (p-p) (75Ω, composite)
Video S/N Ratio		More than 50dB (AGC off)
Synchronizing system		Internal sync. / Line lock
Minimum	50 IRE	1.9lx (F1.9, GAIN: High)
Illumination	20 IRE	0.76 lx (F1.9, GAIN: High)
Backlight compensation		ON (CENTER/MULTI-SPOT) / OFF
White balance		ATW/AWC/Manual/Outdoor/Indoor/Fluorescent
Gain control		HIGH/NORMAL/OFF
Lens		Built-in X2.6 motorized zoom pan-focus lens, f=2.8 - 7.3mm, F1.9 - 3.0
Electronic shutter		1/60, 1/100, 1/250, 1/500, 1/1000, 1/2000, 1/4000, 1/10000
Motion detector		ON/OFF: Motion zoom function
Privacy masking		ON/OFF: Max 4 locations
Aperture		HIGH (2 step) / NORMAL / OFF
Environmental conditions		Temperature: -10 to +50 degrees C, Humidity: Less than 90% RH
Power requirement		12-15V DC / 24V AC± 10%, 50Hz
Power consumption		3.5W, with VA-50ST or VA-S0LAN = 9.5W
Dimension		Ø150.6 x 115.5mm [Ø5.9 x 4.5 in.]
Weight		600g (1.3 lbs) w/o options

## Dimensions

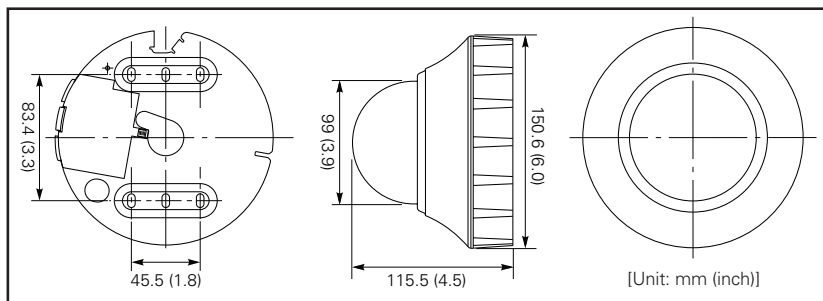

## Available Models

	RS-485/Coax (SSP)	Network
VCC-P7574		
VCC-P7574S	X	
VCC-P7574N		X

Specifications and product design are subject to change without notice.  
©2006 SANYO Security Products

# SANYO

SANYO Security Products  
21605 Plummer Street  
Chatsworth, CA 91311  
Phone: (888) 893-7403  
Fax: (888) 818-2597  
Technical Support: (888) 66-SANYO  
www.sanyocctv.com