

COMPOSITION:

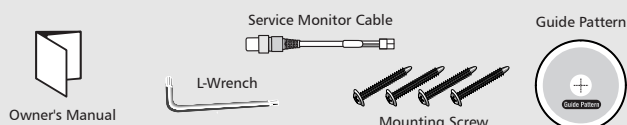

You must be fully aware of all the distinctive features and precautions related to this camera before installing it.

INSTALLATION:

- 1 Stick the guide pattern on the wall or ceiling.
- 2 Drill four holes according to the guide pattern then insert anchors into the drilled holes.
- 3 Draw out power / video wires to the connecting places.
- 4 Fixed the camera to a ceiling using four screws.
- 5 Adjust desired focus and scene by turning and moving the 3-axis camera bracket by hand.
- 6 Put the dome cover over the base.
- 7 Fix the dome cover on the base by L-Wrench.

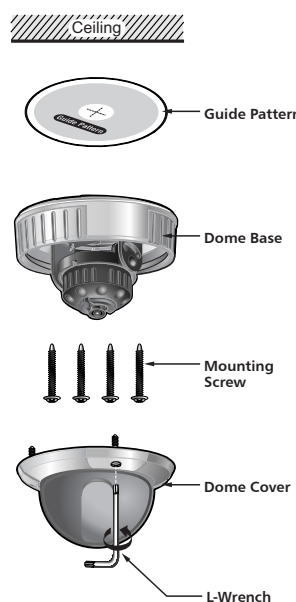

DIMENSIONS(mm):

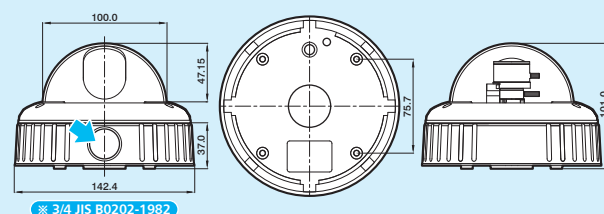

SPECIFICATIONS:

| Model | NTSC | PAL |
|------------------------------|--|---------------------|
| Signal System | NTSC : 525 Lines | PAL : 625 Lines |
| Scanning System | 2 : 1 Interlace | |
| Scanning Frequency (H) | 15.734kHz | 15.625kHz |
| Scanning Frequency (V) | 59.94Hz | 50Hz |
| Image Sensor | 1/3 inch SONY IT CCD | |
| Total / Effective Pixels No. | 410K | 470K |
| S/N Ratio | 50dB Min. (AGC Off) | |
| Resolution | 550 TV Lines | |
| Video Output Level | 1.0 Vp-p (75 Ohms, composite) | |
| Lens | Fixed Lens (f=2.45mm, 3.8mm, 6mm Selectable) Vari-focal Lens | |
| Focus | Manual | |
| Sync. System | Internal | |
| Sensitivity (F1.2) | 0.3 Lux (color) / 0.1 Lux (B/W) / 0.008 Lux (DSS On, x32) | |
| Electronic Shutter | 1/60 ~ 120,000 Sec. | 1/50 ~ 120,000 Sec. |
| White Balance | Auto | |
| AGC/ BLC/ D&N/ FL | On / Off Selectable | |
| DSS | Max 32 times | |
| D-ZOOM | 2 x | |
| DNR | AUTO | |
| Input / Output Connector | Power, Video, UTP (Option) | |
| Operating Temperature | -10°C ~ 45°C | |
| Storage Temperature | -20°C ~ 65°C | |
| Power Consumption | DC 12V (DC 9.6V~13.2V) / 150mA (Max) | |
| (Option : AC 24V/DC 12V) | AC 24V (20V~28V) or DC 12V (10V~15V), 3W (Max) | |
| Dome Size (Ø) | 100mm | |
| Weight | Approx. 844g | |

SDNR Super Digital Noise Reduction

OWNER'S MANUAL

VandalProofera Digital/DSPal Proof

Digital Slow Shutter DSS

3-Axis

1/3" SONY CCD

LENS Vari-focal / Fixed Lens

CCD COLOR

AWB Auto White Balance

AGC Auto Gain Control

DSP Digital Signal Processor

Design and specifications are subject to change without notice.

PRECAUTIONS:

- Do not install the camera in extreme temperature conditions. Do use the camera under conditions where temperatures are within -10°C to 45°C. Be especially careful with ventilation under high temperatures.
- Do not install or use the camera in an environment where the humidity is high. It can cause the image quality to be poor.
- Do not disassemble the camera. There are no user-serviceable parts inside it.
- Do not drop the camera or subject them to physical shocks. It can cause malfunctions to occur.
- Note When this camera is installed near wireless communication devices that emits strong electromagnetic field, irregularity such as noise on the monitor may appear.

NAME AND FUNCTION:

Fixed Lens Type

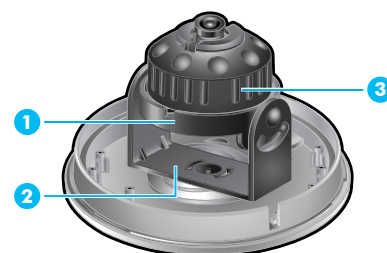

Vari-focal Lens Type

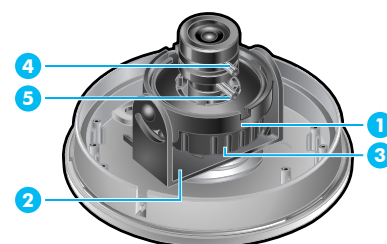

Camera Lay-out

- 1 Tilt rotation: Adjusting the vertical angle.
- 2 Pan rotation: Adjusting the horizontal angle.
- 3 Horizontal rotation: Adjusting the horizontal position of the screen.
- 4 Focus handle: Focus (Far or Near)
- 5 Zoom handle: Zoom (Tele or Wide)

CONNECTION:

Connecting to Monitor and Power

- DC 12V Power Type
- The wire is polarized.
- Use DC 12V power source.

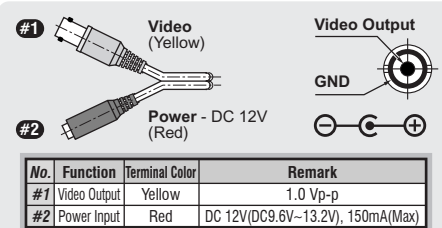

AC 24V/DC 12V Power Type

- The wire is non-polarized.
- Use AC 24V power source or DC 12V power source.

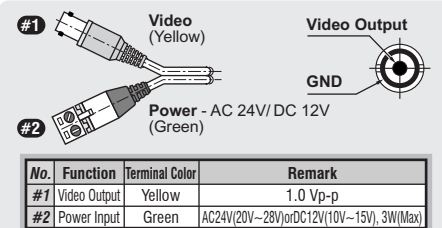

IR LED(3.8mm Fixed Lens Only): Option

- Power Consumption: 5W
- IR LED Specification: 850nm / 30° (24EA)

HEATER: Option

- Power Consumption: 10W
- Operating Temperature Range: -40°C ~ 50°C

CAMERA SET-UP:

Vari-focal Lens Type

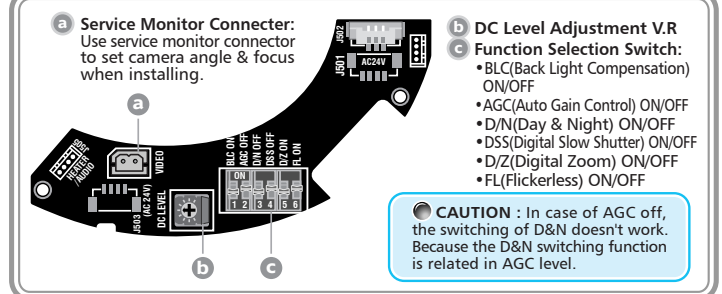

TROUBLESHOOTING:

If you have trouble operating your camera, refer to the following. If the guidelines do not enable you to solve the problem, contact an authorized technician.

- The image does not appear on the screen. Check the power source for the monitor and camera and assure that the voltage and polarity are properly connected and being supplied correctly.
- The image on the screen is dim. Check if the lens is stained. If dirty, clean the lens with a soft, clean cloth. Adjust the Back Focus of the lens again.
- The camera does not work properly, the surface of the camera case is hot, and a black line appears on the screen. Check if you have connected the camera to a proper power source and if there is no problem with the power, turn the unit off immediately and seek assistance from our After Service department.
- The screen blinks a lot. Check if the camera is pointed toward the sun or a fluorescent lamp. Adjust the angle or location of the camera if too much light is coming into the screen.