

V1570 Series Housing Mounts



V1571-W



V1572-W



V1573



V1574A



V1574

Features

- For indoor/outdoor installations
- Die-cast aluminum
- Easy installation and maintenance

Description

V1571-W is specially designed for use with Infinova's V1405 housing. It features manual adjustments, 360° in horizontal direction and adjustments in vertical direction.

V1572-W is designed for V1405, V1406 and V1407 indoor/outdoor housings.

V1573 is specially designed for use with the V1572-W mounts to provide 360° horizontal adjustment and 180° vertical adjustment.

North America
World Headquarters, USA
Infinova
51 Stouts Lane
Monmouth Junction, NJ 08852
United States

Phone:
+1 732-355-9100
+1 888-685-2002 (toll-free)
Fax: +1 732-355-9101
E-mail: Sales@infinova.com

Latin America & Caribbean
Miami: +1-954-990-0787
Mexico: +52-55-5543-5563
Venezuela: +58-414 205-0106
E-mail: Sales-LAR@infinova.com

Brazil: +55-41-3016-5503
E-mail: vendas-brasil@infinova.com

Argentina: +54-116-009-6009
E-mail: ventas@infinova.com.ar

Europe
Phone: +40 723 536600
E-mail: Sales-EUR@infinova.com

Asia Hong Kong
Phone: +852 2795 6540
E-mail: Sales-HK@infinova.com

Middle East & Africa
Phone: +965 2247 5678
E-mail: Sales-ME@infinova.com

India
+91 20 2669 8599
E-mail: Sales-IND@infinova.com

Ordering Information

V1571-W	Wall Mount, H/V adjustable for housing (V1405), 33.07 lbs. (15 kg) load
V1572-W	Wall Mount, Non-Adjustable for housing (V1405, V1406, V1407), 121.25 lbs. (55 kg) load
V1573	Mount Adapter, Adds H/V adjustability to V1572-W Wall , Mount for housing (V1405, V1406, V1407), 44.09 lbs (20 kg) load
V1574A	Pole Mount adapter for V1571-W
V1574B	Pole Mount adapter for V1572-W

Specifications

Housing Installation	V1571-W: Mounted with two M6x16 hexagon bolts; V1573: Mounted with two M6x16 hexagon bolts
Pan/Tilt Installation	V1572-W: Mount the pan/tilt with four M6x16 hexagon bolts, washer and spring washer
Weight	V1571-W: 1.43 lbs. (0.65 kg); V1572-W: 5.51 lbs. (2.5 kg); V1573: 2.43 lbs. (1.1 kg)
Loading	V1571-W: 33.07 lbs. (15 kg); V1572-W: 121.25 lbs. (55 kg); V1573: 44.09 lbs. (20 kg)

Dimensions

V1571-W

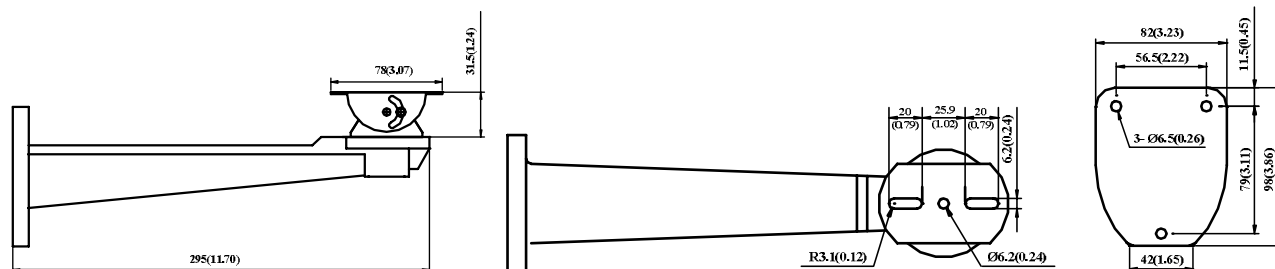

V1572-W

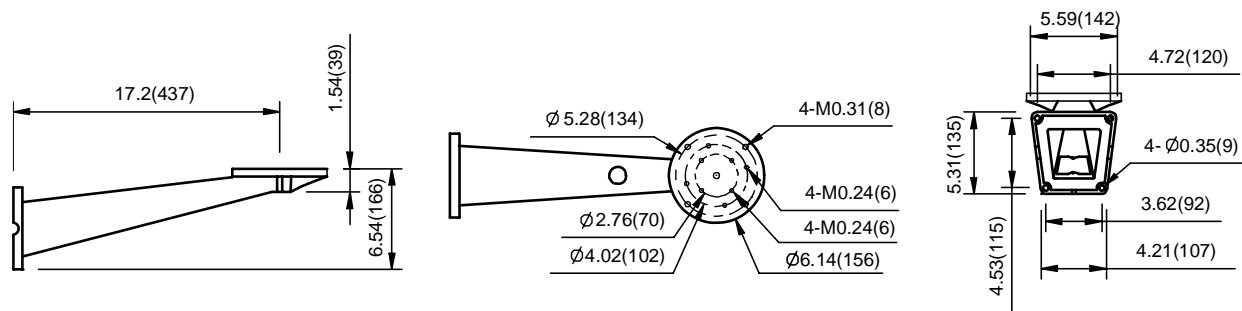

V1573

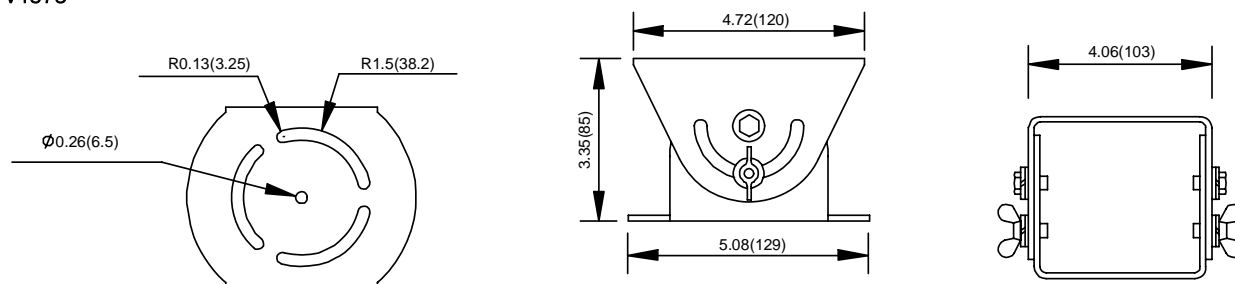

V1574-A

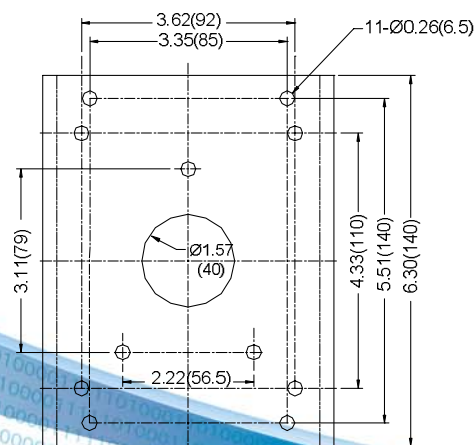

V1574-B

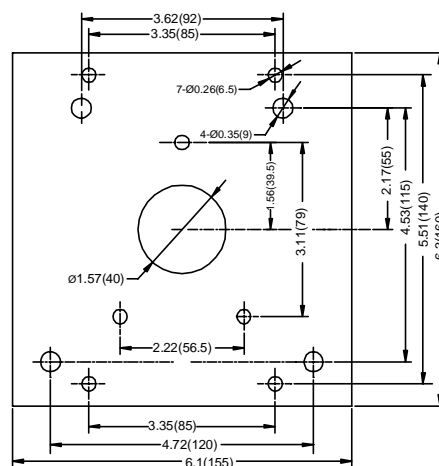

(Unit: inch, in the parentheses is mm)