

# TI2500 Series Fixed-Mount Thermal Imager

## ENCLOSURE WITH INTEGRATED THERMAL IMAGING OPTICS

### Product Features

- Long Wave Infrared (LWIR), Uncooled, Vanadium Oxide Microbolometer
- 320 x 240 Resolution, 38 Microns Pixel Size
- Sensitivity Below 85 mK at f/1.4
- User Definable/Configurable Camera Settings
- Interface Board for 24 VAC/24 VDC Input Power
- NTSC/PAL Analog Video Output
- 2X Digital Zoom
- 2 Lens Options (35 mm and 50 mm)
- Designed for Maximum Rain Protection
- Compact, Lightweight Aluminum Construction



TI2535

- Meets NEMA Type 4 and IP66 Standards
- Complete with Sun Shroud and Heater

The **TI2500 Series** offers a completely integrated advanced thermal imaging device in a Pelco outdoor enclosure. At the core of the **TI2500** is an uncooled, vanadium oxide 38 microns microbolometer, LWIR camera. It delivers 320 x 240 thermal video and supports 2X digital zoom.

The **TI2500 Series** provides outstanding sensitivity below 85 mK at f/1.4. It is capable of multiple display formats, including white hot, black hot, and color signatures. The **TI2500 Series** is available with two different lens configurations (35 mm and 50 mm focal lengths) for effective deployment in a wide range of applications.

The powder-coated, aluminum constructed enclosure makes the **TI2500 Series** ideal for either indoor or outdoor applications. With an absolute operating temperature range of  $-25^{\circ}$  to  $131^{\circ}\text{F}$  ( $-32^{\circ}$  to  $55^{\circ}\text{C}$ ), this indoor/outdoor system can be used in many environments.

A sun shroud and built-in thermostatically controlled heater are standard features on the **TI2500 Series**.

The **TI2500 Series** produces video imagery within 5 seconds of turning on the unit, within the operating temperature range.

The **TI2500 Series** has an input voltage of 24 VAC or 24 VDC.

**TI2500 Series** cameras are factory focused and locked at infinity; however, they can be manually adjusted by a qualified technician.

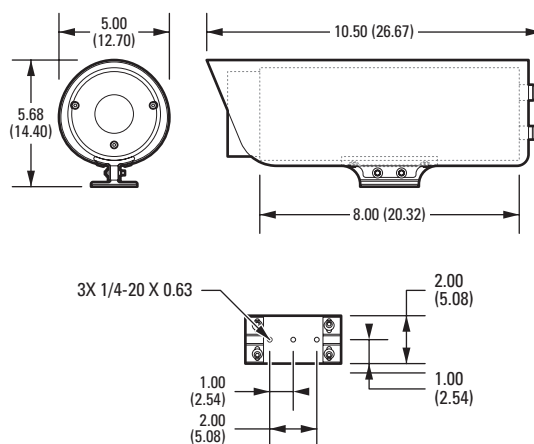

NOTE: VALUES IN PARENTHESES ARE CENTIMETERS; ALL OTHERS ARE INCHES.



by Schneider Electric

International Standards  
Organization Registered Firm;  
ISO 9001 Quality System



C1309 / REVISED 6-18-10

# TECHNICAL SPECIFICATIONS

## MODELS

Model Number	Format	Focal Length
TI2535	NTSC	35 mm
TI2535-X	PAL	35 mm
TI2550	NTSC	50 mm
TI2550-X	PAL	50 mm

## MECHANICAL

Latching	2 captivated hex screws
Face Plate	2 hex screws
Cable Entry	2 adjustable 0.5-inch NPT liquid-tight glands

## ELECTRICAL

Connections	16 to 24 gauge screw-terminal jack on built-in interface board (bipolar)
Input Power	4 W, 6.2 VA nominal
Input Voltage	
24 VAC	18 to 27 VAC
24 VDC	14 to 32 VDC
Power Consumption	
24 VAC	260/350 mA
24 VDC	170/290 mA
Heater	Thermostatically controlled heater

## GENERAL

Construction	Aluminum
Finish	Gray polyester powder coat
Environment	Indoor/outdoor
Operating Temperature	-25° to 131°F (-32° to 55°C)
Storage Temperature	-58° to 185°F (-50° to 85°C)
Weight	
Unit	4.7 lb (2.1 kg)
Shipping	11 lb (5 kg)

## CERTIFICATIONS/RATINGS

- CE, Class A
- FCC, Class A
- UL/cUL Listed
- C-Tick
- Meets NEMA Type 4 and IP66 standards

## THERMAL CAMERA/OPTICS

Detector	Uncooled microbolometer, vanadium oxide
Array Format	320 x 240
Pixel Size	38 microns
Spectral Response	7.5 to 13.5 $\mu$ m, LWIR
Video Output	1 Vp-p, 75 ohms
Normalization Source	Internal shutter (offset only), 0.7 seconds video freeze during shutter wink
Time to Image	Less than 2 seconds, no thermoelectric cooler
Image Control	2X digital zoom
Serial Command	RS-232/RS-422 compatible
Temporal NE $\Delta$ T	85 mK at f/1.4
Display Formats	White hot, black hot, and color signatures
Orientation	Invert/revert capability in software
Field of View	
TI2535	20° (H) x 15° (V)
TI2550	14° (H) x 10° (V)
Focus Range	
TI2535	3 ft (1 m) to infinity
TI2550	13 ft (4 m) to infinity
Hyper Focal Distance	
TI2535	85 ft (26 m)
TI2550	114 ft (35 m)

## RECOMMENDED MOUNTS

<b>Ceiling/Pedestal</b>	
EM1009U, EM1015U	Medium duty ceiling/pedestal mount
<b>Wall</b>	
EM1450	Light duty wall mount
<b>Pipe/Pole</b>	
EM1109	Medium duty pedestal mount for horizontal or vertical pipe/pole applications
EM2000	Medium duty mount for vertical applications
EM2200	Medium duty mount for horizontal applications

## RECOMMENDED POWER SUPPLIES

WCS1-4	Outdoor camera power supply, 100/120/240 VAC input; one 24/26/28 VAC output; total current capacity of 4 A (100 VA)
WCS4-20	Outdoor multiple camera power supply, 120/240 VAC input; four fused 24/28 VAC outputs; total current capacity of 20 A (480 VA)

**Note:** Pelco thermal imaging products are subject to U.S. government export control regulations. Diversion contrary to U.S. law is prohibited. Questions about specific products can be sent to [exportcontrol@pelco.com](mailto:exportcontrol@pelco.com).

### Pelco, Inc. Worldwide Headquarters:

3500 Pelco Way, Clovis, California 93612-5699 USA

**USA & Canada** Tel: (800) 289-9100 • FAX: (800) 289-9150

**International** Tel: +1 (559) 292-1981 • FAX: +1 (559) 348-1120

[www.pelco.com](http://www.pelco.com)

Pelco, the Pelco logo, and other trademarks associated with Pelco products referred to in this publication are trademarks of Pelco, Inc. or its affiliates. All other product names and services are the property of their respective companies. Product specifications and availability are subject to change without notice. ©Copyright 2010, Pelco, Inc. All rights reserved.