

T10Z5712PDC-CS

10X 5.7mm - 57mm F1.2
for 1/3 type Cameras, Motorized Zoom
CS-Mount

with DC Auto Iris and Preset

Model No.		T10Z5712PDC-CS		Effective	Front		Ø45.0mm	
Focal Length		5.7mm - 57mm		Lens Aperture	Rear		Ø8.6mm	
Max. Aperture Ratio		1:1.2		Back Focal Length			8.5mm	
Max. Image Format		4.8mm x 3.6mm(Ø6mm)		Flange Back Length			12.5mm	
Operation Range	Iris	F1.2 - F560C		Mount			CS-Mount	
	Focus	1.8m - Inf.		Filter Size			M49 P=0.75mm	
	Zoom	5.7mm -57mm		Tripod Screw			1/4 - 20UNC	
Control	Iris	DC Auto Iris		Dimensions			W68.5mm x H76.3mm x D88mm	
	Focus	Motorized, Preset		Weight			500g	
	Zoom	Motorized, Preset						
Object Dimension at M.O.D.	5.7mm	147.6cm x 110.8cm						
	57mm	15.1cm x 11.6cm						
Angle of View	D	1/3 type	54.2° - 5.9°	1/4 type	42.0° - 4.5°			
	H		44.6° - 4.8°		34.2° - 3.7°			
	V		34.2° - 3.7°		25.9° - 2.7°			
		Iris		Focus			Zoom	
Supply Voltage		—		DC8V			DC8V	
Current		—		25mA or less			25mA or less	
Response Time		—		Approx. 3.5 sec.			Approx. 4 sec.	
Preset Potentiometer		—		5kQVR			5kQVR	
Coil	Drive	190Ω						
	Control	1000Ω						
Operating Temperature		- 10°C - +50°C						

1/3
type

CS

M.O.D. : Minimum Object Distance

Dimensions

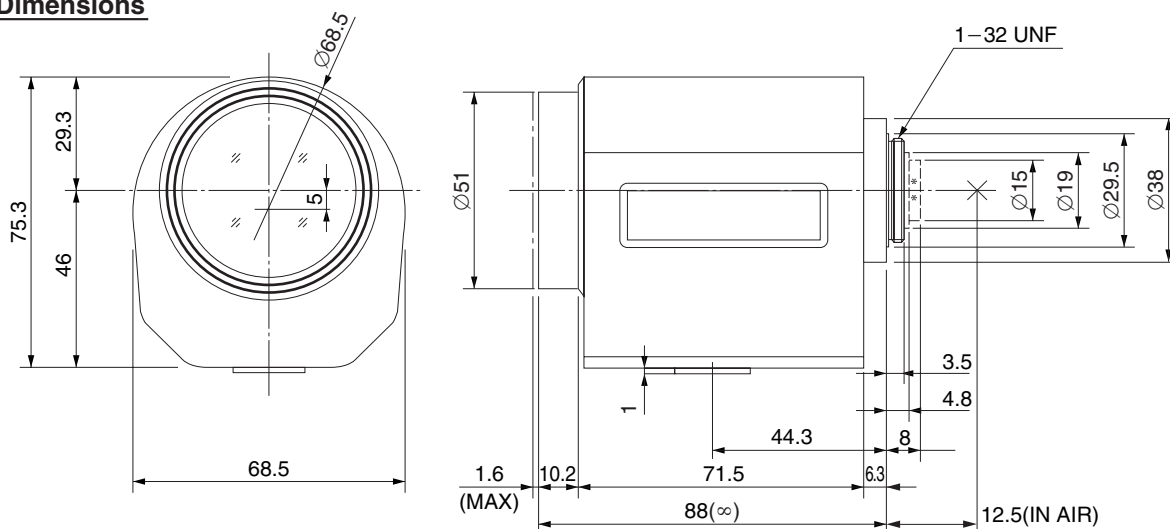

Wiring Diagram

PRESET POTENTIOMETER

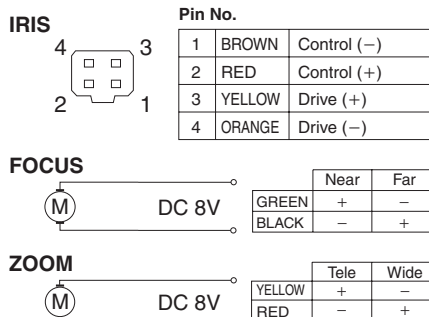
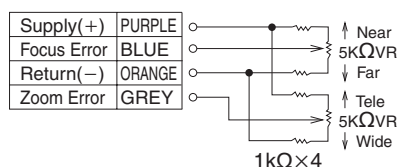

** : for B/W camera

Using with a B/W camera, please use the attached "B/W aberration compensation filter" and "FB compensation spacer". The filter(M20 P=0.5mm) should be screwed onto the lens from rear side and the spacer should be placed between lens and camera.