

RHW75C2N
Videolarm®

2525 Park Central Blvd. Decatur, GA 30035

 1-800-554-1124 • www.videolarm.com
PRODUCT FEATURES

- Resists up to a .22 caliber bullet
- Thermostatically controlled 12Vdc or 24Vac heater and surge protection
- Integrated Wall Mount standard; Pendant Mount available (1 ½" pipe thread)
- Rugged, vandal-resistant painted cast aluminum top
- Universal mounting plate for IP network camera systems
- Optically clear and durable polycarbonate lower dome

RHW75C2N
Vandal-Resistant Rugged Housing
PRODUCT DESCRIPTION

The indoor and outdoor 7" Vandal-Resistant Rugged Housing models offer versatility and camera protection in a compact size. It accepts many network cameras from Axis, Canon, Elmo, JVC, Panasonic & Sony as a PTZ or a single fixed camera with a maximum camera length of 7.5". On outdoor models two heaters and two blowers are included. Temperature range is -40° F to + 120° F.

OPTIONAL COMPONENTS AND ACCESSORIES:

PB24L Rugged outdoor wireless box, 220/110vac input, 24vac output 2.4GHz, 5.8GHz, or 900Mhz access point. Omni directional antenna. 	CWKFD2 24Vac Cold Weather Kit for an additional heater and blower For Outdoor FusionDomes in extremely cold weather 	PRM30G Aluminum parapet mount bracket with 20" extension, includes 1 ½" NPT 	PB24 Rugged cast aluminum power box with 84vA and 24vA power supply 	WM20G Aluminum gooseneck wall bracket, includes 1 ½" NPT 	PS2496N NEMA 4x rated outdoor plastic enclosure, 115Vac input, 24Vac output: 1 Camera output - 1.1A 1 Heater output - 4A (96vA) 	ACA2 Aluminum corner mount bracket with female inserts 	WM30G Aluminum parapet mount bracket, includes 1 ½" NPT 
---	---	---	---	---	---	--	---

MODELS:

Rugged Housing 7"	IP Ready™	PTZ	24Vac	Heater/Blower	Wall Mount
RHW75C2N	√	√	√	√	√
RHW75CF2N	√		√	√	√
IRHP75TF	√				
IRHP75TN	√	√			
RHW7C2		√	√	√	√
RHW7CF2			√	√	√

Rugged Housing MODEL NUMBER SYSTEM:

R	H	W	7	5	C		2	N
Rugged Housing	Wall Mount	Dome with extended trim ring	Clear Dome	PTZ Camera	24Vac Input	IP Ready Network		
IRH Indoor Rugged Housing	P Pendant Mount	7 7" Dome	T Tinted Dome	F Fixed Camera				

RHW75C2N

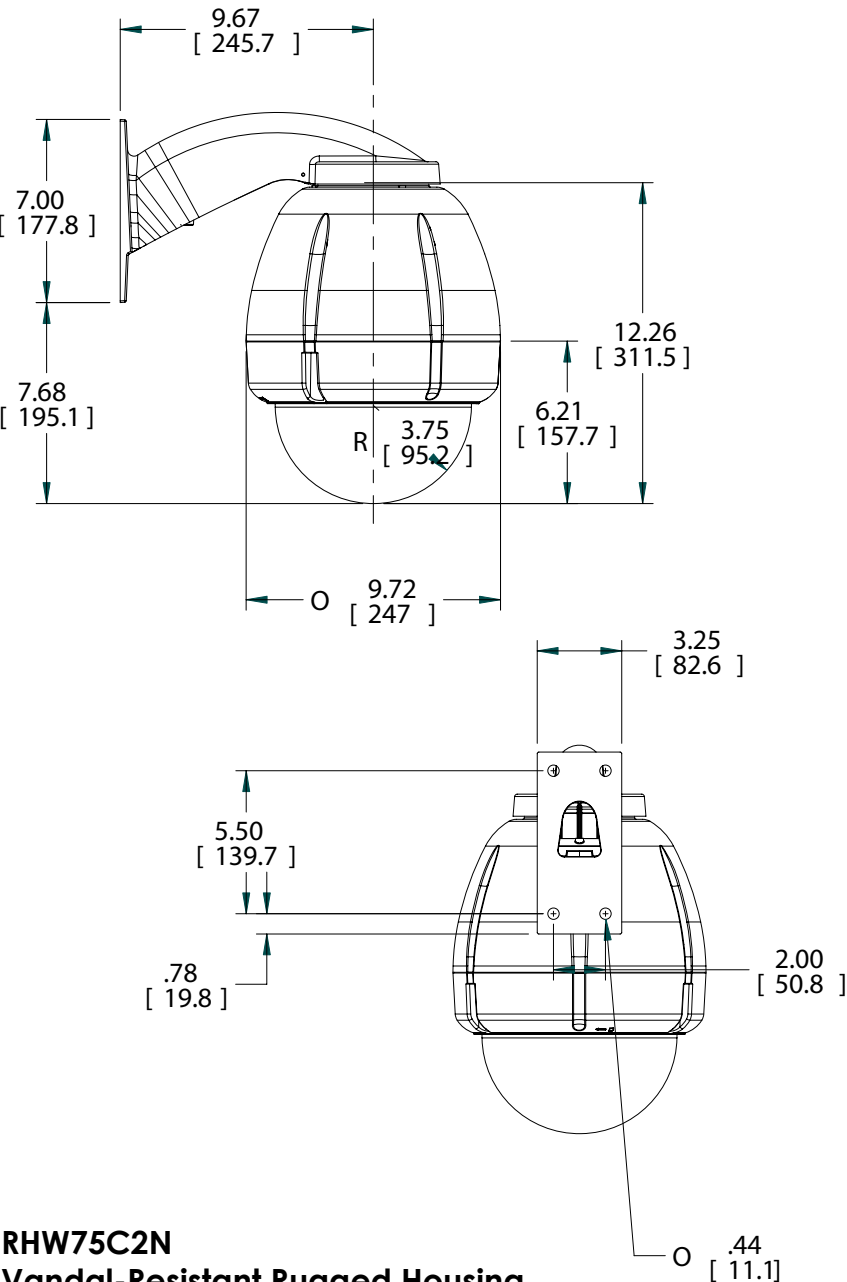

RHW75C2N
Vandal-Resistant Rugged Housing
CERTIFICATIONS AND RATINGS



ARCHITECTURAL/ENGINEERING SPECIFICATIONS

The IP Ready™ RH75 vandal resistant housing shall be an outdoor housing available in either wall or pendant mounted versions. The IRH75 housing shall be an indoor housing available in either wall or pendant mounted versions. Unit is capable of resisting up to a .22 caliber bullet. The RH75 shall be designed to accommodate analog camera systems from Canon & Elmo to IP Ready™ network cameras from Axis, Canon, Elmo, JVC, Panasonic & Sony; and fixed cameras with a maximum camera length of 7.5". Adapter brackets allow certain models to accommodate several different camera systems. For outdoor enclosures, blowers and thermostatically controlled heaters shall be standard, allowing a temperature range of -40° F to +120° F. Units will be available with 24 VAC inputs. The housing top shall be manufactured from durable cast aluminum. The dome shall be made of optically clear, injection molded polycarbonate material, and shall be held in place with (3) fasteners, and a sealing O-ring shall be included. A safety cable shall be provided to hold the dome while servicing. Access to the enclosure shall be from below. On Network models the enclosure includes a 24vac to 12vdc (18vdc, JVC model) power supply for single power impute. The outdoor network models also include a 110vac to 24vac transformer.

Mechanical Specifications	
Size: (Product/shipping)	14.7" x 8.2" x 14.5" (h*w*d) 374 x 208 x 369m
Weight: (Product/shipping)	13 lbs/ 6kg
Construction Top:	.125" (3mm) Cast aluminum
Dome:	Injection-molded polycarbonate blend
Wall Mount Bracket: Pendant Mount Bracket:	Machined & cast aluminum Cast and machined aluminum

Environmental Specifications	
Operating Temperature:	-40° F to 120° F -40° C to 49° C
Heater activates at	60 °F (15° C)
Heater deactivates at	80°F (27° C)
Effective Projected Area (EPA):	Approx. 0.12 m^2
Operating Humidity:	Up to 100%

Electrical Specifications	
Power: Standard Outdoor models Network Outdoor models	24vac, 52 watts (excluding camera) 24vac, 80 watts

Shipping Specifications		
Model	Shipping Weight	Box Dim.
RHW75	14 lbs	17 x 14 x 17
RHP75	14 lbs	17 x 14 x 14