

TECHNICAL DATA SHEET - LCT Series Desktop Articulating Arm

peerless®

MODEL: LCT 101



The **LCT 101** is designed to secure a VESA 75 or VESA 100 LCD computer monitor to a desktop or similar mounting surface.

Features:

- Multi-directional adjustment for optimal viewing
- Durable Gas-Strut and Ball-joint system for smooth, stable operation
- Conforms with VESA 75 / 100 mounting pattern
- Supports LCD panels up to 25 lbs (11.3 kg)
- Supports 10" to 22" screens
- Mounting options for all surfaces (desk clamp, desk bolt)
- Strong die cast aluminum alloy construction
- Compact retractable design increases work space
- Advanced cable management design
- Desk clamp and desk bolt included

Dimensions:

Weight:

10 lb (4.5 kg)

Shipping weight:

12 lb (5.4 kg)

Maximum Load Capacity:

25 lb (11.3 kg)

Shipping Carton dimensions:

L = 12.75 in (324 mm)

W = 18.63 in (473 mm)

H = 6.13 in (156 mm)

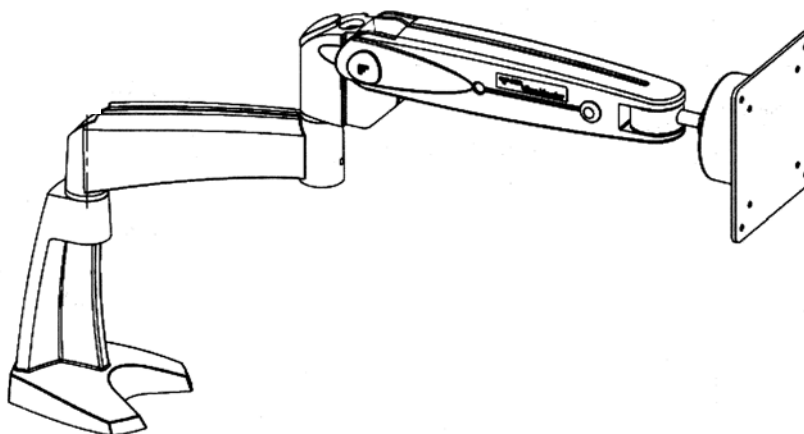

ARCHITECTS SPECIFICATIONS

The desktop mount shall be a Peerless model **LCT 101**. It shall include all mounting hardware for attachment to a desk clamp or desk bolt. It shall be constructed of die cast aluminum alloy. Assembly and installation shall be done according to instructions provided by the manufacturer.

Peerless Industries, Inc.

3215 W. North Ave. Melrose Park, IL 60160
708-865-8870 800-865-2112 Fax 708-865-2941

www.peerlessmounts.com

ISSUED: 05-10-05 SHEET NO: 090-9570-3 10-29-08

RANGE OF MOTION

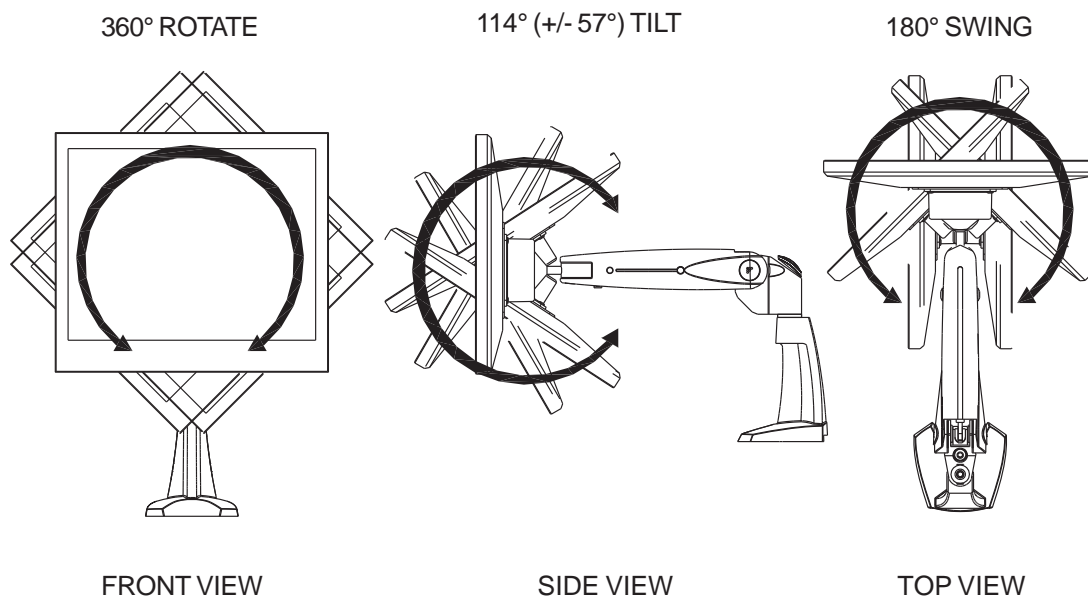
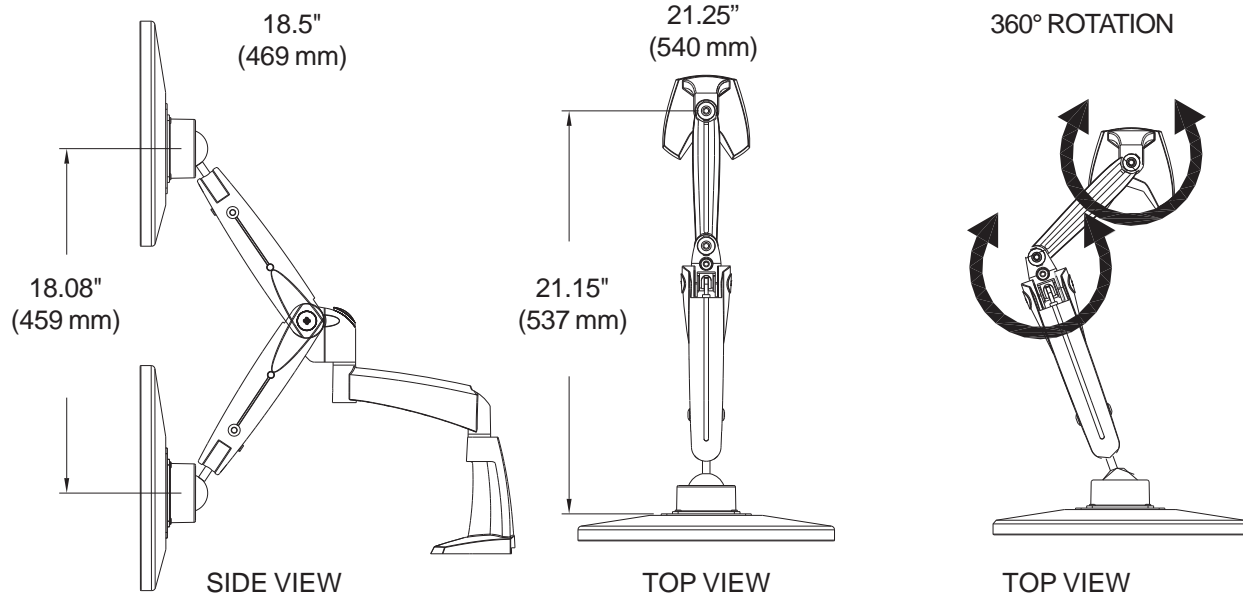

DIMENSIONS

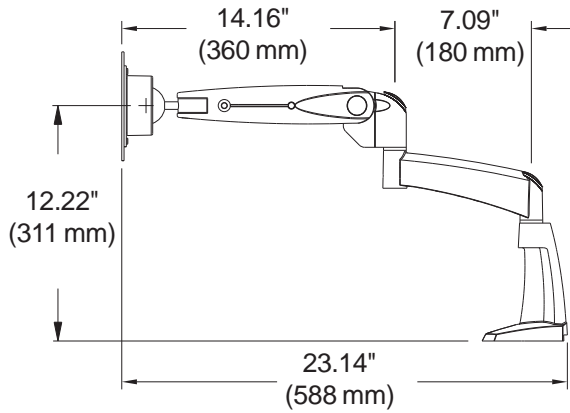

SIDE VIEW

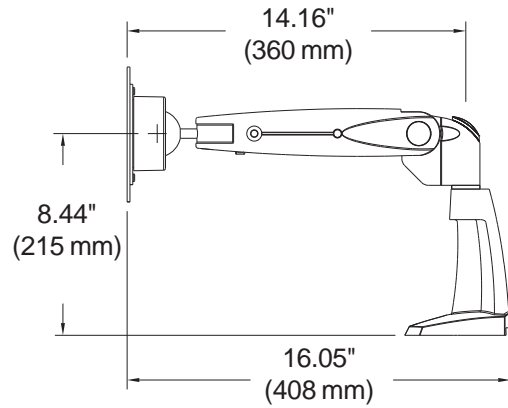

SIDE VIEW

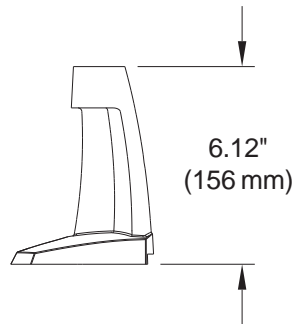

SIDE VIEW

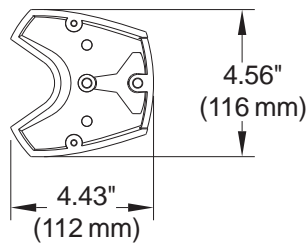

BOTTOM VIEW