



Legacy® Series Integrated Positioning System

PRESSURIZED OUTDOOR ENCLOSURE, COAXITRON® COMPATIBLE

Product Features

- Indoor/Outdoor Operation, Offering Extra Protection from Adverse Environmental Conditions
- RediLINK® Quick-Connect Feature
- Delrin® Worm-Gear Drives
- Optional Preset Positioning and 360° Pan Rotation
- Gold-Plated Pin Connectors Ensure Reliable Contact
- Prewired, Internal Feedthrough
- Easily Removed Clamshell Covers
- Bottom-opening Wall Mount Houses Integral Receiver
- Receiver Offers Adjustable Lens Voltages, Selectable Camera Voltages for NTSC or PAL Video, Transient Suppression Circuit Protection, and Auto/Random Scan as Standard Features



LEGACY PT780 PAN/TILT
AND EH8106L ENCLOSURE

The **Legacy® Series** for adverse environments is designed to protect equipment exposed to severe indoor/outdoor conditions. The innovative system consists of “building block” components designed to simplify installation. Components include a pressurized enclosure, pan/tilt, receiver, and wall mount. The system also features Pelco’s RediLINK® mechanical and electrical quick-connectors making assembly fast and effortless.

The **Legacy** pressurized enclosure is designed to meet stringent environmental standards. The enclosure is factory sealed and pressurized with dry nitrogen to 5 psi. Should the camera or lens require servicing, the enclosure may be easily recharged in the field. A relief valve prevents overcharging of the enclosure. Constructed of aluminum, the enclosure features an adjustable mounting cradle, thermostatically controlled heaters, and lens preset capabilities. An optional sun shroud is available for additional protection from the elements.

The **Legacy Series** pan and tilt is capable of handling loads up to 52 pounds (23.6 kilograms) and features gold-plated electrical pin

connectors to ensure reliable contact and smooth operation. The pan and tilt also features a Delrin® worm gear that requires no lubrication, is corrosion-resistant, and ensures long life. Limit stops are internally adjustable. Available in fixed or variable speed models, options for the pan and tilt include preset positioning, heater blanket, and 360-degree pan positioning. The pan and tilt is prewired for internal feedthrough for all enclosure and camera functions.

The receivers in the **Legacy Series** have a simple 3-wire power connection with an on/off switch that supplies power to the entire system. Choose from fixed or variable speed models, with or without presets, for 120/24/230 VAC applications. All models are compatible with Coaxitron® control systems and Pelco RS-422 control systems utilizing D or P type protocols.

The **Legacy** wall mount is constructed from aluminum. The mount opens from the bottom for easy access and installation of the **Legacy Series** Receiver. The mount can also be used for pole, corner and parapet applications when used with the appropriate adapter.



TECHNICAL SPECIFICATIONS

Pan/Tilt

MECHANICAL

Pan Rotation	Movement in horizontal plane: 0–355° 0–360° (SL models only)
Pan Speed	
VS models only	1-17°/sec ±1° (maximum load condition)
All others	9°/sec ±1°
Tilt Rotation	90° down from horizontal; 60° up from horizontal
Tilt Speed	
VS models only	1-4°/sec ±0.5° (maximum load condition)
All others	3°/sec ±0.5°
Torque Output	
VS models only	18.3 ft.lbs (24.8 N•m) at rated voltage and 75°F (23°C)
All others	23.8 ft.lbs (32.3 N•m) at rated voltage and 75°F (23°C)
Maximum Load	
VS models only	40 lbs (18.14 kg) at specified torque
All others	52 lbs (23.55 kg) at specified torque
Pan/Tilt Drive System	Delrin® worm gear; ground and polished stainless steel worm
Pan/Tilt Bearings	Roller thrust bearings and bronze Oilite bushings
Lubricants	
Bearings	NLGI #2; Lithium complex grease fortified with molybdenum
Chain	Teflon chain lubricant, such as Tri-Flow
Braking	Friction

ELECTRICAL

Input Voltage	120 VAC or 24 VAC, 50/60 Hz 12 VDC (VS models)
VA Required	(At specified input voltage)
	120 VAC 24 VAC 12 VDC
Pan	19.2 VA (0.16A) 21.6 VA (0.9A) 17.04 VA (1.42A)
Tilt	32.4 VA (0.27A) 24 VA (1A) 12.48 VA (1.04A)
Total	51.6 VA (0.43A) 45.6 VA (1.9A) 29.52 VA (2.46A)
Maximum Current	2 amps per conductor (SL models only)
Connectors	Amp CPC type, mate supplied (37 pins)
Motor Type	
VS models only	12 VDC continuous duty, DC permanent magnet
All others	Single phase, instantaneous reversing, induction type, 120 VAC or 24 VAC, 50/60 Hz, impedance protected, 50% duty cycle; 30 minute rating
Limit Switches	5 amp, 250 VAC maximum; internal adjustment
Pan/Tilt Conductor Requirements	
Standard model	20 unshielded, plus video & camera sync coax*
Standard with /PP	27 unshielded, plus video & camera sync coax*
Standard with /SL	14 unshielded, plus video & camera sync coax*
Standard with SL/PP	20 unshielded, plus video & camera sync coax*

*Including safety ground

Note: Two additional conductors may be required with /HB option.

Note: Presets are a function of the receiver. Each pan/tilt with preset option is capable of 32 presets (first 8 are alarming) when used with a Coaxitron matrix control and compatible preset receiver.

Cable Distances**

	6 Conductors	7 Conductors***
PT780P Series		
20 AWG (0.5 mm ²)	1,370 ft (417 m)	2,745 ft (836 m)
18 AWG (1.0 mm ²)	2,180 ft (664 m)	4,370 ft (1,331 m)
16 AWG (1.5 mm ²)	3,470 ft (1,057 m)	6,940 ft (2,115 m)
PT780-24P Series		
20 AWG (0.5 mm ²)	59 ft (17.98 m)	118 ft (35.96 m)
18 AWG (1.0 mm ²)	94 ft (28.65 m)	188 ft (57.30 m)
16 AWG (1.5 mm ²)	149 ft (45.41 m)	298 ft (90.83 m)
PT780-VS Series	5 Conductors	
20 AWG (0.5 mm ²)	24 ft (7.3 m)	
18 AWG (1.0 mm ²)	38 ft (11.58 m)	
16 AWG (1.5 mm ²)	60 ft (18.28 m)	

**Cable distances are based on:

- 26.4 volts AC output voltage from controller (24 VAC models) or 132 volts AC output voltage from controller (120 VAC models) or 12 VDC output voltage from controller (12 VDC models), and
- 10% cable loss with both motors (pan/tilt) running simultaneously

***Using 2-wire motor common

GENERAL

Construction	
Pan/Tilt	Aluminum exterior; painted steel and aluminum interior parts
Worm Gear	Delrin, premium performance acetal
Worm	Ground and polished stainless steel
Environment	Indoor/outdoor
Ambient Temperature	-10°F to 140°F (-23°C to 60°C)
Weight	21.5 lb (9.7 kg) approximate
Shipping Weight	25 lb (11.3 kg) approximate

CERTIFICATIONS/RATINGS (Pan/Tilt Only)

- CE, Class B
- Meets NEMA Type 3R and IP54 standards (pan/tilt only)

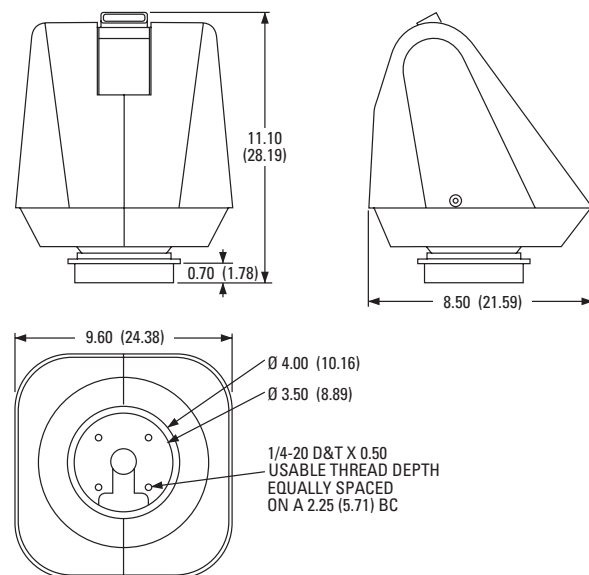

NOTE: VALUES IN PARENTHESES ARE CENTIMETERS; ALL OTHERS ARE INCHES.

LEGACY PT780 SERIES PAN/TILT

TECHNICAL SPECIFICATIONS

Enclosure

MECHANICAL

Front Window	Tempered glass; 0.225-inch (5.71 mm) thick
Camera Mounting	Multiple mounting holes on camera sled
Maximum Camera and Lens Size	Accepts camera and lens combinations* (including BNC connector) up to: 18" L x 4.00" W x 4.00" H (45.72 cm x 10.16 cm x 10.16 cm) or 18" L x 5.00" Dia. (45.72 cm x 12.7 cm)
Enclosure Mounting	RediLINK 26-pin connector mates enclosure to pan/tilt
Purge Fitting	Standard Schraeder valve to allow enclosure to be filled with dry nitrogen
Purge Relief Fitting	Prevents over pressurization of enclosure

*Assumes lens is fully extended.

ELECTRICAL

Input Voltage	120 VAC (230 VAC optional) for heaters. (Factory wired for 120 VAC; must specify 230 VAC at time of order)
Power Consumption (for Heaters)	80 watts Heaters are thermostatically controlled to activate on at 40°F (4°C) and off at 60°F (15°C)
Input Connector	Souriau 85107E2016P, 16-pin jam nut, panel mount receptacle (Souriau 85106EC2016S, MS-type mating connector supplied.)
Maximum Cable Distances (120 VAC)	16 AWG (0.5 mm ²) 2,238 ft (682 m) 18 AWG (1.0 mm ²) 1,410 ft (430 m) 20 AWG (1.5 mm ²) 886 ft (270 m)
(230 VAC)	16 AWG (0.5 mm ²) 8,224 ft (2,507 m) 18 AWG (1.0 mm ²) 5,182 ft (1,579 m) 20 AWG (1.5 mm ²) 3,257 ft (993 m)

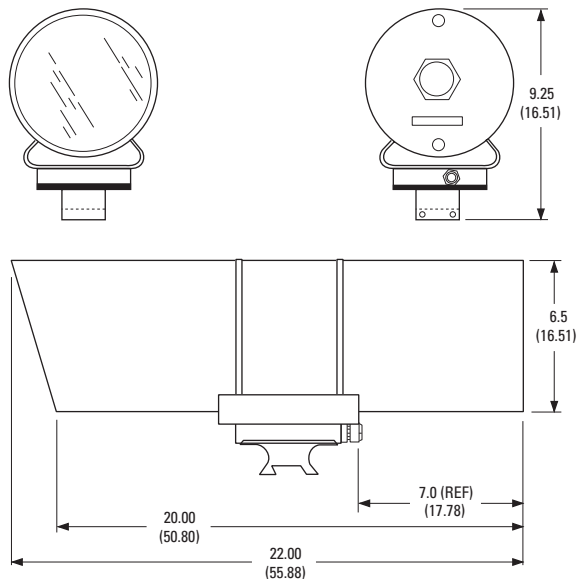

NOTE: VALUES IN PARENTHESES ARE CENTIMETERS;
ALL OTHERS ARE INCHES.

LEGACY EH8106L ENCLOSURE

GENERAL

Construction	Aluminum
Finish	Gray polyester powder coat
Unit Weight	17.2 lb (7.8 kg)
Shipping Weight	23 lb (10.4 kg)

ENVIRONMENTAL

Ambient Operating Temperature	-40° to 122°F (-40° to 50°C) with heater(s)
Vibration	5 to 60 Hz with 0.082-inch total travel (15 g's at 60 Hz). From 60 to 1,000 Hz, 5 g's rms with random vibration
Altitude	Sea level to equivalent of 10,000 ft (3,048 m)
Acoustic Noise	Operates in 150 dB acoustic noise environments
Humidity	Up to 100% relative humidity. Standard Schraeder and pressure relief valves provide positive internal pressure with dry nitrogen

CERTIFICATIONS/RATINGS (Enclosure Only)

- CE, Class B
- Meets NEMA Type 6 and IP67 standards (enclosure only)

MODEL NUMBERS

MODELS

ENCLOSURE

EH8106L

Legacy pressurized outdoor enclosure with lens preset capabilities and 120 or 230 VAC heaters (specify heater voltage at time of order). 6-inch (15.24 cm) inside diameter and 20-inch (50.8 cm) lower body length. For use with PT780 Series pan/tilts.

PAN/TILTS

PT780P

Medium duty, indoor/outdoor pan/tilt with RediLINK connector, 120 VAC

PT780P/PP

Same as PT780P except with presets

PT780SL

Same as PT780P except unit is capable of 360° pan rotation

PT780SL/PP

Same as PT780SL except with presets

PT780-VS

Medium duty, indoor/outdoor variable speed pan/tilt, 12 VDC

PT780-VS/PP

Same as PT780-VS except with presets

PT780-VSSL

Same as PT780-VS except 360° pan rotation

PT780-VSSL/PP

Same as PT780-VSSL except with presets

PT780-24P

Medium duty, indoor/outdoor pan/tilt with RediLINK connector, 24 VAC

PT780-24P/PP

Same as PT780-24P except with presets

PT780-24SL

Same as PT780-24P except unit is capable of 360° pan rotation

PT780-24SL/PP

Same as PT780-24SL except with presets

Note: Legacy systems (enclosure, pan/tilt, receiver, mount, camera, and lens) are available. Consult the factory for available configurations.

OPTIONAL ACCESSORIES

ENCLOSURE

EH8000RKIT

Dry nitrogen recharging kit (non-refillable)

PSKIT8100

Pressure sensor kit. Provides a contact closure that can be wired to trigger an alarm when internal pressure drops to 2 psi.

SS8006

Sun shroud

PAN/TILT

HB1*

Heater blanket option, 120 VAC, 40 watts (0.33 amp). Allows operation to -50°F (-45°C). Thermostatically controlled to activate on at 40°F (4°C) and off at 60°F (15°C).

HB2*

Same as HB1 except 24 VAC, 40 watts (1.7 amps)

HB3*

Same as HB1 except 230 VAC, 40 watts (0.17 amp)

*Factory installed options only. Please consult factory.

LEGACY RECEIVERS

LRD41A11-1/-2/-3

Integral receiver for use with LWM41 wall mount. Fixed speed, Coaxitron compatible. 120/24/230 VAC

LRD41C21-1/-2/-3

Integral receiver for use with LWM41 wall mount. Fixed speed, Coaxitron/RS-422 compatible with 64 presets. 120/24/230 VAC

LRD41C22-1/-2/-3

Integral receiver for use with LWM41 wall mount. Variable speed, Coaxitron/RS-422 compatible with 64 presets. 120/24/230 VAC

LRD41C-CONNKIT

Two 9-pin connectors that interface with the 18-position double-stack Aux/Alarm connector on the LRD41C** Series receiver. Required to enable the Aux/Alarm capabilities of the receiver.

LRD41TLC

Receiver plug-in module for testing control functions.

RECOMMENDED MOUNTS

LWM41

Wall mount; can be used with/without optional integral Legacy receiver

PM2000, PM2010

Ceiling/pedestal mount

CM400

Corner mount adapter for LWM41 wall mount

PA2000

Pan/tilt adapter for ceiling/pedestal mount; must use with PM2000/PM2010 mounts

PA402

Pole mount adapter for LWM41 wall mount

PP300L, PP301L

Parapet mount (corner) for LWM41 wall mount

PP400

Parapet mount (wall) for LWM41 wall mount

PP4348

Parapet mount (rooftop) for LWM41 wall mount



Pelco Worldwide Headquarters:

3500 Pelco Way, Clovis, California 93612-5699 USA

USA & Canada Tel: (800) 289-9100 • FAX (800) 289-9150

International Tel: (559) 292-1981 • FAX (559) 348-1120

www.pelco.com

Pelco, the Pelco logo, Legacy, RediLINK and Coaxitron are registered trademarks of Pelco.

Delrin is a registered trademark of DuPont.

Specifications subject to change without notice.

©Copyright 2006, Pelco. All rights reserved.