

PROIQCART

product information sheet

Product Specifications

Fits most: 32" - 50" flat panels

Supports up to: 80 lbs (36.3 kg)*

Tilt: -5° to +15°

VESA compliant: 100x200 to 600x400

Warranty: 5 years

Color: Black

*Total capacity including panel and components not to exceed 100 lbs (45.4 kg)

Product Benefits

- Height adjustable from 51" to 63" in 4" increments (measured from floor to center of mount head)
- Includes adapters for greater VESA compatibility
- Lift n' Lock™ for quick installation
- Displays can be mounted in portrait or landscape orientation
- Integrated in-post cable management
- Nesting base for easy storing of multiple carts
- Caster base with four locking, non-scuffing 4" wheels provides safe and easy movement over any surface
- Rubberized bumpers won't scuff walls or doors
- Quick assembly
- Complete Grade 5 hardware kit



Carts and Stands



PROHDCART



PROIQCART



FSUA



FS



Caster base
with locking wheels



Included adapters

Dedicated to being a one-stop-shop for professional products, OmniMount remains on the cutting edge of product innovation. That's why we're the natural choice for any professional, industrial or commercial application. Understanding the needs of the market, OmniMount manufactures a full line of carts and stands that are second to none. The PROIQCART is a streamlined flat panel cart offering convenient mobility and functionality.



PROIQCART technical data sheet



Dedicated to being a one-stop-shop for professional products, OmniMount remains on the cutting edge of product innovation. That's why we're the natural choice for any professional, industrial or commercial application. Understanding the needs of the market, OmniMount manufactures a full line of carts and stands that are second to none. The PROIQCART is a streamlined flat panel cart offering convenient mobility and functionality.

Product Specifications

Fits most: 32" - 50" flat panels

Supports up to: 80 lbs (36.3 kg)*

Tilt: -5° to +15°

VESA compliant: 100x200 to 600x400

Warranty: 5 years

Color: Black

*Total capacity including panel and components not to exceed 100 lbs (45.4 kg)

Product Benefits

- Height adjustable from 51" to 63" in 4" increments (measured from floor to center of mount head)
- Includes adapters for greater VESA compatibility
- Lift n' Lock™ for quick installation
- Displays can be mounted in portrait or landscape orientation
- Integrated in-post cable management
- Nesting base for easy storing of multiple carts
- Caster base with four locking, non-scuffing 4" wheels provides safe and easy movement over any surface
- Rubberized bumpers won't scuff walls or doors
- Quick assembly
- Complete Grade 5 hardware kit



	Stock Code	Packaging UPC	MC UPC
Americas	1004780-1	728901026140	728901719592
International	NA	NA	NA

Box Contents	Qty
Caster	4
Adapter	4
Cap	1
Cover	1
Leg	2
Base plate	2

	Dimensions WxDxH inches (cm)	Wt lbs (kg)
Product Box	21.7 x 73 x 8.7 (550x1855x220)	59.5 (27)
Master Carton	NA	NA

Box Contents	Qty
Center post	1
Tilting head	1
Monitor plate	1
Tilt knob	1
Complete hardware kit	1
Instruction manual	1

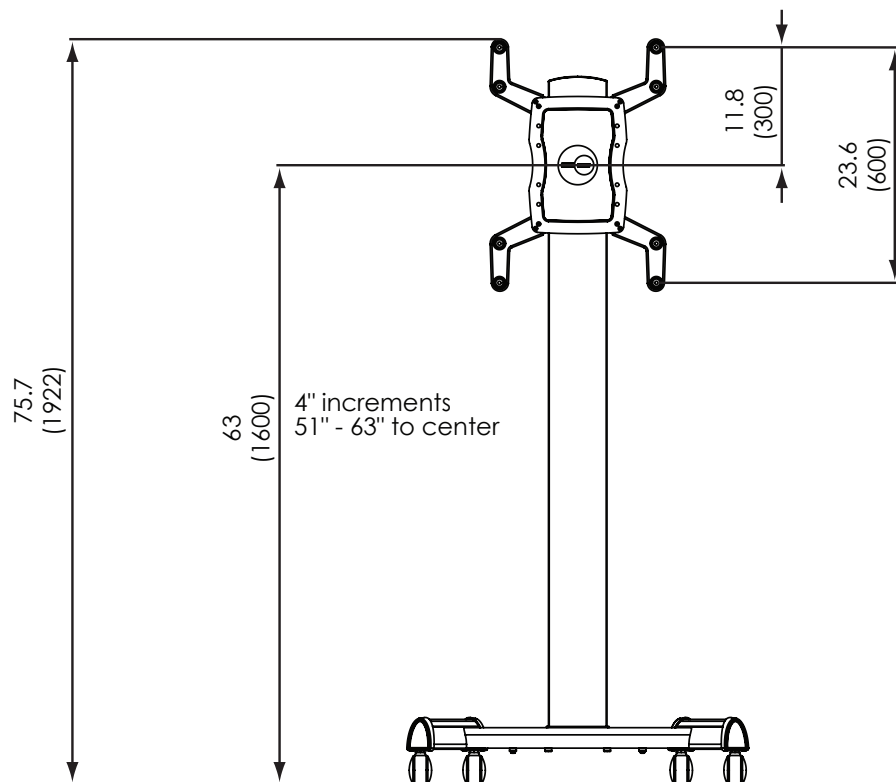
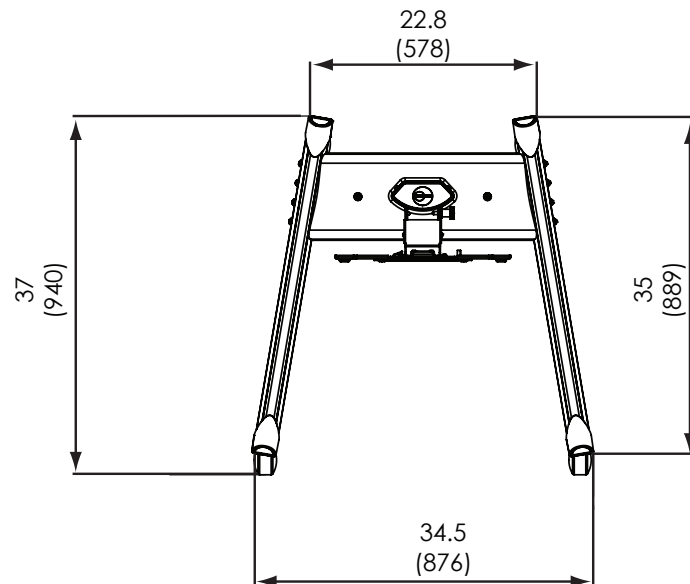

inches (mm)