



Dual-screen Ceiling Mount

For 30" to 50" LCD and Plasma Screens

MODELS

Dedicated Models:

Includes theft resistant hardware for attaching screen to mount

PLB-1 Black

* Dedicated adapter plates come in flat black and include security fasteners

SCREEN ADAPTER

Dedicated Models: Requires screen-specific adapter to be purchased separately

SPECIFICATIONS

| | | |
|--|---------------------------------------|---|
| | Distance from ceiling | Varies depending on ceiling plate and extension column used |
| | Tilt Swivel | 20° 360° |
| | Max load | 300 lb (136 kg) |
| | Product Dimensions (W x H x D) | 10" x 5.4" x 9.46" (254 x 137 x 240 mm) |
| | Mounting Surfaces | Virtually all ceiling structures (Requires accessory) |
| | Ship Weight | 21 lb (9.5 kg) |

1. Entire unit swivels 360° with swivel-stop feature
2. 20° adjustable tilt (for each screen)
3. Mounts horizontally or vertically (dedicated adapter plate required, sold separately)
4. Requires extension column and ceiling plate, sold separately



CERTIFICATIONS



ACCESSORIES



DCS, DCT Models:
Ceiling Platespg# 126



ADD Models:
Ceiling Extensionspg# 128

TECHNICAL DRAWINGS

For expanded product information and technical data visit www.peerlessmounts.com

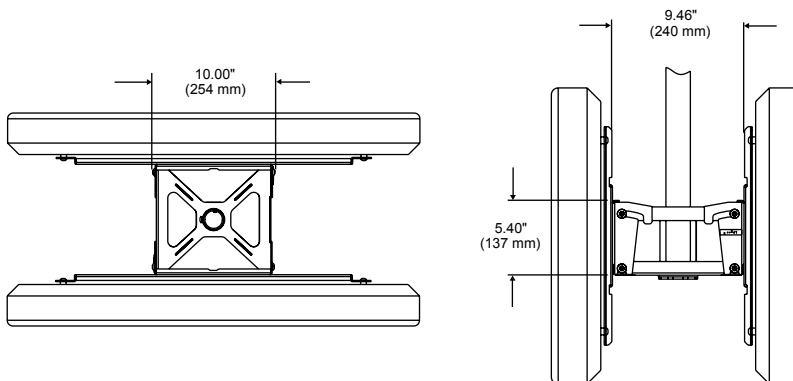

To verify mount compatibility with any LCD, plasma or projector model use MountFinder™ at www.peerlessmounts.com



CLICK: www.peerlessmounts.com



CALL: 800.865.2112



FAX: 708.865.2941