

**BOSCH**  
Invented for life

# MIC Series 500 Professional



- ▶ **Rated to an industry leading IP68**
- ▶ **Multiple camera programming through Camset software**
- ▶ **Many mounting and viewing options**
- ▶ **Easy set-up and configuration through the powerful on-screen display**
- ▶ **Multi-protocol operation**
- ▶ **On-site canting ability**
- ▶ **Ultra long-life silicone wiper**
- ▶ **Powerful privacy masking allowing over 900 separate masked zones**

The MIC Series 500 Professional combines cutting-edge technology with the latest production techniques to provide a class-leading feature set in an economical package. The MIC Series 500 Professional range takes high quality surveillance to new levels of excellence.

As a best-fit camera for virtually any security application, it can be installed in the harshest of environments. Thanks to its IP68-rated aluminum casing, the MIC Series 500 Professional functions perfectly in the most demanding conditions. This tough casing provides protection from the elements and physical attack. Coupled with an optically perfect flat viewing window, integrated long life silicone wiper, and a reversible rain shield, ensures high quality images regardless of the installed environment.

The brushless-motor technology offers ultra-reliable, whisper-quiet operation with full 360° continuous rotation pan and 267° tilt control for exceptional viewing capability. Small increment pan/tilt speeds from just 0.2° per second to 120° per second gives the user precise control. This speed control is especially important when used with video analytic systems, particularly for tracking subjects when fully zoomed in.

On-screen menus allow camera set-up from the control room via a remote keyboard. The MIC Series 500 Professional is compatible with all leading control systems and has a wide choice of protocols available.

A choice of true day/night camera modules offering up to 36x optical zoom (12x digital) are available, providing 540 TV lines (PAL) or 520 TV lines (NTSC). Preset positions, preset tours and random tours ensure flexible surveillance options.

The integrated privacy card provides over 900 individual privacy masks, with a choice of mask styles, for use in high density residential applications. Each mask changes size smoothly and quickly to ensure the covered target cannot be seen.

The MIC Series 500 Professional features twist-lock canting functionality. This allows the camera to be securely canted on-site at 45° for pole mount applications allowing the base of the pole to be viewed. The sheer flexibility of mounting options allows the camera to be installed upright, inverted or canted to achieve the perfect field of view.

## Functions

### **Rated to an industry leading IP68**

Subjected and certified to rigorous IP68 dust and immersion tests, the MIC Series 500 Professional is perfectly suited for installation in even the most unforgiving environments.

**Brushless motor technology**

Ultra-reliable brushless motors provide whisper-quiet operation and smooth control.

**Host of mounting and viewing options**

Faultless operation in upright, inverted or canted positions gives the user a host of mounting and viewing possibilities. The twist-lock canting feature allows the MIC Series 500 Professional to be canted to 45° on site. This allows, for example, the base of the pole to be viewed in upright pole-mounted applications.

**Sophisticated privacy masking**

The integrated privacy card allows for over 900 individual privacy masks, with a choice of mask styles, to be programmed.

**Easy set-up**

Camera settings can be adjusted via the on-screen menu from a control room via a remote keyboard.

**Multi-protocol operation**

Compatible with virtually any control equipment available today, the MIC Series 500 Professional seamlessly integrates with the vast majority of security systems.

**Applications:**

- General CCTV
- Town centers
- ANPR systems
- Vandalism prone areas
- Extreme environments
- Rapid deployment
- High security
- Prestigious developments
- Broadcast
- Marine/costal
- Architectural

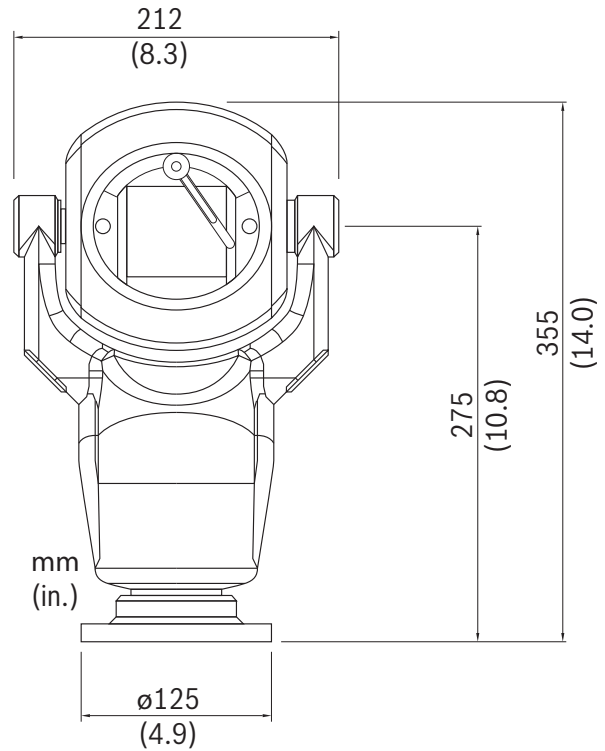
**Installation/Configuration Notes**

Front Detail, 90° (straight)

**Certifications and Approvals**

Electromagnetic Compatibility (EMC)	Complies with FCC Part 15, ICES-003, and CE regulations, including EN50130-4 and EN61000-3-2 & 3-3 and EN55022
Product Safety	Complies with CE regulations, UL, EN, and IEC Standards 60950-1 & 22
Weatherproofing	IP68 (1m submersion for 24 hours)

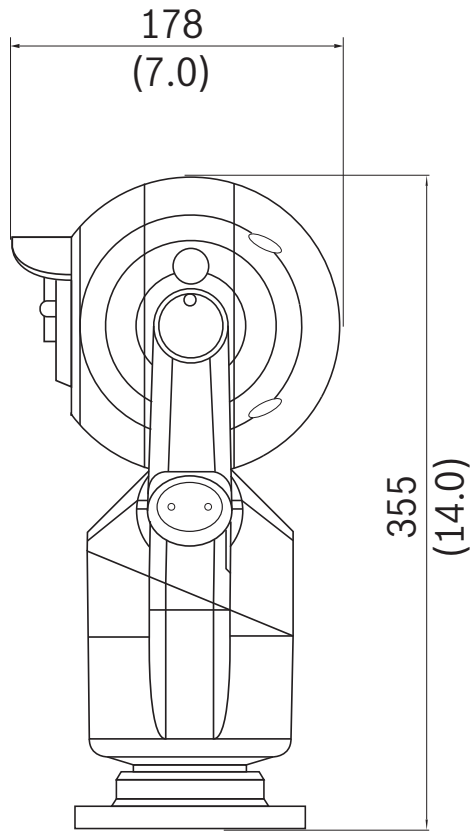

Side Detail, 90° (straight)

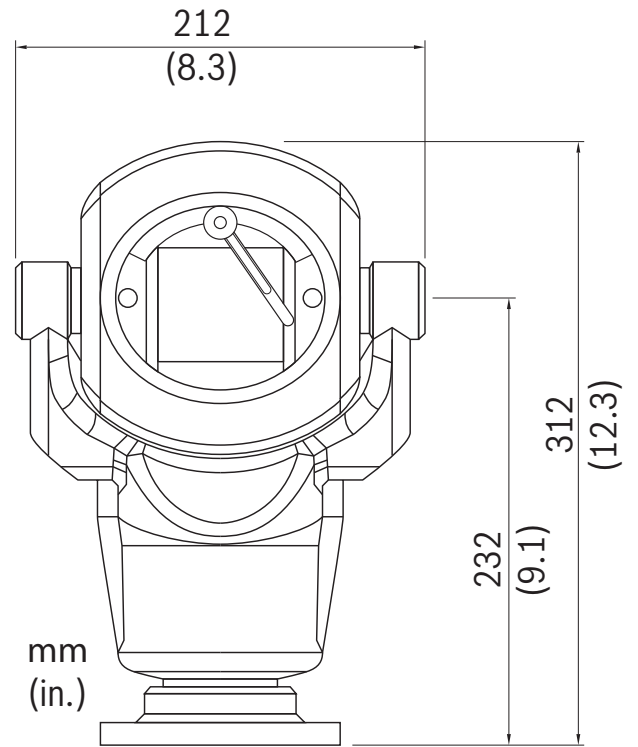

Front Detail, 45° (canted)

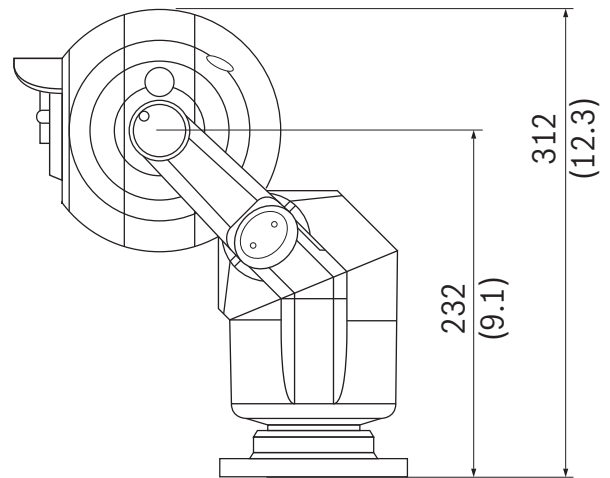

Side Detail, 45° (canted)

## Technical Specifications

### Camera Module

Image Sensor	1/4 in. Exview CCD (WDR)
Effective Pixel Elements	PAL: Approx. 440,000; 752(H) x 582(V) NTSC: Approx. 380,000; 768 (H) x 494 (V)
Horizontal Resolution	PAL: 540 TVL NTSC: 520 TVL
Filter	Automatic mechanical IR cut filter
Focus System	Auto or manual
Iris	Auto or manual with slow shutter integration modes
Synchronization	Internal / External (V-Lock)
Signal-to-Noise Ratio (SNR)	50 dB or more
Back Light Compensation (BLC)	On/Off
White Balance	Automatic
Automatic Gain Control (AGC)	-3 to 28 dB, 2 dB steps
Aperture Control	16 Steps

### 18x Optical Zoom Module

Lens	F=4.1 mm (wide) to 73.8 mm (tele), F1.4 to F3.0
Zoom	18x optical (12x digital)
Field of View	48° (wide) to 2.8° (tele)
Minimum Illumination	1/60 s mode, 0.7 lx (typical) (F1.4, 50 IRE) 1/4 s mode, 0.07 lx (typical) (F1.4, 50 IRE)
Shutter Speed	1/4 to 1/10,000 s (20 steps) NTSC, PAL

### 36x Optical Zoom Module

Lens	F=3.4 mm (wide) to 122.4 mm (tele), F1.6 to F4.5
Zoom	36x optical (12x digital)
Field of View	57.8° (wide) to 1.7° (tele)
Minimum Illumination	1/60 s mode: 1.4 lx (typical) (F1.6, 50 IRE) 1/4 s mode: 0.1 lx (typical) (F1.6, 50 IRE)
Shutter Speed	1/4 to 1/10,000 s (20 steps) NTSC 1/3 to 1/10,000 s (20 steps) PAL

### Operational

Auto Flip	Yes
Manual Flip	Yes
E-flip	Yes, E-flip enables the camera module to invert the image
Dynamic Privacy Zones	3-D privacy masking with 959 zones
Presets	64 telemetry presets accurate to 0.08° utilizing resolver technology using the on-screen menu or via Camset, Up to 10 camera module presets (Sony sets) to allow ANPR, color correction etc.
Preset Tours	Four (4) tours each with up to 32 presets
Pattern Tours	Two (2) tours

Sector Titles	64 sectors, 20 characters per title
Preset Titles	20-character caption for each of the 64 pre-sets
Home Position	Preset 1 or tour
On-screen Menu	Most camera functions can be accessed through the on-screen menu

### Communication and Protocols

Communication	RS485 / RS422
Control Protocol	FV and Bosch protocols pre-installed. Twin protocol packs including FV/Pelco, FV/VCL, FV/American Dynamics and FV/Kalatel can be loaded using the MIC Universal Camera Setup Software Utility (Camset)

### Connectivity

MIC Universal Camera Setup Software Utility (Camset)	Supplied free with each camera, Camset allows direct connection to a USB equipped PC via the MIC Series PSU or over a full duplex or IP network to provide access to all camera functions and useful diagnostic tools
Video	Coaxial via composite cable
Telemetry	Twisted pair. Simplex, half and full duplex operation via composite cable
Power	Via composite cable

### Alarms

Alarm Inputs	One (1) tamper input (additional inputs possible with optional alarm card)
Alarm Communication	Tamper switch (ground connection)

### Mechanical

Drive Unit	Brushless, integral pan/tilt motor drive
Pan Angle	360° continuous rotation
Pan Speed	Up to 120° per second (variable)
Tilt Angle	270°
Tilt Speed	0.2° to 80° per second (variable)
Speed Control	Closed loop electronics
Preset Accuracy	±0.17°(typical)
Proportional Pan/Tilt to Zoom	Yes

### Electrical

Input Voltage	18 VAC
Power Consumption	25 W max. without heater; 36 W max. with heater on

### Options

Camera Module	18x camera module or 36x camera module
Camera Color System	NTSC or PAL
Telemetry Control Card	Built-in
Washer Drive	Optional washer kit (MIC-WKT Kit with washer pump drive)
Heater	Standard

Privacy Masking	Privacy card with up to 959 masks, fitted as standard
Alarm Card	Optional, 8-input with washer pump drive function, fits in MIC Series power supply
Biphase Converter	Optional, fits in MIC Series power supply expansion slot (BP-4)
<b>Environmental</b>	
Operating Temperature (with heater)	-30 °C to +60 °C (-22 °F to +140 °F)
Weatherproofing	IP68 (1m submersion for 24 hours)
<b>Construction</b>	
Dimensions (W x H x D)	
Upright and Inverted	212 x 355 x 177 mm (8.35 x 13.98 x 6.97 in.)
Canted	212 x 312 x 255 mm (8.35 x 12.28 x 10.0 in.)
Weight	7 kg (15.43 lb) including 4 in. pitch circle diameter (PCD) base
Viewing Window	Tempered flat glass
Construction Material	Cast solid aluminum
Standard Colors	Black (RAL9005) or white (RAL9010)
Standard Finish	Alocrom 1200 surface treatment with powder coat paint, sand finish
Window Wiper	Standard
Canting	Twist Lock canting secured by two security screws

### Ordering Information

<b>MIC-500-ALB18N MIC Series 500 Professional 18x NTSC Camera, Black</b> 18x, NTSC, PTZ camera, black, with an integrated wiper, heater, and privacy function	<b>MIC-500-ALB18N</b>
<b>MIC-500-ALB18P MIC Series 500 Professional 18x PAL Camera, Black</b> 18x, PAL, PTZ camera, black, with an integrated wiper, heater, and privacy function	<b>MIC-500-ALB18P</b>
<b>MIC-500-ALB36N MIC Series 500 Professional 36x NTSC Camera, Black</b> 36x, NTSC, PTZ camera, black, with an integrated wiper, heater, and privacy function	<b>MIC-500-ALB36N</b>
<b>MIC-500-ALB36P MIC Series 500 Professional 36x PAL Camera, Black</b> 36x, PAL, PTZ camera, black, with an integrated wiper, heater, and privacy function	<b>MIC-500-ALB36P</b>
<b>MIC-500-ALW18N MIC Series 500 Professional 18x NTSC Camera, White</b> 18x, NTSC, PTZ camera, white, with an integrated wiper, heater, and privacy function	<b>MIC-500-ALW18N</b>

### Ordering Information

<b>MIC-500-ALW18P MIC Series 500 Professional 18x PAL Camera, White</b> 18x, PAL, PTZ camera, white, with an integrated wiper, heater, and privacy function	<b>MIC-500-ALW18P</b>
<b>MIC-500-ALW36N MIC Series 500 Professional 36x NTSC Camera, White</b> 36x, NTSC, PTZ camera, white, with an integrated wiper, heater, and privacy function	<b>MIC-500-ALW36N</b>
<b>MIC-500-ALW36P MIC Series 500 Professional 36x PAL Camera, White</b> 36x, PAL, PTZ camera, white, with an integrated wiper, heater, and privacy function	<b>MIC-500-ALW36P</b>
<b>Accessories</b>	
<b>MIC-24PSU-UL 24 VAC Camera Power Supply</b> 24 VAC, 50/60 Hz power supply for MIC Series cameras	<b>MIC-24PSU-UL</b>
<b>MIC-115PSU-UL 115 VAC Camera Power Supply</b> 115 VAC, 60 Hz power supply for MIC Series cameras	<b>MIC-115PSU-UL</b>
<b>MIC-240PSU-UL 240 VAC Camera Power Supply</b> 240 VAC, 50 Hz power supply for MIC Series cameras	<b>MIC-240PSU-UL</b>
<b>MIC-ALM Alarm and Washer Pump Drive Card</b> 8 Input alarm and washer pump drive card for PSU (Not for IR PSU)	<b>MIC-ALM</b>
<b>MIC-BP4 Biphase Converter</b> Biphase converter for non-IR versions of MIC series power supply units	<b>MIC-BP4</b>
<b>MICUSB485CVTR2 USB to RS485 Signal Converter</b> USB to RS485 signal converter to allow MIC Series cameras to connect to a PC, supplied with each camera	<b>MICUSB485CVTR2</b>
<b>MIC-501KBD Keyboard Controller</b> Keyboard controller with 3-axis joystick for 1 camera (FV PROTOCOL ONLY)	<b>MIC-501KBD</b>
<b>MIC-516KBD Keyboard Controller</b> Keyboard controller with 3-axis joystick for 1 to 16 cameras (FV PROTOCOL ONLY)	<b>MIC-516KBD</b>
<b>MIC-WKT Washer Kit</b> Washer kit for non infrared MIC models (includes washer pump drive card, washer nozzle and mounting brackets for wall and 4 in. PCD base)	<b>MIC-WKT</b>
<b>HAC-WAS05-20 24 VAC Washer</b> 24 VAC washer inst. 5M 25L	<b>HAC-WAS05-20</b>
<b>HAC-WAS05-50 230 VAC Washer</b> 230 VAC washer inst. 5M 25L	<b>HAC-WAS05-50</b>
<b>HAC-WAS30-50 230 VAC Washer</b> 230 VAC washer inst. 30M 25L	<b>HAC-WAS30-50</b>

**Ordering Information**

<b>MIC-DCA-WD Deep Conduit Adapter, White</b> Deep conduit adapter for 4 in. PCD base - white sand finish, RAL9010	<b>MIC-DCA-WD</b>
<b>MIC-DCA-BD Deep Conduit Adapter, Black</b> Deep conduit adapter for 4 in. PCD base - black sand finish, RAL9005	<b>MIC-DCA-BD</b>
<b>MIC-SCA-WD Shallow Conduit Adapter, White</b> Adapter for a MIC-WMB, a MIC-PMB, or a MIC-SPR mount, white sand finish, RAL9010	<b>MIC-SCA-WD</b>
<b>MIC-SCA-BD Shallow Conduit Adapter, Black</b> Adapter for a MIC-WMB, a MIC-PMB, or a MIC-SPR mount, black sand finish, RAL9005	<b>MIC-SCA-BD</b>
<b>MIC-SPR-WD Spreader Plate, White</b> Aluminum spreader plate suitable for brick-work surface mounting – white sand finish RAL9010	<b>MIC-SPR-WD</b>
<b>MIC-SPR-BD Spreader Plate, Black</b> Aluminum spreader plate suitable for brick-work surface mounting – black sand finish RAL9005	<b>MIC-SPR-BD</b>
<b>MIC-CMB-WD Corner Mount Bracket, White</b> Corner mount bracket - white sand finish RAL9010	<b>MIC-CMB-WD</b>
<b>MIC-CMB-BD Corner Mount Bracket, Black</b> Corner mount bracket - black sand finish RAL9005	<b>MIC-CMB-BD</b>
<b>MIC-WMB-WD Wall Mount Bracket, White</b> Wall mount bracket - white sand finish RAL9010	<b>MIC-WMB-WD</b>
<b>MIC-WMB-BD Wall Mount Bracket, Black</b> Wall mount bracket - black sand finish RAL9005	<b>MIC-WMB-BD</b>
<b>MIC-PMB Pole Mount Bracket</b> Pole mount bracket (includes 2 x 455 mm banding ties for pole diameters 75 to 145 mm)	<b>MIC-PMB</b>
<b>MIC-2M-S 2 m Shielded Composite Cable</b> Shielded Composite 2 m cable that provides power, telemetry and video connection from a MIC Series camera to a MIC Series power supply	<b>MIC-2M-S</b>
<b>MIC-10M-S 10 m Shielded Composite Cable</b> Shielded Composite 10 m cable that provides power, telemetry and video connection from a MIC Series camera to a MIC Series power supply	<b>MIC-10M-S</b>

**Ordering Information**

<b>MIC-20M-S 20 m Shielded Composite Cable</b> Shielded Composite 20 m cable that provides power, telemetry and video connection from a MIC Series camera to a MIC Series power supply	<b>MIC-20M-S</b>
<b>MIC-25M-S 25 m Shielded Composite Cable</b> Shielded Composite 25 m cable that provides power, telemetry and video connection from a MIC Series camera to a MIC Series power supply	<b>MIC-25M-S</b>
<b>MIC-500-RWAB Replacement Wiper Assembly, Black</b>	<b>MIC-500-RWAB</b>
<b>MIC-500-RWAC Replacement Wiper Assembly, Silver</b>	<b>MIC-500-RWAC</b>

**Americas:**  
Bosch Security Systems, Inc.  
130 Perinton Parkway  
Fairport, New York, 14450, USA  
Phone: +1 800 289 0096  
Fax: +1 585 223 9180  
security.sales@us.bosch.com  
www.boschsecurity.us

**Europe, Middle East, Africa:**  
Bosch Security Systems B.V.  
P.O. Box 80002  
5800 JB Eindhoven, The Netherlands  
Phone: +31 40 2577 284  
Fax: +31 40 2577 330  
emea.securitysystems@bosch.com  
www.boschsecurity.com

**Asia-Pacific:**  
Robert Bosch (SEA) Pte Ltd, Security Systems  
11 Bishan Street 21  
Singapore 573943  
Phone: +65 6258 5511  
Fax: +65 6571 2698  
apr.securitysystems@bosch.com  
www.boschsecurity.asia

**Represented by**