



Network Bullet Camera

IV-IP361VKMP

Features:

- . 2-megapixel CMOS Sensor
- . 3 ~ 9 mm Vari-focal, Auto-iris Lens
- . Removable IR-cut Filter for Day & Night Function
- . Built-in IR Illuminators, effective up to 25 Meters
- . Real-time MPEG-4 and MJPEG Compression (Dual Codec)
- . Multiple Streams Simultaneously
- . ePTZ for Data Efficiency
- . Weather-proof IP67-rated Housing
- . Built-in 802.3af Compliant PoE
- . Two-way Audio via SIP Protocol
- . Built-in SD/SDHC Card Slot for On-board Storage
- . Mounting Bracket with Cable Management for Protected Installation

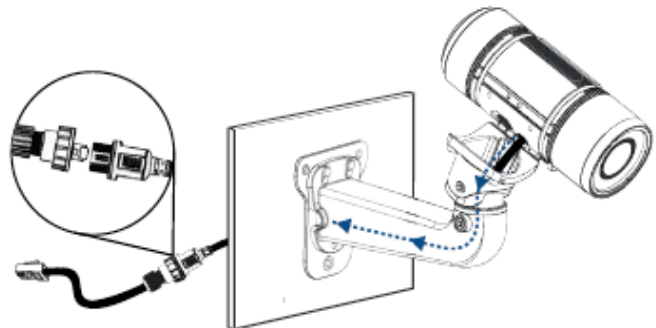

Description:

IV-IP361VKMP is a high-end 2-megapixel network bullet camera for outdoor surveillance.

With high resolution and a combination of outdoor-specific features such as concealed wiring to prevent tampering, the IV -IP361VKMP is the camera of choice for applications such as parking lots, gas stations, and building entrances

| SPECIFICATION | | IV-IP361VKMP |
|--|-------------------|---|
| System | CPU | Mozart 120 SoC |
| | Flash / RAM | 16MB / 128MB + 128MB |
| | Embedded OS | Linux 2.6 |
| Networking | Ethernet | 10/100 Mbps Ethernet, RJ-45 |
| | Protocols | IPv4, IPv6, TCP/IP, HTTP, HTTPS, UPnP, RTSP/RTP/RTCP, IGMP, SMTP, FTP, DHCP, NTP, DNS, DDNS, PPPoE, CoS, QoS, SNMP and 802.1X |
| Video | Compression | MJPEG & MPEG-4 |
| | Streaming | Simultaneous multiple streams |
| | | MPEG-4 streaming over UDP, TCP, HTTP or HTTPS |
| | | MPEG-4 multicast streaming, MJPEG streaming over HTTP or HTTPS |
| | Supports | activity adaptive streaming for dynamic frame rate control, video cropping for bandwidth saving ePTZ for data efficiency, 3GPP mobile surveillance |
| Audio | Frame Rate | MPEG-4: up to 30 fps at 800x600, up to 10 fps at 1600x1200 |
| | | MJPEG: up to 30 fps at 800x600, up to 15 fps at 1600x1200 |
| | Compression | GSM-AMR speech encoding. Bit rate: 4.75 kbps to 12.2 kbps MPEG-4 AAC audio encoding, bit rate: 16 kbps to 128 kbps |
| | Interface | External microphone input, Audio output, |
| Security | Supports | two-way audio via SIP protocol and audio mute |
| | | Multi-level user access with password protection |
| | | IP address filtering, HTTPS encrypted data transmission |
| Camera Specifications | | 802.1X port-based authentication for network protection |
| | Image Sensor | 1/3.2" CMOS sensor in 1600x1200 resolution |
| | Min. illumination | 0.1 Lux / F1.2 0 Lux / F1.2 (IR LED on) |
| | IR illuminator | Built-in IR illuminators, effective up to 25 meters |
| | Shutter Time | 1/5 sec. to 1/40,000 sec. |
| Lens | Angle of view | 31.7° ~ 93.0° (horizontal), 23.8° ~ 68.4° (vertical) |
| | | Board lens, vari-focal, f = 3 ~ 9 mm, F1.2 (wide), F2.1 (tele), auto-iris |
| LED indicators | | Removable IR-cut filter for day & night function |
| Dimensions | | System restore status indicator |
| Weight | NET | Ø 83 x 210 mm |
| Power | | Net: 1600g (Including bracket) |
| | Power supply | DC 12V or AC 24V |
| Operating Environments | Consumption | Max 7W 802.3af compliant Power-over-Ethernet |
| | Temperature | -4 °F ~ 122 °F |
| | Humidity | 90% RH |
| Approvals | | CE, LVD, FCC, VCCI, C-Tick |
| Viewing System | Operation System | Microsoft Windows 2000/XP/Vista |
| | Browser | Mozilla Firefox, Internet Explorer 6.x or above |
| | Cell phone | 3GPP player |
| | Real Player | 10.5 or above |
| | Quick Time | 6.5 or above |
| Image Settings | | Adjustable image size, quality and bit rate, Time stamp and text caption overlay |
| | | Configurable brightness, contrast, saturation, sharpness, white balance, and exposure |
| | | Flip & mirror, AGC, AWB, AEC, Automatic, manual or scheduled day/night mode |
| Alarm and Event Management | | BLC (Backlight Compensation) Supports privacy masks |
| | | Triple-window video motion detection, Tamper detection |
| | | One D/I and one D/O for external sensor and alarm |
| | | Event notification using HTTP, SMTP or FTP |
| On-board Storage | | Local recording or MP4 file |
| Users | | SD / SDHC card slot, Stores snapshots and video clips |
| Housing | | live viewing for up to 10 clients |
| Installation, Management and Maintenance | | Weather-proof IP67-related housing |
| | | Mounting bracket w/ cable concealment, RS-485 interface for scanners, pan/tilts |
| | | Installation Wizard 2 |
| | | 32-CH central management software |
| Applications | | Supports firmware upgrade |
| | | SDK available for application development and system integration |