

## EX26NX Night Vision High Performance IDN w/ LXR

The **EX26NX Night Vision Camera** integrates Extreme CCTV's LXR sensor in full 1/3" format with 24 high output LED infrared illuminators. LXR sensors are known for superb performance under bright light and infrared light conditions. The goal of maximizing night performance with only 24 LEDs has been achieved in the EX26NX with surprising and impressive results. Only 7 Watts of power are required from this compact camera to achieve night vision beyond 75 feet (24 m).

In addition to night vision distance, the EX26NX also provides even illumination through its field of view. (The ability to present high signal / low noise – evenly illuminated video is an Extreme CCTV trademark that is backed with a U.S. Patent.)

A compact all-weather metal housing protects all of the electronics including the LEDs within its waterproof environment. Installation is simple "plug-n-play", night vision is automatic, results are guaranteed.

### Features:

- **LXR 1/3" Sensor for High IR Performance**
- **Z-LEDs at 850 nm or 940 nm protected within the camera housing.**
- **Guaranteed Night Vision beyond 75 ft (24 m) for indoor locations.**
- **Cast & extruded aluminum housing**
- **Internal heat sink / Integral heat sink**
- **Toughened Glass window**
- **Voltage regulation /Power protection**
- **Input power in 12 – 24 volts AC or DC**
- **Double U-Mount included as pan/tilt head (Wall bracket optional)**



Above: The EX25NX.8406 is an Integrated Day Night (IDN) camera with impressive even illumination night performance to 75 feet (24m). Requiring only 7 Watts, the EX26NX easily outperforms other infrared / camera combinations that use 3 to 5 times the amount of power.



**Left:** A very dark warehouse will remain a dark scene for any camera, even the high performance extended-IR SX400 as seen above. Nothing is revealed. ***If there is no light, there can be no picture.***



**Lower Left:** The same DARK scene is revealed clearly in infrared reflectance from the same camera but with its 24 high-efficiency LEDs operating at 850 nanometers. An excellent low-noise picture is pulled out of darkness to a back wall 75 feet away using only 600 milliamps of current at 12 VDC.

### The REEL DEAL™

Extreme CCTV NEVER presents simulated photos to portray results. The video stills above have been captured from real EX26NX camera feeds. REEL DEAL™ images are available to Extreme CCTV dealers by contacting [sales@ExtremeCCTV.com](mailto:sales@ExtremeCCTV.com)

### EX26NX - General Specifications

<b>CCD LXR w/M12 Lens</b>	Various Models – See Part Numbers SX400 LXR 1/3" CCD
<b>Consumption</b>	8 W max. for mono models
<b>Voltage</b>	12 VDC or 24 VAC selectable
<b>Construction</b>	Robust aluminum casting / extrusion Gasketed/Sealed to IP66 / NEMA4
<b>Window</b>	Toughened Glass
<b>Dimensions</b>	89mm (H) x 91mm (W) x 162mm (L)
<b>Weight</b>	1.0 kg (2.2 lbs)
<b>Color</b>	Black (other colors by special order)
<b>Mount</b>	P/T Double-U Bracket Supplied
<b>Wall Bracket</b>	Optional – see below
<b>Cabling</b>	1.6 m (5 feet) of Belden Multi-Pair

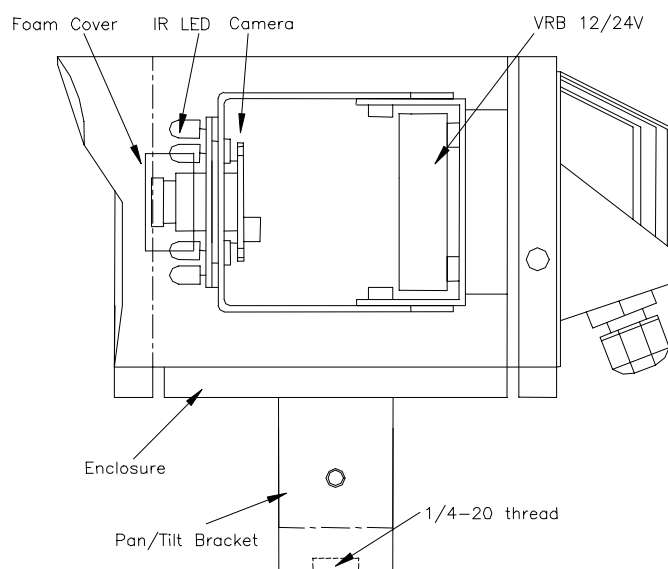
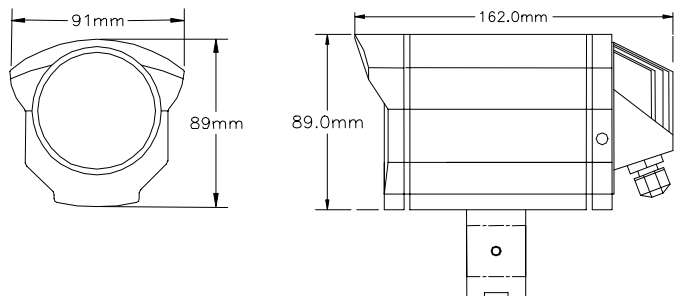

### Part Numbers:

**EX26NX.84xx** -IDN – Mono 1/3" LXR 420 TVL, 24 LEDs, 850 nm

**EX26NX.94xx** -IDN – Mono 1/3" LXR 420 TVL, 24 LEDs, 940 nm

xx – Specifies micro-lens provided at time of order

**05** - 4.3 mm      **12** - 12.0 mm

**06** - 6.0 mm      **16** - 16.0 mm

**08** - 8.0 mm

### Optional Items:

**EXPS.001** Power Supply, 12 VDC, 1.0 A, w/ 2.1 mm plug

**EXMB.020** L-Bracket, Heavy Duty

**EXMB.023** Wall Bracket, die-cast