

ETP-MT/R AED – Defibrillator Emergency Phone Towers

Description

The **ETP-MT/R AED** provides outdoor access to a life-saving Automated External Defibrillator (AED). Vandal-resistant Emergency/Information Tower systems provide exceptional clarity, performance and a sense of security.

Features

- Secured, recessed chamber to house AED unobtrusively
- Optional thermostatically controlled heater for AED compartment maintains temperature above freezing
- AED door can be either unlocked immediately at the initiation of a phone call or remotely by a guard as determined by the installer
- Available Key Reset Relay option allows strobe to continuously flash until physically deactivated
- Radius Tower, with 2" radius corners, offers contemporary architectural styling
- Attention-getting blue light strobe included and mounted atop unit: blue light is continuously lit, strobe is activated when EMERGENCY button is pressed and flashes for duration of call
- Blue light/strobe is housed in protective acrylic housing (except OP 4, 5)
- Two Ultrabright LED lamps light both phone and AED at all times
- Designed to resist extreme weather conditions
- A variety of lettering, signage and color choices are available

Specifications

Dimensions:	12.0(305) W x 10.0(254) D x 108.0(2743) H with 2(51) radius on each corner in(mm)
Weight:	330 lbs. (150 kg)
Construction:	0.25" (6.3mm) steel with multi-coat rust inhibitive coating
Lighting:	Strobe: 1.5 million candlepower, 70 flashes per minute Blue Light: 7 watt high efficiency, 10,000 hour compact fluorescent Faceplates: Ultra bright LEDs, 50,000 hour lifetime
Lettering:	3.25" (83mm) high reflective white letters, available in choice of colors
Power:	Blue light strobe and faceplate light require 120VAC (170mA for each light, 2 amps for each 5ms strobe), also available in 12VDC/24VAC/24VDC
Mounting:	Mounts into concrete foundation using included hardware (shipped in advance). Mounting options available for shorter foundations and pre-poured decks.



ETP-MT/R AED with the OPTION 4 ARM and WEBS-RETRO-MTR4

Communication Options

Emergency/Info Phone:	Model ETP-400D has a red EMERGENCY button and a black INFO button to allow two different types of locations to be called
Emergency/Keypad Phone:	Model ETP-400K has a red EMERGENCY button as well as a black CALL button which allows access to the built-in keypad
Cellular Interface:	Models ETP-CI/GSM or ETP-CI/CDMA when used in conjunction with a phone listed above create a stand-alone cellular Emergency Phone Tower
RF Interface:	Models VOIP-RF and VOIP-1 (or VOIP-RF-900 and VOIP-1), when used in conjunction with a 400-Series phone, create a Radio Frequency Emergency Phone. (Note: other RF equipment is required for a complete system)

ETP-MT/R AED – Defibrillator Emergency Phone Tower

Options & Accessories

PTZ Camera Option:	Model ETP-MT/R AED OP 5 includes an AD Speed-Dome Ultra Camera
PTZ Housing Option:	Model ETP-MT/R AED OP 4 includes an arm for mounting your own dome camera
Fixed CCTV Option:	Model ETP-MT/R AED OP 3 includes a day/night fixed camera w/ vari-focal lens
CCTV Housing Option:	Model ETP-MT/R AED OP 2 includes a housing for mounting your own fixed CCTV
Heater Option:	Add "HTR" to the model number for built-in AED enclosure heater

Dimensions

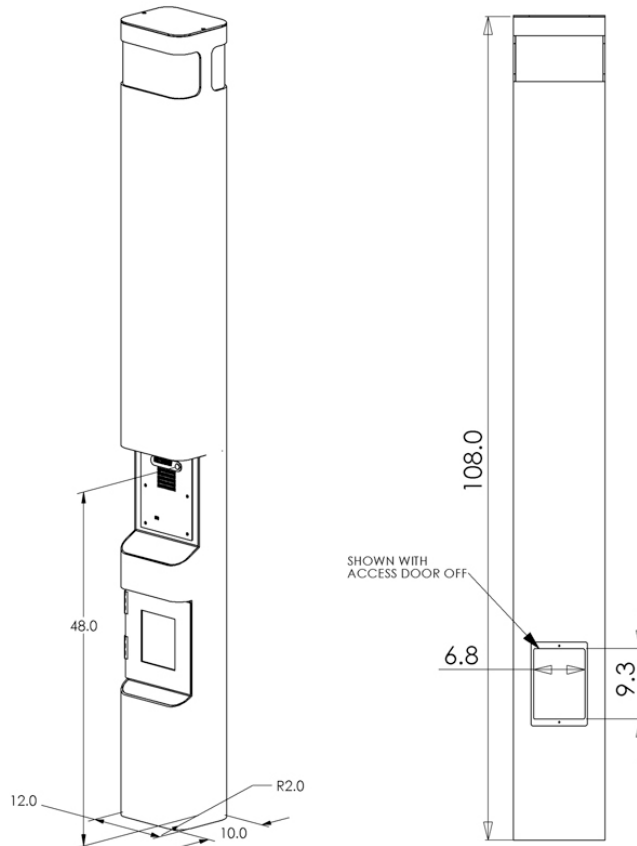

Footprint Dimensions

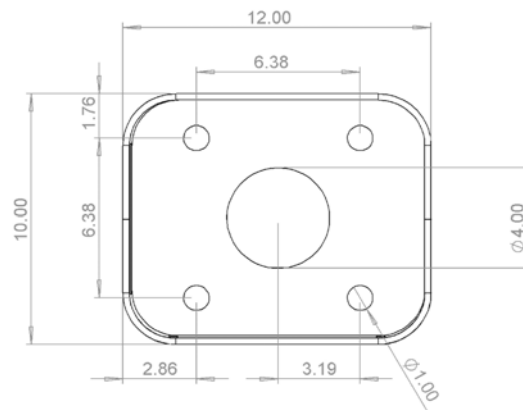

All dimensions are in inches

Copyright 2009 Talk-A-Phone Co. All rights reserved.

Talk-A-Phone Co. • 7530 North Natchez Avenue • Niles, Illinois 60714-3804
Phone 773.539.1100 • Fax 773.539.1241 • info@talkaphone.com • www.talkaphone.com
All prices and specifications are subject to change without notice.
Talk-A-Phone, Talk-A-Lert, Scream Alert and WEBS are registered trademarks of Talk-A-Phone Co.