

EPTZ Series Speed Dome



Outdoor PTZ with wall mount bracket



Indoor PTZ with concrete ceiling mount adaptor

Clear your NIGHT vision!!

The high performing EPTZ Series PTZ speed domes features True Day/Night for 24/7 monitoring, Wide Dynamic Range for extreme lighting conditions and eliminates image noise with Dynamic Noise Reduction. EPTZ Series is also engineered with privacy zone masking to keep certain areas within the camera's field of view private. EverFocus EPTZ Series PTZ speed domes are structurally design to simplify installation for all outdoor and indoor applications.



Product Overview

The revolutionary EPTZ speed dome series made by EverFocus has high performing true day/night function equipped with a removable IR cut filter. During the day, the IR cut filter is utilized for daytime true color recognition and is removed in low-light conditions to maximize infrared sensitivity for clear night vision image.

EPTZ Series can also capture and dramatically improve image quality in scenes consisting of bright and dark areas with Wide Dynamic Range feature. In addition, EPTZ is designed for simple installation and supports all types of mount applications. EPTZ Series comes in both outdoor and indoor models and is available in 27x, 30x and 36x optical zoom.

Features

- Excellent position accuracy to ± 0.1 degree
- Pan/tilt speed from 0.01° to 360° per second
- Simple "snap & lock" camera installation
- Weatherproof IP66 rated to endure all weather conditions (outdoor models only)
- Maximum 192 preset positions available
- Programmable auto panning, 16 tours, 4 patterns
- 4 priority alarm inputs & 2 alarm outputs
- Smart alarm reaction & resume after alarm
- Enhanced auto-resume & power-up function
- RS485 communication
- Multi-line on screen menu
- Digital Flip Function
- Supported protocols: AUTO, EVF, Pelco-P, Pelco-D/Plus-D, A-Type, Panasonic (auto detection)
- Built-in 27x /30x /36x optical AF zoom lens
- Resolution of 480/520/530 TVL
- True Day/Night function with removable IR cut filter
- High sensitivity for better image quality at night
- Wide Dynamic Range (WDR)
- Digital Slow Shutter (DSS)
- Built-in Dynamic Noise Reduction (DNR) (EPTZ3100/3100i only)
- Motion Detection
- Privacy Zone Masking (exclude EPTZ2700/2700i)



Advantages

Wide Dynamic Range (WDR)

WDR feature captures and dramatically improve image quality in scenes consisting of bright and dark areas. Traditional CCD speed domes may have difficulty processing images in strong backlighting. EPTZ Series will process each pixel independently, providing high-quality images with enhanced dynamic range under extreme lighting conditions.



Traditional Speed Dome



WDR Speed Dome



Normal



BLC



WDR

Powerful Auto Mode (AutoPan/Tours/Patterns)

- Adjustable left/right PTZ position, dwell time and speed for auto panning function
- A tour can be composed of preset positions (selectable dwell time / speed) and patterns
- 16 preset positions per group; 16 groups per tour
- 4 patterns with 90 seconds per pattern
- Enhanced auto resume to previous mode, position, tour, pattern or auto panning

True Day/Night & Digital Slow Shutter

EPTZ Series features True Day/Night with manual IR cut filter for day or night performance. During the day, the IR cut filter is utilized for daytime true color recognition and is removed in low-light conditions to maximize infrared sensitivity for clear night vision image. With digital slow shutter feature, shutter speeds are automatically adjusted based on lighting conditions.

Built-in Dynamic Noise Reduction (DNR)

Dynamic Noise Reduction feature can eliminate pixel noise created from low lighting environments. With DNR, ghost and blooming effects are reduced dramatically, producing clean and vivid images. DNR technology also allows a 70% saving of disk storage. This feature is ONLY available with EPTZ3100 and EPTZ3100i.



With True Day/Night



Without True Day/Night



Normal Camera



DNR



High Speed & Position Accuracy

- Excellent preset accuracy to ± 0.1 degree
- Pan/tilt speed from 0.01° to 360° per second
- Ultra stable pan in slow motion

Privacy Zone Masking

When monitoring, there may be certain areas within the camera's field of view that needs to be kept private (for example: a window or doorway to a house). Privacy zone masking enables certain monitoring areas to be concealed from surveillance view, offering up to 8 different areas per screen with selectable masking color. This feature is NOT available with EPTZ2700i or EPTZ2700.



Digital Flip Function

Digital Flip immediately enables automatic 180° turn for improved tracking right below the camera of an object in motion.

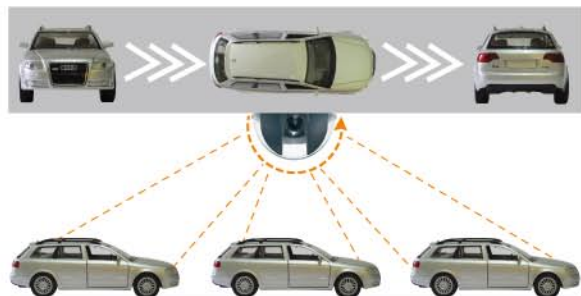

Easy Installation

Simply snap in & lock the camera module into the housing base for a quick and easy installation. EverFocus patent-pending wall mount bracket makes installation easier with a attached arm mount base.



Multi-line On-Screen Display (OSD)

Easy to use multi-line OSD menu for PTZ operation and control.

Maximum 192 Preset Positions

With up to 192 preset positions, each camera position can be set based on surveillance area, dwell time, adjustable speed, focus mode, white balance and title.

Dimensions & Accessories

<p>EPTZ2700i/3100i/3600i Standard Indoor Housing</p> <ul style="list-style-type: none"> Compatible with EPTZ-CMB (concrete ceiling mount adapter), EPTZ-CLM (ceiling pendent mount bracket), EPTZ-ICMB (in-ceiling flush mount bracket) for diverse ceiling and wall mounts Polycarbonate dome cover Aluminum die-cast housing   <p>159mm/6.3" 119mm/4.7" 230mm/9.1"</p>	<p>EPTZ2700/3100/3600 Standard Outdoor Housing (without sun shield)</p> <ul style="list-style-type: none"> Compatible with EPTZ-SSM (outdoor sun shield), EPTZ-WMB (wall mount bracket), EPTZ-CNM (corner mount adapter), EPTZ-PLM (pole mount adapter), EPTZ-PBOX (multi-function conjunction box) for diverse ceiling and wall mounts IP66 Rating Polycarbonate dome cover (clear / smoked / mirrored) Aluminum die-cast housing   <p>280mm/11" 250mm/9.8" 80mm/3.1"</p>	<p>EPTZ2700/3100/3600 Standard Outdoor Housing (with sun shield)</p> <ul style="list-style-type: none"> Compatible with EPTZ-SSM (outdoor sun shield), EPTZ-WMB (wall mount bracket), EPTZ-CNM (corner mount adapter), EPTZ-PLM (pole mount adapter), EPTZ-PBOX (multi-function conjunction box) for diverse ceiling and wall mounts IP66 Rating Polycarbonate dome cover (clear / smoked / mirror) Aluminum die-cast housing   <p>280mm/11" 252mm/10" 206mm/8.1"</p>
<p>EPTZ-CMB Indoor Concrete Ceiling Mount Adapter</p> <ul style="list-style-type: none"> Ceiling mount adapter for indoor EPTZ Aluminum die-cast housing   <p>25mm/1" 80mm/3.1"</p>	<p>EPTZ-WMB Wall Mount Bracket</p> <ul style="list-style-type: none"> Compatible with EPTZ2700/3100/3600 Waterproof with aluminum die-cast housing   <p>235mm/9.3" 171mm/6.7"</p>	<p>EPTZ-PLMN Pole Mount Adapter</p> <ul style="list-style-type: none"> Compatible with EPTZ-WMB and EPTZ2700/3100/3600 Stainless steel   <p>238mm/9.4" 165mm/6.5" 155mm/6.1" 80mm/3.1" 155mm/6.1"</p>
<p>EPTZ-CLM Indoor Ceiling Pendent Pole Mount Bracket</p> <ul style="list-style-type: none"> Shall be together with top housing adapter to mount standard indoor housing on ceiling Aluminum die-cast housing   <p>59mm/2.3" 348mm/13.7" 108mm/4.3"</p>	<p>EPTZ-CNM Corner Mount Adapter</p> <ul style="list-style-type: none"> Compatible with EPTZ-WMB and EPTZ2700/3100/3600 Stainless steel   <p>147.9mm/5.8" 232.9mm/9.2" 4mm/0.43" 100mm/3.9" 170mm/6.7"</p>	<p>EKB500 Integration Keyboard</p> <ul style="list-style-type: none"> Capable of controlling multiple PTZ cameras and DVRs Preset position and pattern control Auto/Random/Frame scanning Capable of interfacing RS-485 and RS-232 formats Full programmable preset tour Controls up to 256 domes from one controller 
<p>EPTZ-ICMB Indoor In-Ceiling Mount Bracket</p> <ul style="list-style-type: none"> Can be installed as flush & recessed ceiling mounting Aluminum die-cast housing Plastic decorative flange   <p>220mm/8.7" 247mm/9.7" 92.3mm/3.6" 220mm/8.7"</p>	<p>EPTZ-PBOX / EPTZ-PBM Multi-Functional Connection Box / PBOX Mount</p> <ul style="list-style-type: none"> Weatherproof and vandal resistant Power supply function Can be used with EVS100(1 CH video server) to become network products Can be used with corner mount (EPTZ-CNM) and pole mount (EPTZ-PLM) adapter to install in different environments   <p>270mm/10.6" 240mm/9.4" 239mm/9.4" 216mm/8.5" 150mm/5.9"</p>	<p>EKB200 Industrial USB Controller Keyboard</p> <ul style="list-style-type: none"> USB interface, plug and play 3-axis joystick for PTZ control function Support standard HID class device, easy for 3rd party integration No external power supply requirement 

Specifications:

Product Model	EPTZ2700 (outdoor)	EPTZ2700i (indoor)	EPTZ3100 (outdoor)	EPTZ3100i (indoor)	EPTZ3600 (outdoor)	EPTZ3600i (indoor)
Pickup Device	1/4" Sony CCD				1/4" Sony Ex-View HAD CCD	
Video Format	NTSC or PAL					
Scanning System	NTSC: 525 TV lines, 60 fields/sec; PAL: 625 TV lines, 50 fields/sec.					
Picture Elements	768 x 494 (NTSC); 752 x 582 (PAL)					
Horizontal Resolution	480 TV lines		520 TV lines		530 TV lines	
Min. Illumination	Normal: 1 Lux Night Mode: 0.005 Lux (ICR ON)		Normal: 0.4 Lux/F1.6 Night Mode: 0.08 Lux/F1.6 (ICR ON)		Normal: 1.4 lux/ 1/60(1/50)sec Night Mode: 0.01 lux/ 1/4(1/3)sec (ICR ON)	
S/N Ratio (AGC off)	48dB		50dB		50dB	
Electronic Shutter	1/60(1/50)~1/10,000(s)		128x~1/60(1/50)~1/120,000(s)(NTSC)		1~1/10,000(s)	
Digital Slow Shutter	Auto: 2x, 4x, 6x, 10x, 16x, 32x Fix: 2x, 4x, 6x, 10x, 16x, 32x		128x		60x (50x for PAL)	
Shutter Selection	AUTO; A.FLK; Manual 1/60(1/50)~1/10,000 selectable		AUTO; A.FLK; Manual 128x~1/60 (1/50)~1/120,000 selectable		AUTO; A.FLK; Manual 1~1/10,000 selectable	
Lens Type	27x optical zoom, f=3.25 mm (wide) to 88mm (tele), F1.5 to F3.8		30x optical zoom, f=3.3 mm (wide) to 99mm (tele), F1.6 to F3.2		36x optical zoom, f=3.4 mm (wide) to 122.4mm (tele), F1.6 to F4.5	
Zoom Ratio	270x max (27x Optical and 10x Digital zoom)		240x max (30x Optical and 8x Digital zoom)		432x max (36x Optical and 12x Digital zoom)	
True Day & Night	Yes (Auto/DAY/NIGHT)					
Auto Gain Control	Yes, (OFF; ON)		Yes, (OFF; Low; Mid; Hi)		Yes, (Auto; Manual)	
Backlight Comp.	Yes, (OFF; ON)		Yes, (OFF; Low; Mid; Hi)		Yes, (OFF; ON)	
Wide Dynamic Range	Yes, (OFF; ON; AUTO)		Yes, (OFF; Auto; ON)		Yes, (OFF; ON)	
Dynamic Noise Reduction	-		Yes, (OFF; Low; Mid; Hi)		-	
White Balance	Auto; Indoor; Outdoor		Indoor/Outdoor/ MAN5100K/MAN3200K/MAN2000K/ONE PUSH		Auto; Indoor; Outdoor	
Motion Detection	Yes, (OFF; ON)				Yes, (4 zone)	
Privacy Zone Masking	-		Yes, (8 zone)		Yes, (8 zone)	
Video Output	1Vp-p/75ohm					
Sync. Mode	Internal					
Focus Control	One Push/Auto/Manual					
Horizontal Rotation Speed	0.01°/s-360°/s (1-255 grade shift gears)					
Manual Pan/Tilt Speed	Pan: 0.01°~180°/s ; Tilt: 0.01°~180°/s					
Position Accuracy	±0.1°					
Horizontal Rotation Range	360° unlimited rotation					
Tilt Rotation Range	90° pendulum motion		180° pendulum motion			
Auto Speed Control	Control speed auto-adjusted according to zoom length changing					
Auto Pan, 2 Points Scanning	Can set freely					
Auto Pan Speed	1-255 grade available, 0.01°/s-360°/s					
Dwell Time (2 points)	1-99 second available					
Preset Positions	192 positions					
Running to Position Speed	1-255 grade available, 0.01°/s-360°/s					
Dwell Time at Preset Position	1-99 second available					
Tour	16 groups					
Tour Point per Group	16 preset positions					
Pattern	4 patterns with 90 sec long each					
Alarm	4 in 2 out with tour/position auto triggering					
Fan	Auto starts					
Built-in Menu for Functions	Yes, OSD					
Communication	RS-485					
Communication Speed	1200/2400/4800/9600bps					
Built-in Protocols	AUTO; EVF; Pelco-P; Pelco-D/Plus-D; A-Type; Panasonic					
Address Editable	Yes (through DIP switch)					
Speed Dome ID Address	0-255					
Power Source	24VAC					
Power Consumption	21W Max					
Operating Temperature	- 40°C ~ +50°C≤95% : -40°F ~ +122°F≤95% : (outdoor EPTZ2700/3100/3600) - 10°C ~ +50°C≤85% : -14°F ~ +122°F≤85% : (indoor EPTZ2700i/3100i/3600i)					
Safety Certificate	CE, FCC					
Environmental Rating	IP66 for outdoor EPTZ2700/3100/3600					
Dimensions	180mm(W) x 280mm(H); 7.1"(W) x 11"(H) (outdoor EPTZ2700/3100/3600) 159mm(W) x 230mm(H); 6.3"(W) x 9.1"(H) (indoor EPTZ2700i/3100i/3600i)					
Weight	Approx. 3.0kg / 6.62lbs					

EPTZ Series

Ready for All Lighting Condition



System Configuration:

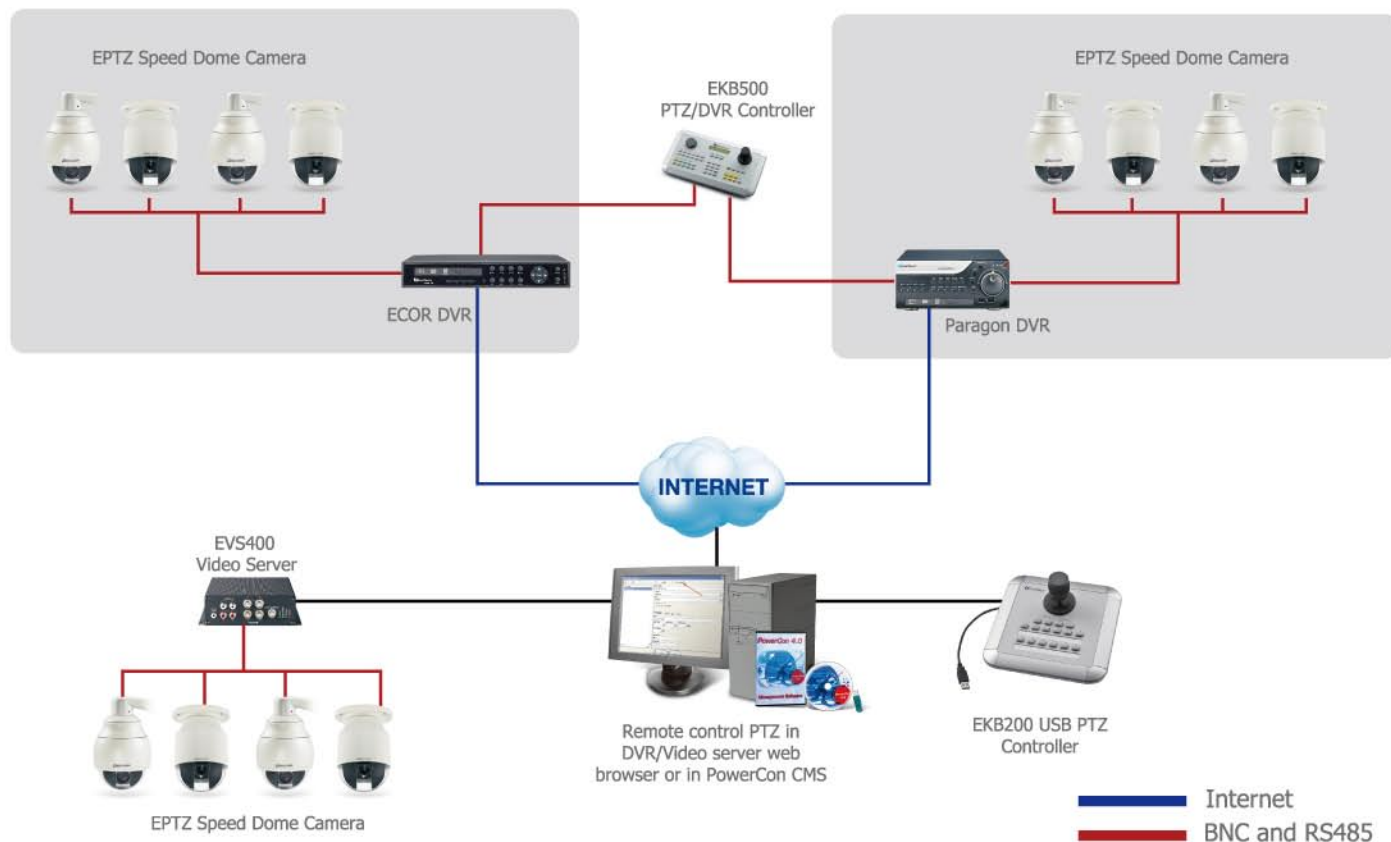

Ordering Information:

EPTZ2700i Indoor 27x Speed Dome

EPTZ2700/C: Indoor, clear cover, 24VAC
EPTZ2700/S: Indoor, smoked cover, 24VAC
EPTZ2700/M: Indoor, mirrored cover, 24VAC

EPTZ2700 Outdoor 27x Speed Dome

EPTZ2700/C: Outdoor, clear cover, 24VAC
EPTZ2700/S: Outdoor, smoked cover, 24VAC
EPTZ2700/M: Outdoor, mirrored cover, 24VAC

EPTZ3100i Indoor 30x Speed Dome

EPTZ2700/C: Outdoor, clear cover, 24VAC
EPTZ2700/S: Outdoor, smoked cover, 24VAC
EPTZ2700/M: Outdoor, mirrored cover, 24VAC

EPTZ3100 Outdoor 30x Speed Dome

EPTZ3100/C: Outdoor, clear cover, 24VAC
EPTZ3100/S: Outdoor, smoked cover, 24VAC
EPTZ3100/M: Outdoor, mirrored cover, 24VAC

EPTZ3600i Indoor 36x Speed Dome

EPTZ3600/C: Indoor, clear cover, 24VAC
EPTZ3600/S: Indoor, smoked cover, 24VAC
EPTZ3600/M: Indoor, mirrored cover, 24VAC

EPTZ3600 Outdoor 36x Speed Dome

EPTZ3600/C: Outdoor, clear cover, 24VAC
EPTZ3600/S: Outdoor, smoked cover, 24VAC
EPTZ3600/M: Outdoor, mirrored cover, 24VAC

Optional Accessories

ETPZ-CMB: Concrete Ceiling Mount Adapter
ETPZ-WMB: Wall Mount Bracket Set
ETPZ-SSM: Outdoor Sunshield
ETPZ-ICMB: In-Ceiling Recessed Mount Bracket
ETPZ-CNMB: Corner Mount Adapter
ETPZ-PLMN: Pole Mount Adapter
ETPZ-CLM: Indoor Pendant Mount Bracket
ETPZ-PBOX: External Power Connection Box

AWB Yes	Indoor	Outdoor
ES 1/50 (1/60) ~ 1/100,000	Day/Night	Vandal proof
Internal Cable (Easy installation)	DNR Yes	Cooling Fan
Auto Flip	IP66 Weatherproof	BLC Yes
OSD Menu	AI Auto Iris	AGC Yes
WDR	Slow Shutter	Protocol auto detection



Ever Focus Electronics Corp.

Head Office:

12F, No.79 Sec. 1 Shin-Tai Wu Road,
Hsi-Chih, Taipei, Taiwan
TEL: +886-2-26982334 FAX: +886-2-26982380
www.everfocus.com.tw

U.S.A - California Office:

1801 Highland Ave. Unit A
Duarte, CA 91010, U.S.A.
TEL: +1-626-844-8888 FAX: +1-626-844-8838
www.everfocus.com

U.S.A - New York Office:

415 Oser Avenue Unit S
Hauppauge, NY 11788
TEL: +1-631-436-5070 FAX: +1-631-436-5027
www.everfocus.com

Europe Office:

Albert-Einstein-Strasse 1
D-46446 Emmerich, Germany
TEL: +49-2822-9394-0 FAX: +49-2822-9394-95
www.everfocus.de

China Office:

Room B-05D-1, KESHI PLAZA, Shangdi Information
Industry Base, Haidian District, Beijing China 100085
TEL: +86-10-62973336/37/38/39 FAX: +86-10-62971423
www.everfocus.com.cn

Japan Office:

1809 WBG MARIBU East 18 F, 2-6 Nakase.Mihama-ku.
Chiba city 261-7118, Japan
TEL: +81-43-212-8188 FAX: +81-43-297-0081
www.everfocus.co.jp

Notice:

© 2005–2008 EverFocus Electronics Corp. The EverFocus trademark is registered by EverFocus Electronics Corp. All rights reserved.
Specifications are subject to change without notice. No parts or contents of this Datasheet may be reproduced or transmitted in any form or by any means without permission from EverFocus.
• Not all models featured are available in all countries. For accessories and other product information, please visit www.everfocus.com
• Safety precaution: carefully read the operating instructions and installation manual before using this product.
• EverFocus can not be responsible for network performance and/or other manufacturer products that reside on the network.
• Weights and dimensions are approximate.
• These products may be subject to export control regulations.
• The above all photographs were taken for the purpose of explanation; actual images may differ.
• This Datasheet is designed and printed in Taiwan.

Distributed by