

## 300-SERIES - VANDAL PROOF OUTDOOR DOME

**CM-301**  
**CM-306**

**CM-301H**  
**CM-306H**



CM-301



CM-306

### DESCRIPTION

OpenEye's 300-Series line of dome cameras provide superior video quality and design. A low lux level for indoor/outdoor low light recording, high TV line resolution, make the 300-Series domes a smart solution for virtually every application.





The CM-306 High Resolution Outdoor Dome Camera produces high resolution video and superior low lux performance, providing you with better quality picture and allowing for easy identification in critical situations. This high resolution camera can record at up to 600 lines of resolution and utilizes Digital Wide Dynamic Range (D-WDR) that allows the camera to balance light in high contrast images. With D-WDR, the camera will brighten darker areas while brighter areas remain the same.

The CM-306 can be equipped with an optional heater, allowing operation in temperatures as low as -58°F (-50°C). Designed for tough environments where standard security cameras are not suited to survive, the 300-Series domes are reinforced with a high-grade polycarbonate housing utilizing triple wall construction which can withstand almost any damage, making it one of the most tightly integrated vandal proof domes on the market.

OpenEye 300-Series cameras are compatible with both 12vDC and 24vAC power making them easy to add to an existing installation and are compatible with the optional quick mount adapter – everything needed for a quick and easy out-of-the-box installation.

### HIGHLIGHTS

- » Varifocal lens
- » Digital-WDR for better high contrast images (CM-306)
- » IP 66 Rated for indoor / outdoor use
- » Day / Night operation
- » Sony® 1/3" Super HAD CCD color sensor
- » Integrated quick mount capable
- » Dual voltage

CM-301	CM-306/H	CM-306/H	CM-306/H
<b>360°</b>	<b>83°</b>	<b>87°</b>	<b>89.8°~23.9°</b>
			
<b>rotate</b>	<b>tilt</b>	<b>tilt</b>	<b>FOV</b>

# 300-SERIES - VANDAL PROOF OUTDOOR DOME

## CAMERA SPECIFICATIONS

	CM-301	CM-301H	CM-306	CM-306H
<b>Image Sensor</b>	1/3" Sony SuperHAD		1/3" Sony SuperHAD II	
<b>Imaging DSP</b>	Sony SS-11X		V6	
<b>IP Rating</b>	IP66		IP66	
<b>Type / Format</b>	NTSC		NTSC / PAL	
<b>Wide Dynamic Range</b>	No		Digital WDR	
<b>Minimum Illumination</b>	1.2 lux @ F1.6 (50 IRE)		0.3 Lux @ F1.2 (AGC Max) @ 50 IRE 0.1 Lux @ F1.2 (AGC Max) @ 30 IRE	
<b>Day / Night</b>	Yes		Digital Day/Night Function	
<b>Horizontal TVL</b>	500 TVL		600TVL	
<b>Service Monitor Jack</b>	No		Yes	
<b>S/N Ratio</b>	48dB		>50dB	
<b>Focal Length</b>	4~9 mm		3.3~12mm	
<b>Iris Control</b>	DC Type Auto IRIS Control		Auto-Iris	
<b>Synchronization</b>	Internal		Internal	
<b>Video Output</b>	1.0Vpp 75Ω BNC Unbalanced		1.0Vpp 75Ω BNC Unbalanced	
<b>White Balance</b>	AWB		AWB, ATW, ATW2, AWC, MWB, Indoor, Outdoor	
<b>Auto White Balance Range</b>	2500 K ~ 9700 K		<b>AWB/ATW:</b> 2700 K ~ 9700 K <b>AWT2:</b> 2500 K ~ 20,000 K	
<b>Backlight Compensation</b>	Center Area for DC IRIS Lens		On, Off, HLC	
<b>Auto Gain Control</b>	Automatic		Low, Mid, High, Off	
<b>Operating Temperature</b>	14°F ~ 122°F (-10°C ~ 50°C)	-58°F ~ 122°F (-50°C ~ 50°C)	14° ~ 122° F (-10° ~ 50°C)	-40° ~ 122° F (-40° ~ 50°C)
<b>Heater</b>	Optional	Yes	Optional	Yes
<b>Power Consumption</b>	3.2W (Max)	14.6W (Max)	2.4W MAX	9W Max
<b>Rated Amperage</b>	<b>12vDC:</b> 0.27A <b>24vAC:</b> 0.13A	0.61A	<b>12vDC:</b> 0.2A <b>24vAC:</b> 0.1A	0.37A
<b>Input Voltage</b>	12vDC / 24vAC (±10%)	24vAC (±10%)	12vDC / 24vAC (±10%)	24vAC (±10%)
<b>Weight</b>	1.2 lbs (0.5 kg)		1.98 lbs (0.9 kg)	
<b>Dimensions</b>	<b>Dome:</b> Ø3.1" (80 mm) x <b>H:</b> 1.7" (45 mm) <b>Housing:</b> Ø5.5" (140 mm) x <b>H:</b> 2.1" (55 mm)		<b>Dome:</b> Ø3.9" (100mm) x <b>H:</b> 1.7" (45mm) <b>Housing:</b> Ø5.3" (135mm) x <b>H:</b> 1.9" (50mm)	
<b>Housing / Dome Cover</b>	White / Clear		Gray / Clear	

# 300-SERIES - VANDAL PROOF OUTDOOR DOME

## RUGGED TRIPLE-WALL POLYCARBONATE CONSTRUCTION

Built from highly durable polycarbonate plastic and engineered with a triple walled outer casing, the 300-Series demonstrates superior resistance to extreme temperatures and can withstand significant blunt force impacts.

The 300-Series is equally suited for outdoor use or indoors in locations such as warehouses, storage freezers, and other areas requiring highly durable cameras. The 300-Series is dust proof and weather resistant with an IP66 rating.

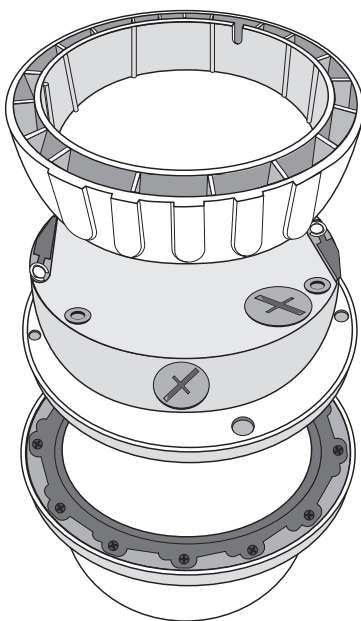

## ACCESSORIES / UPGRADES

<b>CA-300PMK</b>	Pendant Mount Kit
<b>CA-300C</b>	Corner Mount
<b>CA-3004SM</b>	Electrical Mount
<b>CA-300W</b>	Wall Mount
<b>CA-300P</b>	Quick Mount Adapter
<b>CA-306HTR</b>	Heater Module for CM-306
<b>CA-301HTR</b>	Heater Module for CM-301
<b>CA-300VP</b>	Video Power

## 300-SERIES MODELS

<b>CM-301</b>	Standard Outdoor Dome Camera
<b>CM-301H</b>	Standard Outdoor Dome Camera w/ Heater
<b>CM-306</b>	High Resolution Outdoor Dome Camera
<b>CM-306H</b>	High Resolution Outdoor Dome Camera w/ Heater

## SYSTEM IMAGES

### CM-301

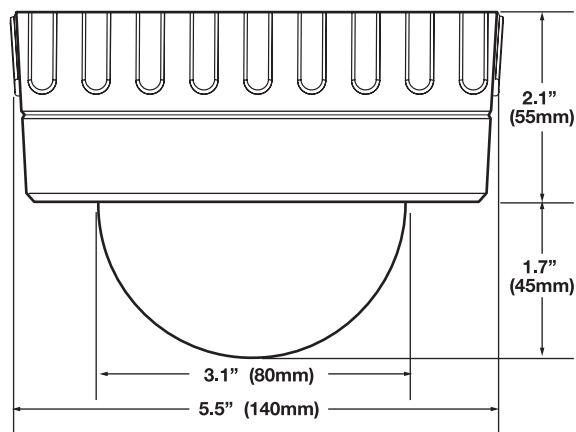

### CM-306

