

## BT-HK24 HEATER KIT (24V or 12V DC)

The BT-HK24 Heater Kit is specifically designed for use with the TAKEX America, Inc. BT Series beam tower enclosures. The heater is designed for 24V and 12V DC operation and produces about 6 Watts (24V mode) and 3 Watts (12V mode), typical current draw = 255mAmp. The BT-HK24 contains a thermostat, which operates at 46°F (8°C) and is connected in series with the heater element.

The heater element should be mounted directly on to the beam tower extrusion and should be located under the Photoelectric beam, at a maximum of 4 inches (100mm) from the bottom of the beam.

Kit contains:

24V DC heater	Qty. 1
Thermostat	Qty. 1
Connector	Qty. 1

Single Sided Beam Tower

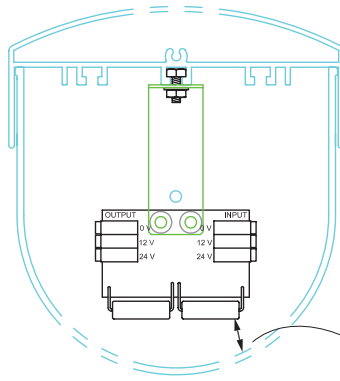

Double Sided Beam Tower

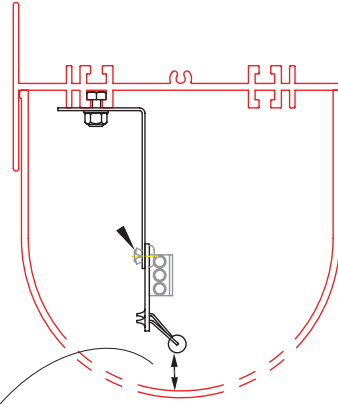

3/8" space required between heater and housing

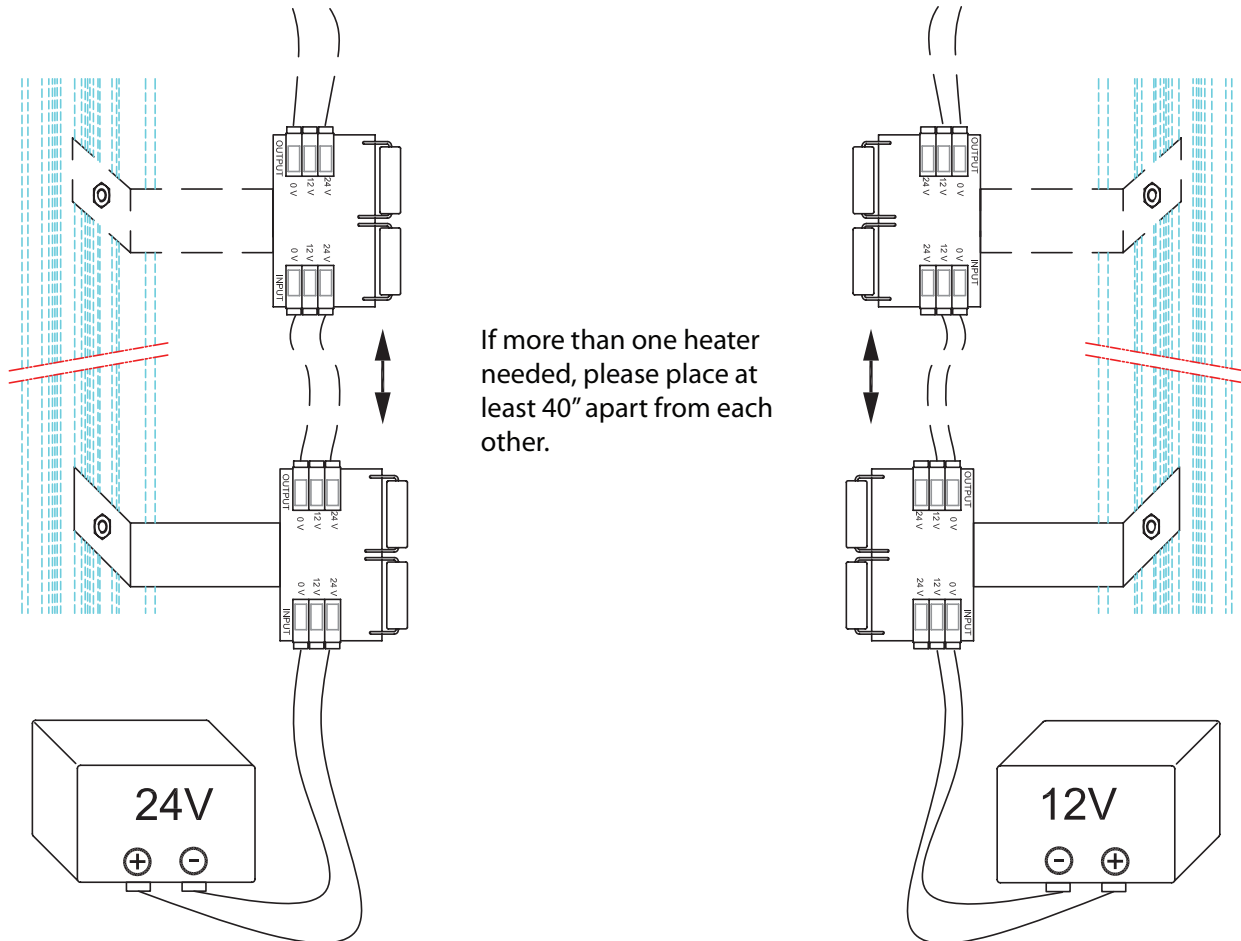

# HEATERS & THERMOSTAT

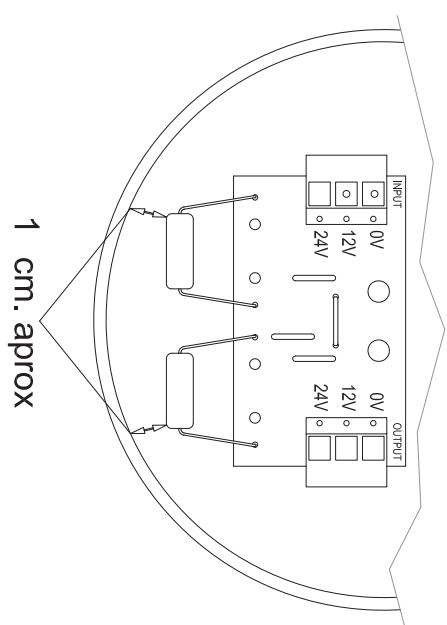
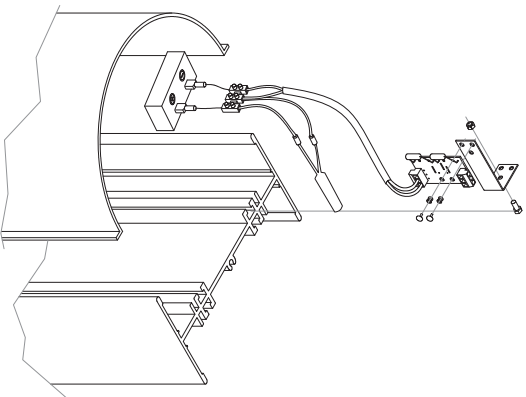
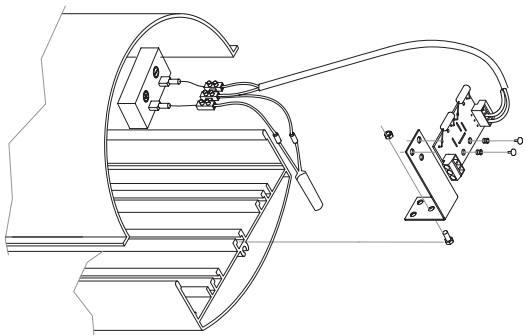
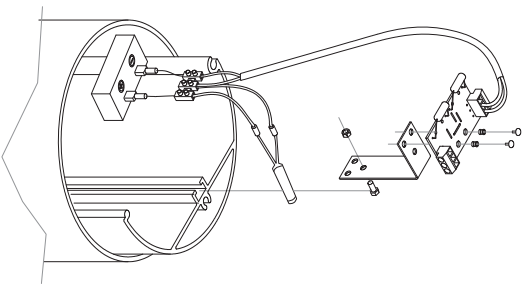

Ideal Positioning

1 cm. aprox

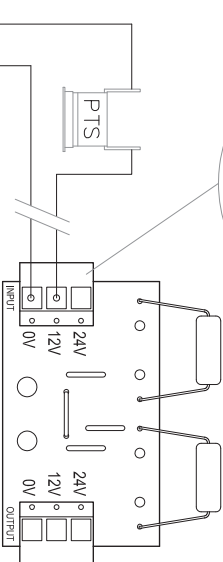
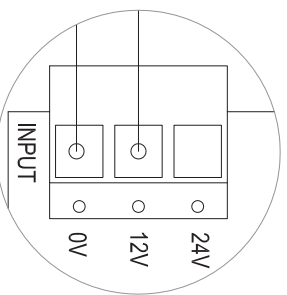

Simple Setting for 12V / 250 mA

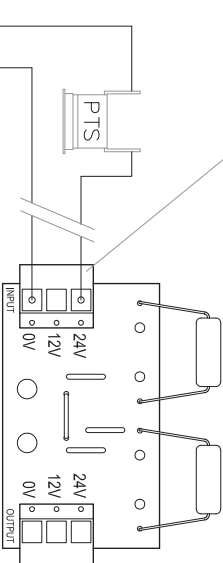
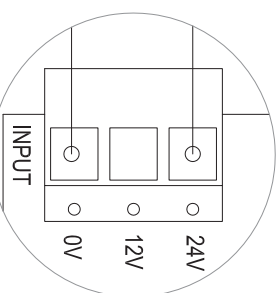

Simple Setting for 24V / 250 mA

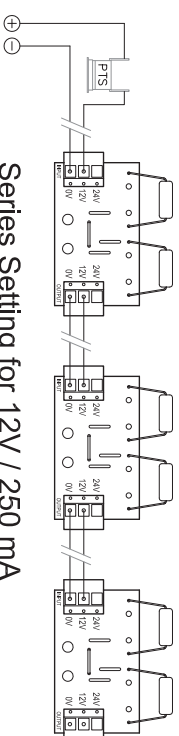

Series Setting for 12V / 250 mA

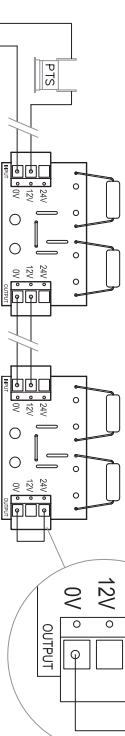

Series Setting for 12V / 500 mA  
(double power)

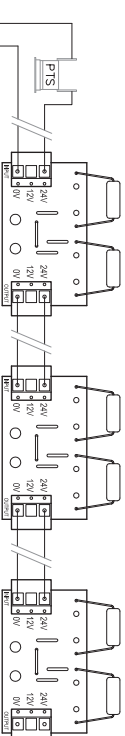

Series Setting for 24V / 250 mA