

Coaxial Cable Supplies

Cable Connectors, Terminators, Adapters, Crimp Rings, Crimping Tools

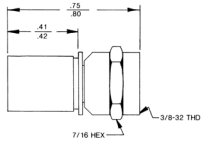

BTF-56 HEX

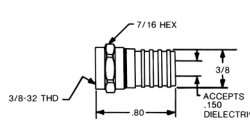

BTF-59 HEX

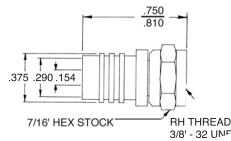

BTF-591 HEX

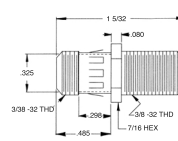

GF-81C

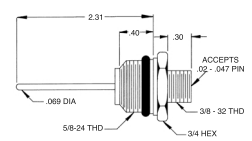

KS-F

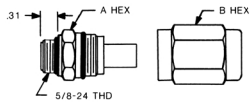

BR-500-VSF

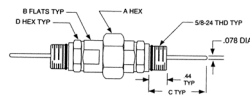

B-KS-KS-M

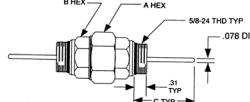

BS-KS-KS-M

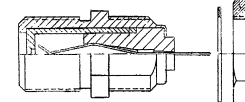

ZF-61-NW

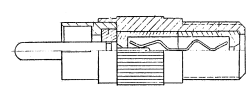

ZF-FR

Blonder Tongue offers a selected line of connectors for common drop and feeder cables as RG-59/U, RG-6/U, RG-11/U and 0.500 inch aluminum cable. Blonder Tongue also has a variety of adapters for converting from male to female, RCA to F, or F to 5/8-24 entry fittings.

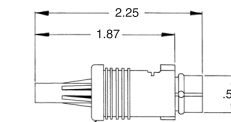

DP-5

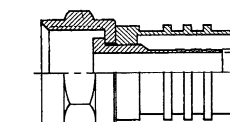

ZF-59-290G

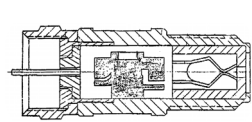

ZVBC

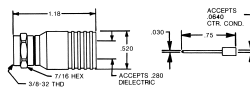

BTF-110-Hex

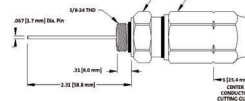

BR-500-CH-A

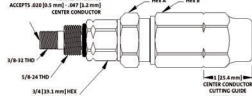

BR-500-BAFF-A



DMT-TP



BTF-TP



CR-611

The CR-611 Q2 is a crimping tool for integral sleeve "F" connectors. This tool has openings for RG-59 (both single and dual/quad braid), RG-6, and RG-11 and is compatible with all Blonder Tongue HEX crimp connectors. In addition, the CR-611 Q2 will crimp the RG-11 center conductor. Crimp Size: .100, .324 and .475

Ordering Information

Model	Stock No.	Description			
BTF-591 HEX	3593	Connector Hex, Type "F", Male, RG-59/U	BR-500-CH-A	3582A	Adapter Pin to 5/8" Entry, 0.500" Aluminum Cable
BTF-59 HEX	3586	Connector Hex, Type "F", Male, RG-59	BR-500-BAFF-A	3581A	Adapter Type "F" Female, 0.500" Aluminum Cable
BTF-56 HEX	3587	Connector Hex, Type "F", Male, RG-6	BR-500-VSF-A	3584A	Adapter Feed-Thru, 5/8" Entry, 0.500" Aluminum Cable
BTF-110 HEX	4658	Connector Hex, Type "F", Male, RG-11	ZF-61NW	1962	Connector Type "F", Female, Chassis Mount w/ Nut & Flat Washer
B-KS-KS-M	3590	Adapter Housing to Housing, Double Male, 5/8-24	DP-5	3185	Connector DIN Plug, 5 Pin, Male
ZF-FR	1966	Adapter Type RCA Male to "F", Female	DMT-TP	4798	Terminator Power Blocked, DMT Style, 75 Ohm
GF-81C	3689	Adapter Type "F" Female to Type "G" Female	BTF-TP	4670	Terminator Male, Type "F", 75 Ohm
KS-F	3576	Adapter 5/8" Entry Female to Type "F" Female	CR-611 Q2	5085	Hex Crimp Tool, RG-11, RG-6, RG-59
ZVBC	1963	Voltage Blocking Coupler, "F" Female to Male, DC Blocking			
BS-KS-KS-M	3589	Adapter Housing to Housing, Double Male, 5/8-24, Short Size			