

5700 Series - LEO®

OVERVIEW

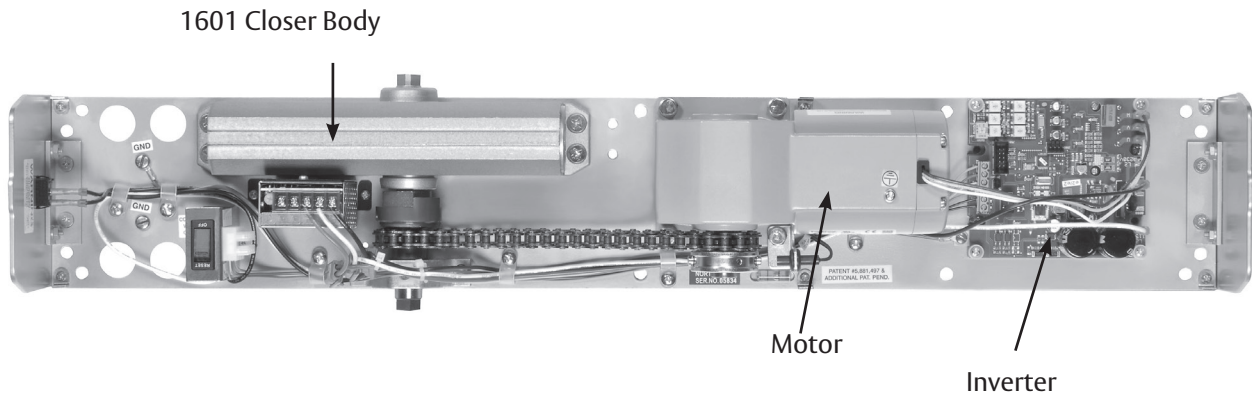

FEATURES AND FUNCTIONS

- Ease of installation and setup
- Simple instructions
- Application versatility and ease of adjustment
 - ☐ Push or pull side mounting units available
- Operates as mechanical surface closer during close cycles, when door is opened manually or if power is turned off
 - ☐ Quiet operation
 - ☐ Spring force provides the feel of a normal manual door closer
 - ☐ Door can be opened manually if desired
- Norton® 1601/1601BF series *door closer*
 - ☐ Adjustable Spring Power
- ☐ Backcheck Valve
- ☐ Sweep Valve & Latch Valve
- Non-Handed
- Unit Activation Options
 - ☐ Wall switches
 - ☐ Motion sensor
 - ☐ Radio frequency device
- End-User On/Off Switch
- Hold Open options
 - ☐ 0-30 seconds (5 seconds minimum required for ADA and ANSI/BHMA A156.19)
- Obstruction Detection
 - ☐ Motor stops if door is obstructed during an opening
 - ☐ Door closes under manual spring force (not to exceed 15lbf)
- "Push and Close"
 - ☐ Allows the operator to skip the hold open time when it is not necessary or required
 - ☐ Adjustable door sensitivity
- Overload Safety Shut-Off
 - ☐ After two minutes of receiving a door activation signal, the inverter will time out and close the door
 - ☐ Prevents motor/inverter damage
- Motor Start Delay for Locking Hardware
 - ☐ 0-5 second delay to allow locking hardware to release first
- Onboard power supply for accessories: 24VDC (1.1A)

ELECTRICAL DATA

- Power Input; 120 VAC, 60Hz or 220VAC, 60Hz
- Current Draw: .6A or .3A
- Relay Output: SPDT
 - ☐ Normally Open/Normally Closed (jumper)
 - ☐ For electric strike function

CERTIFICATIONS

- C-UL US listed for use on fire and smoke barrier doors
- 2-year warranty (refer to current Norton® price book for terms & conditions)
- Meets requirements for Americans with Disabilities Act (ADA)
- ANSI/BHMA A156.19 certified
- Meets ANSI/BHMA A156.4 requirements



STANDARD APPLICATIONS



5710
HINGE (PULL) SIDE OF DOOR

- Adjustable Stop
- 180° swing (trim permitting)

Minimum Door width
Single Door - 29" (74cm)
Double Door - 30" (76cm)

An auxiliary stop is suggested where severe conditions exist.

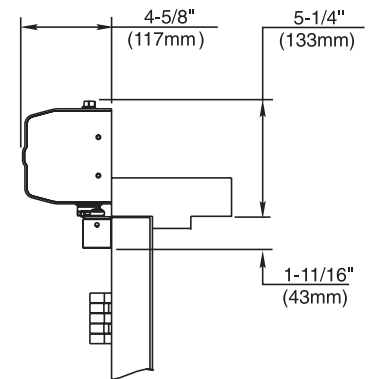
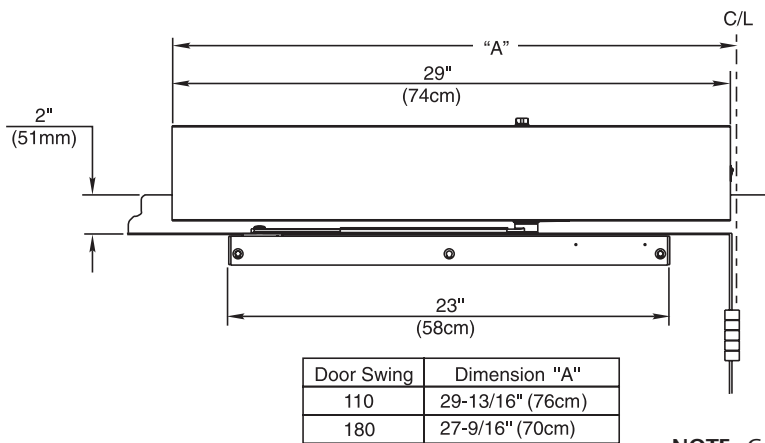

NOTE: Contact factory for use on doors exceeding 250 lbs.



5730
STOP (PUSH) SIDE OF DOOR

STANDARD DUTY DOUBLE LEVER ARM

- Frame reveals 2-5/8" to 6-3/4" (67-171mm)
- An auxiliary door stop is required for these applications.
- 170° swing (trim permitting)

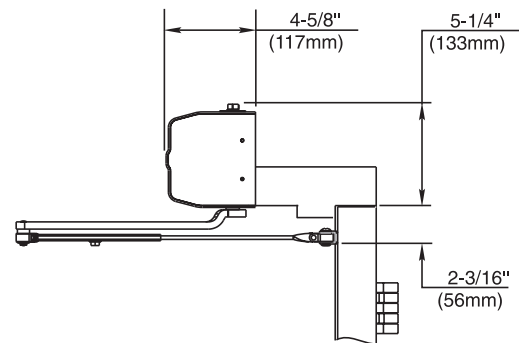
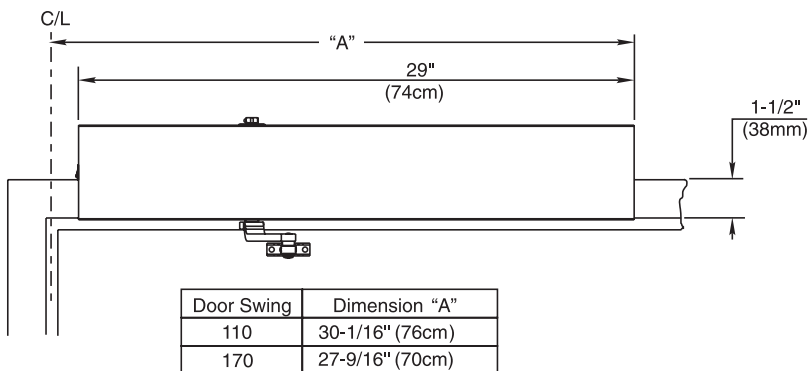

NOTE: Contact factory for use on doors exceeding 250 lbs.