

# 55RNCS



## SECURITY VIDEO WALL SOLUTIONS

The ORION 55RNCS D-LED Ultra Narrow Bezel Series features an only 5.5mm edge to edge Ultra Narrow Bezel with Direct LED technology making these the perfect solution for a tightly mounted side by side security surveillance video wall. The 55RNCS series is designed with no buttons or lights on the bezel, RS-232C for computer control, 2 Video BNC In / Out, and many other inputs. Ideal solution requiring multiple monitors to be installed on one wall or upgrading your CRT's to LED's. ORION Images is leading the market as being an expert in control room solutions for broadcasting, telecommunications, public utilities, process control, traffic control, surveillance and command & control applications.



### ULTRA NARROW BEZEL

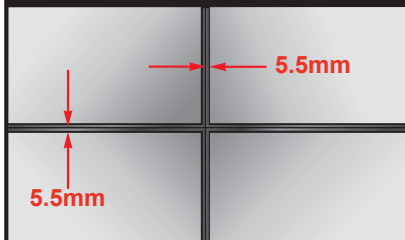

55RNCS video wall's bezel width is 5.5mm two sides of the monitor.

### DIRECT LED TECHNOLOGY D-LED

55RNCS utilizes Direct LED backlighting technology and may offer a range of benefits over CCFL LCD TVs such as reduced energy consumption, better contrast and brightness, greater color range, more rapid response to changes in scene and a capacity to provide the means to render an image more accurately.

- » Lower heat output than traditional lamp-based systems
- » Long panel life as LED backlights reduce burn-in
- » Stable colors across the entire video wall
- » High brightness, excellent contrast & a wide viewing angle
- » Less environmental pollution on disposal
- » Generally 20-30% lower power consumption

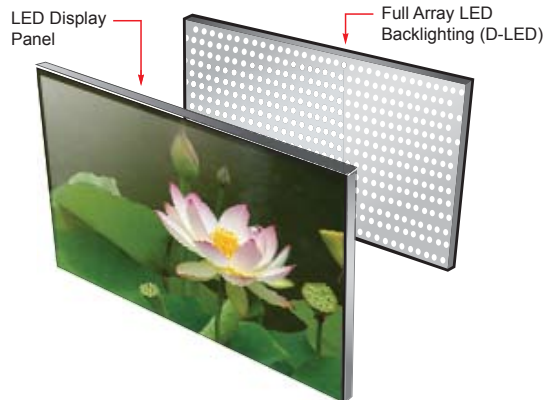

### CONTRAST COMPARISON



Gradient



Gradient



Gradient

## SPECIFICATIONS

55RNCS	
<b>Bezel Width</b>	
Bezel Open Area	5.5 mm (Two sides)
Active Pixel Area	5.7 mm (Two sides)
<b>Display</b>	
Screen Size	55 Inch
Max. Resolution	1920 x 1080 @ 60Hz
Active Display Area	1209.6 x 680.4 mm
Pixel Pitch	0.630 x 0.630 mm
Brightness	700cd/m <sup>2</sup>
Contrast Ratio	3500 : 1
Aspect Ratio	16 : 9
Viewing Angle	178° / 178°
Display Color	16.7 Million (8bit)
Response Time	< 8ms (Gray to Gray)
Video System	NTSC / PAL
<b>Interface</b>	
RS232 In / Out	1 / 1
DVI-D In / HDMI In	1 / 2
VGA In (15Pin D-Sub)	1
BNC Video In / Out	2 / 2
S-Video In / Out	1 / 1
Component In	1
Audio In (RCA Type)	3 (L+R)
PC Stereo In	1
<b>Audio</b>	
Built In Speaker	4W x 2
<b>Transmitter</b>	
IR Remote Control	Yes
<b>Features</b>	
Picture In Picture (PIP)	Yes
Picture By Picture (PBP)	Yes
Enhanced Picture	3D Comb Filter / Deinterlace / Noise Reduction
Auto Fan Control System	Yes
Auto Pixel Shift	Yes
Trigger Source Switching	Yes
Auto Source Switching	Yes
Edge Setting (Horizontal / Vertical)	N/A
Multi Language	English, Spanish, French, German, Italian
RS-232C Control	Monitor OSD control using PC
<b>Outline Dimension</b>	
Dimension (W x H x D)	47.835" x 27.007" x 6.417"
Net. Weight	TBD
<b>Warranty</b>	
Part / Labor	2year / 2year
MTBF (Approx.)	50,000 Hours
<b>Regulations</b>	
Electronic	RoHS, TUV-NRTL (=UL), CB, FCC (A), CE-Emc (LVD)
<b>Circumstance</b>	
Operating Temperature	0 ~ 50°C / 32 ~ 122°F
<b>Power</b>	
Electrical Ratings	AC 100 ~ 240V (50/60Hz)
Power Consumption	330W
<b>Mount</b>	
VESA™ Mount Size	600 x 400mm
Video Wall	WFS, WES, WSD
Stand Alone	WB-4663

\*Design and specifications are subject to change without notice

## SOFTWARE

### Control Management S/W features:

- » Extremely easy to use
- » Control each display Separately or All at once
- » Select input source
- » Menu lock out (IR or panel)
- » Power control – On / Off
- » Color setting (RGB) & Brightness
- » Sound On / Off & volume adjustment

## HARDWARE

- » 1080p Full HD High Resolution Native 1920 x 1080p
- » Stylish Slim & Ultra Slim Bezel Design
- » Remote Display Management
- » Landscape and Portrait
- » HDMI In 2, DVI-D In 1, VGA In 1, BNC Video In / Out
- » RS-232C In / Out for pc / server control
- » Control panel Lock (panel or IR)
- » All metal chassis
- » Auto power recovery
- » Auto pixel shift
- » PIP / PBP – Dual signal In
- » VESA standard hole patterns

## DIMENSION

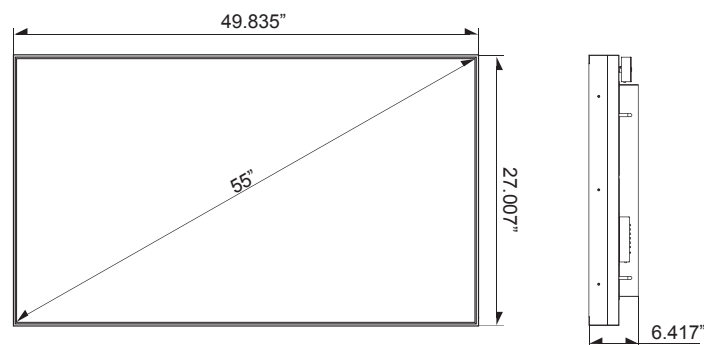

## INTERFACE



## MOUNTS

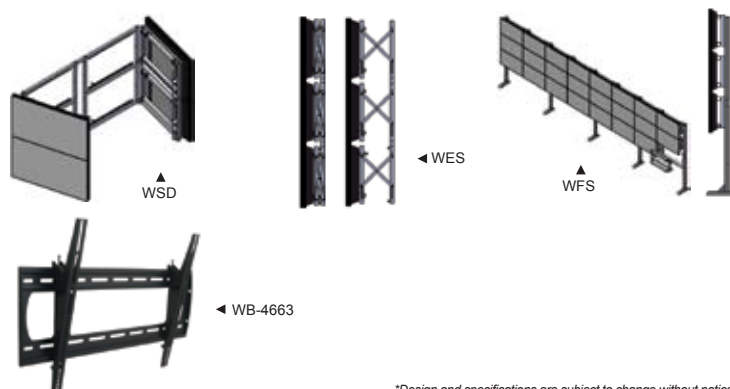

\*Design and specifications are subject to change without notice