

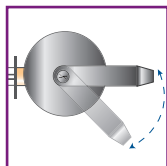

3 Series Grade 1 Electrified Commercial Cylindrical Lock Sets

In or Out... we make it Easy!®



"Clutch" disengages outside lever allowing it to turn freely without opening the latch

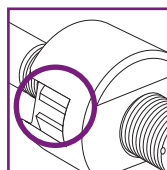

Cast stainless steel retractor with bronze roller bearings for ultra-strength, smooth operation, and long life

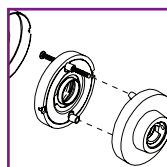

Thru-bolting ensures vibration-proof mounting and prevents lock chassis rotations

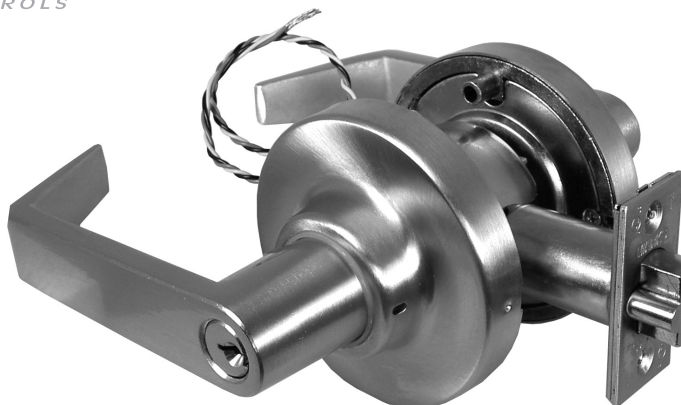

Shown with American Lever

3800 Series Grade 1 Electrified Commercial Cylindrical Lock Sets

Latch:

Backset: 2-3/4" standard
Throw: 9/16"



Ask about our selection of
Current Transfers and other
complimentary products

Features

- When locked, the "clutch" disengages outside lever. This reduces the torque applied to the outside lever, preventing vandalism
- Cast stainless steel retractor with bronze roller bearings.
- Thru-bolting with #10 epoxy coated bolts
- Lever set withstands torque of 1800 inch-pounds. Over twice ANSI/BHMA test value
- Tested to over four million cycles
- Ultra high strength springs eliminate lever droop.
- Fits doors ranging in thickness from 1-5/8" to 1-7/8". No spacers or special tools required
- Conventional 6-pin Cylinder standard. Interchangeable (IC) Cores optional*
- 100% continuous duty cycle (bridge rectifier supplied)
- Voltage: 12 or 24VDC
- Fail Locked or Fail Unlocked
- Non-handed
- Satin Chrome Finish (26D)

3800 Series BHMA Grade 1 Electrified Commercial Cylindrical Lock Sets

Designed for use in applications where durability is the deciding factor. The lever set has a unique "clutch" mechanism that radically reduces the wear and abuse experienced with typical cylindrical lever sets.

When locked, the lever disengages from the retractor and other interior mechanisms of the lock. The lever swings freely without resistance. This reduces the amount of wear on lock components and eliminates "lever droop".

The performance and quality of RCI's 3800 Series Grade 1 Electrified Cylindrical Lock Set makes it the ideal solution for high traffic commercial applications. All backed by RCI's Lifetime Mechanical Warranty.

Accessories

- Spacer Kit (for 1-3/8" doors)
- Electrified Hinges
- Flex Loops
- Pin and Ball Wire Transfers

Highlights

- Unique "clutch" is unlike other lock sets wherein rigid levers are prone to failure because of excessive torque
- Grade 1 ANSI-A156.2 ; 3 Hour Fire Rating
- Tested to over four million cycles
- Lifetime Mechanical Warranty
- Made in the USA

Applications

Interior or Exterior Doors for:

- Office Complexes
- Industrial Buildings
- Educational Facilities
- Commercial Centres
- Health Care
- Retail/Storefront
- Hotels
- Multi-family dwellings
- Government
- Public Buildings

Options

- Interchangeable Cores (IC)*
- Crescent, Monaco, and Titan lever types*
- Polished Chrome (26), Polished Brass (3) Brushed Brass (4), Brushed Light Chrome (10), and Brushed Dark Chrome (10B) finishes available*
- 2-3/8", 3-3/4", and 5" backsets

* Available by special order, minimum orders apply



In or Out... we make it Easy!®

Model	Description	Voltage	Amps	Ohms (Ω)	Function/Mode
3811-00	Lever Set only with REX	Non-Electrified			Storeroom†
3801-05D	Lever Set only - Electrified	12VDC	0.42	28	Fail Locked
3801-08D	Lever Set only - Electrified	24VDC	0.21	111	Fail Locked
3801-06	Lever Set only - Electrified	12VDC	0.25	47	Fail Unlocked
3801-09	Lever Set only - Electrified	24VDC	0.12	187	Fail Unlocked
3811-05D	Lever Set with REX	12VDC			Fail Locked
3811-08D	Lever Set with REX	24VDC			Fail Locked
3811-06	Lever Set with REX	12VDC			Fail Unlocked
3811-09	Lever Set with REX	24VDC			Fail Unlocked

† Storeroom Function: Outside lever always locked, opened with key. Inside lever always unlocked

Specifications	
Backset	Standard: 2-3/4" Optional: 2-3/8", 3-3/4", and 5"
Latch	1-1/8" x 2-1/4"; Throw: 9/16"; Stainless steel nose
Lever	American Lever (standard), see optional lever types below
Rose	Thru-bolted, 3-7/16" dia., spring loaded 2-#10 thru-bolts.
Strike:	4-7/8" ASA curved lip strike
Door thickness	1-5/8" to 1-7/8". For 1-3/8" door, use spacer.
Cylinder	Conventional "C" keyway, 6 pin w/ 2 keys (standard), keyed different
Request to Exit Switch (REX)	SPDT, 3 amp, 125 AC, wired either normally open or normally closed

NOTE: Not to scale. Specifications are subject to change without notice.

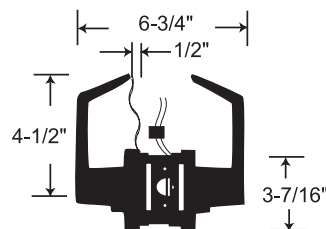
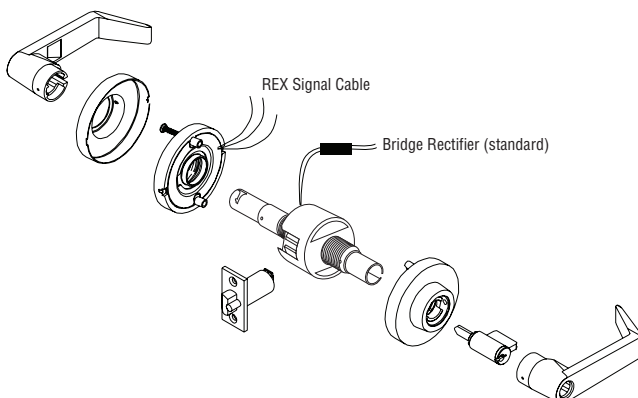

Lever Types	
American Lever standard	Crescent Lever*
Monaco Lever*	Titan Lever*

* Crescent, Monaco, and Titan lever types available by special order, minimum orders apply

RCI also offers a complete line of Electromagnetic Locks, Electric Strikes, Power Supplies, Switches, Key pads & Readers, Exit Devices, Systems & Door Hardware.