

Make a Sizeable Difference in How You Communicate with a Sharp Touchscreen LCD Monitor

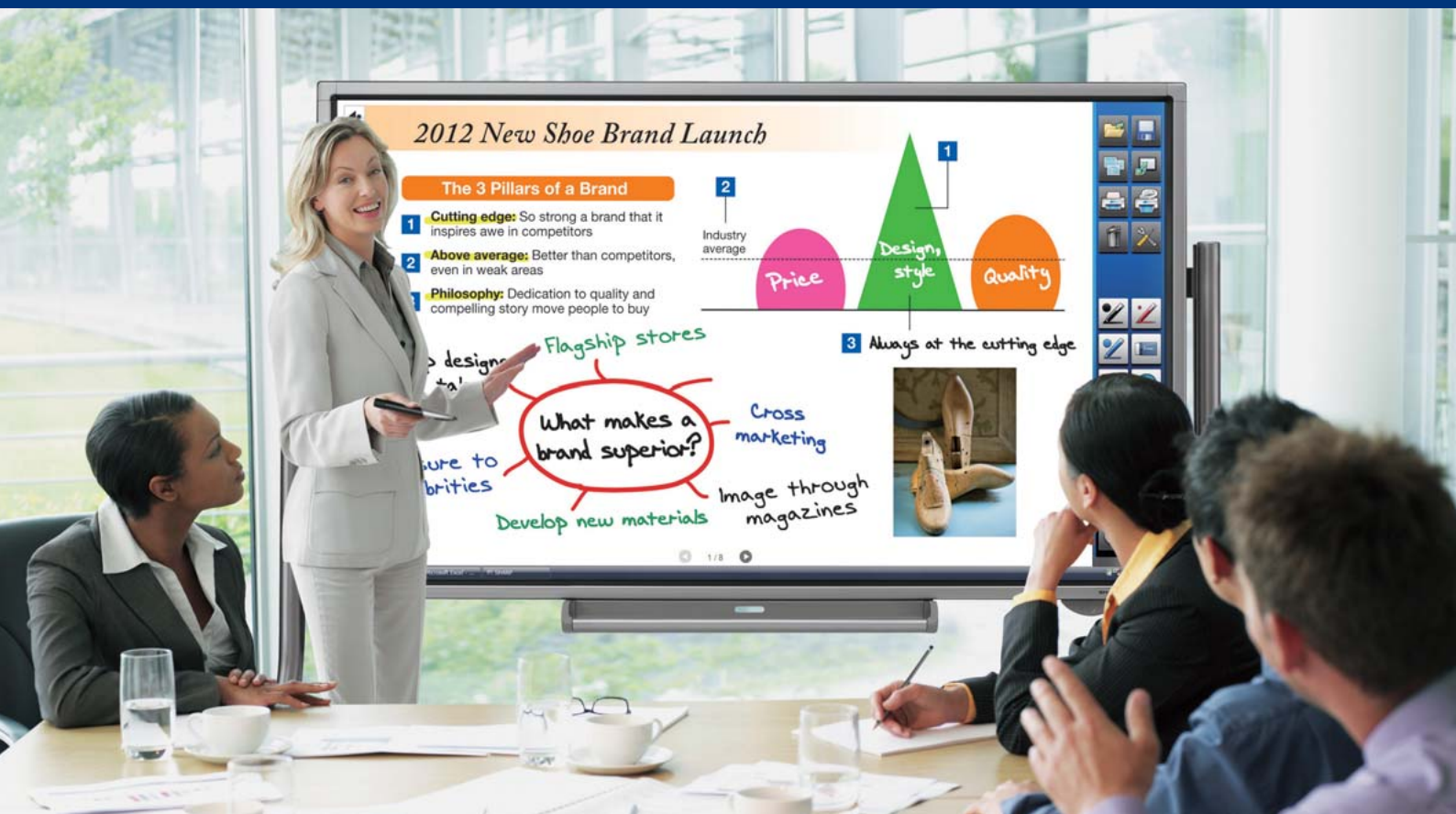

Simple and Intuitive User Interface

Developed specifically for Sharp touchscreen LCD monitors, Sharp Pen Software allows anyone to smoothly and easily operate the 70-inch PN-L702B / 60-inch L602B. Once documents or images created on any application software have been captured as JPEG images and displayed on the touchscreen, users can quickly write and draw directly on the screen surface using the touch pen or a finger. Screen images can be enlarged or rotated, and handwritten notations such as text and drawings can be selected and moved around. What's more, everything on the screen can be saved or exported for printout, making it easy to keep accurate records of brainstorming sessions and meetings.

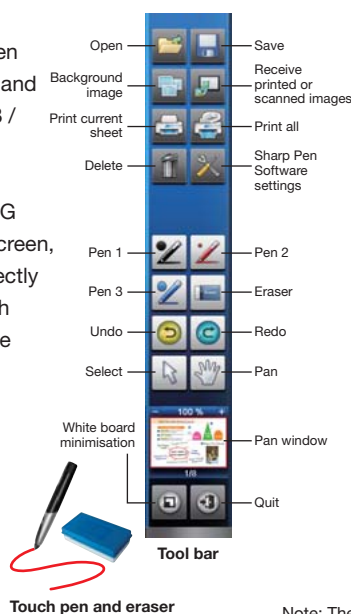

MFP* Connectivity for Fast and Easy Operation

Connecting the PN-L702B/L602B to a Sharp MFP with colour-scanning function makes for faster, smoother communication. Documents and images scanned from the MFP can be imported directly to the pen software for display on the PN-L702B/L602B. For added convenience, image data shown on the PN-L702B/L602B—including notations—can be saved to a PC or sent directly to an MFP for printout.

* Multifunction printer

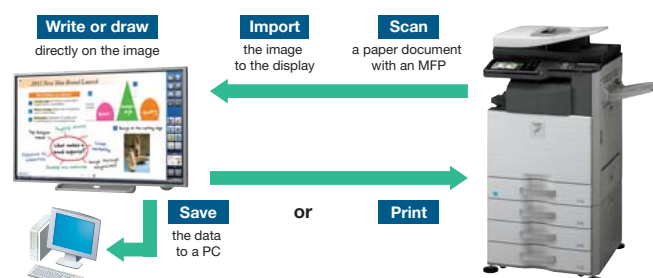

Note: The stand in the above photo is a conceptual image; actual product appearance may differ.

